

② Top
3/4" = 1'-0"

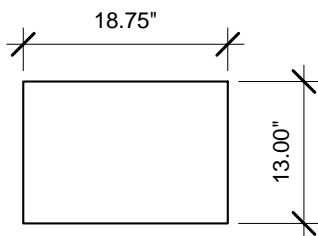

① Front
3/4" = 1'-0"

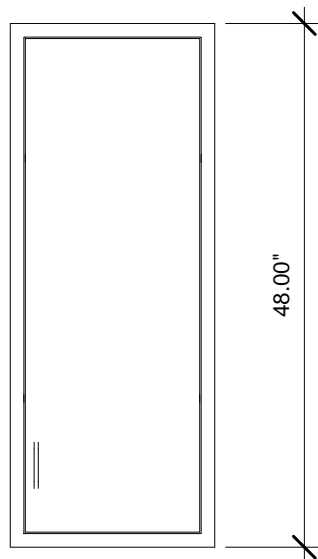

③ Right
3/4" = 1'-0"

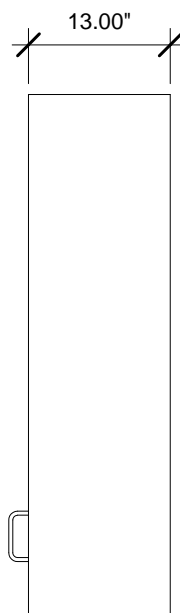

④ 3D View 1

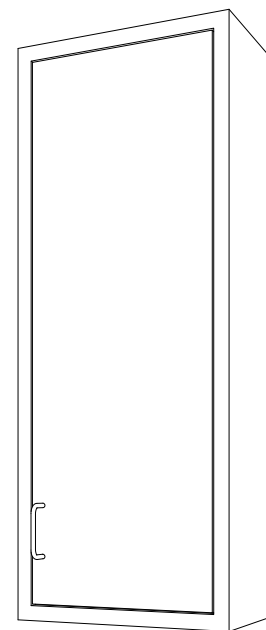

Wall Cabinets are designed for flush face construction with a recessed back panel for uneven wall surfaces. Solid doors are double walled for added strength and sound deadened for optimal performance.

PO#: _____	DATE: _____
APPROVAL: _____	
TITLE: _____	

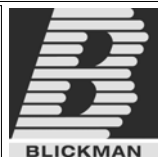

PROPRIETARY AND CONFIDENTIAL
THE INFORMATION CONTAINED IN THIS
DRAWING IS THE SOLE PROPERTY OF
BLICKMAN HEALTH INDUSTRIES. ANY
REPRODUCTION IN PART OR AS A WHOLE
WITHOUT THE WRITTEN PERMISSION OF
BLICKMAN HEALTH INDUSTRIES IS PROHIBITED.

UNLESS OTHERWISE SPECIFIED:
DIMENSIONS ARE IN INCHES
BEND RADIUS = MTL. THK.

TOLERANCES:
FRACTION: ± 1/32"
DECIMAL: ± .031"

	NAME	DATE
DRAWN	JG	2-2-12
ENG APPR.		
MATERIAL		
300 SERIES S/S		
FINISH		
APPRX WEIGHT = lbs		
DO NOT SCALE DRAWING		

BLICKMAN, INC CLIFTON, NJ		
TITLE: A18HS WALL CABINET		
SIZE A	DWG. NO. 2020218480	REV
SCALE: 1:16		SHEET 1 OF 1

5

4

3

2

1

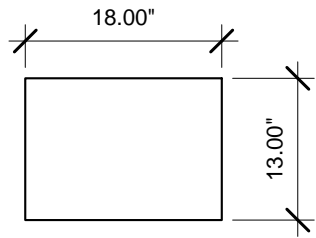

② Top
3/4" = 1'-0"

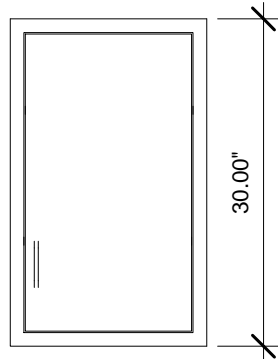

① Front
3/4" = 1'-0"

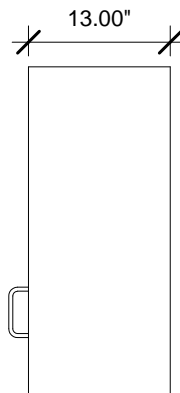

③ Right
3/4" = 1'-0"

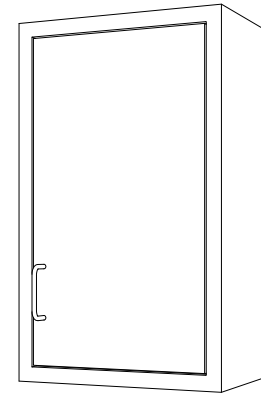

④ 3D View 1

Wall Cabinets are designed for flush face construction with a recessed back panel for uneven wall surfaces. Solid doors are double walled for added strength and sound deadened for optimal performance.

PO#: _____ DATE: _____

APPROVAL: _____

TITLE: _____



PROPRIETARY AND CONFIDENTIAL
THE INFORMATION CONTAINED IN THIS
DRAWING IS THE SOLE PROPERTY OF
BLICKMAN HEALTH INDUSTRIES. ANY
REPRODUCTION IN PART OR AS A WHOLE
WITHOUT THE WRITTEN PERMISSION OF
BLICKMAN HEALTH INDUSTRIES IS PROHIBITED.

UNLESS OTHERWISE SPECIFIED:
DIMENSIONS ARE IN INCHES
BEND RADIUS = MTL THK.

TOLERANCES:
FRACTION: ± 1/32"
DECIMAL: ± .031"

	NAME	DATE
DRAWN	JG	2-2-12
ENG APPR.		
MATERIAL		
300 SERIES S/S		
FINISH		
APPRX WEIGHT = lbs		
DO NOT SCALE DRAWING		

BLICKMAN, INC CLIFTON, NJ		
TITLE: A18LS WALL CABINET		
SIZE A	DWG. NO. 2020218000	REV
SCALE: 1:16	SHEET 1 OF 1	

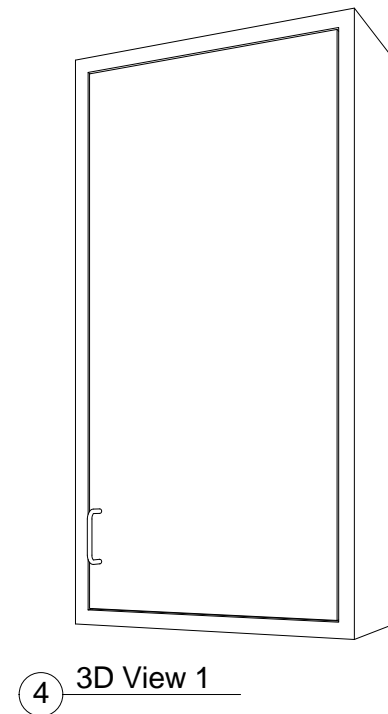
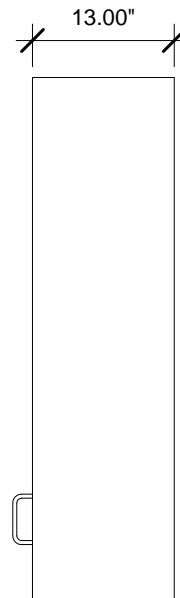
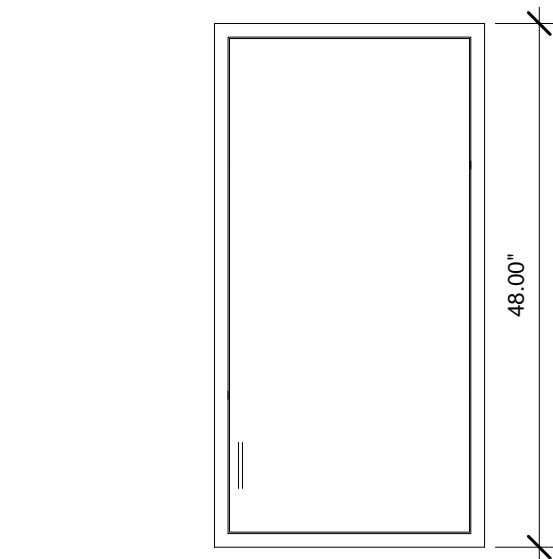
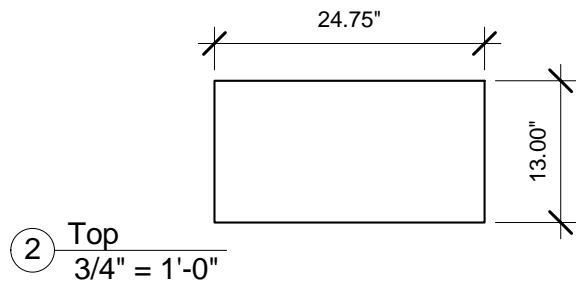

Wall Cabinets are designed for flush face construction with a recessed back panel for uneven wall surfaces. Solid doors are double walled for added strength and sound deadened for optimal performance.

PO#: _____ DATE: _____

APPROVAL: _____

TITLE: _____

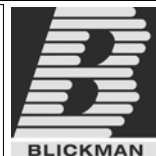

PROPRIETARY AND CONFIDENTIAL
THE INFORMATION CONTAINED IN THIS
DRAWING IS THE SOLE PROPERTY OF
BLICKMAN HEALTH INDUSTRIES. ANY
REPRODUCTION IN PART OR AS A WHOLE
WITHOUT THE WRITTEN PERMISSION OF
BLICKMAN HEALTH INDUSTRIES IS PROHIBITED.

UNLESS OTHERWISE SPECIFIED:
DIMENSIONS ARE IN INCHES
BEND RADIUS = MTL. THK.

TOLERANCES:
FRACTION: ± 1/32"
DECIMAL: ± .031"

	NAME	DATE
DRAWN	JG	2-2-12
ENG APPR.		
MATERIAL		
300 SERIES S/S		
FINISH		
APPRX WEIGHT = lbs		
DO NOT SCALE DRAWING		

BLICKMAN, INC CLIFTON, NJ		
TITLE: A24HS WALL CABINET		
SIZE A	DWG. NO. 2020224480	REV
SCALE: 1:16	SHEET 1 OF 1	

5

4

3

2

1

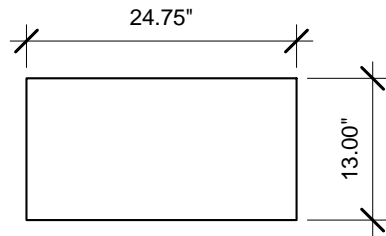

② Top
3/4" = 1'-0"

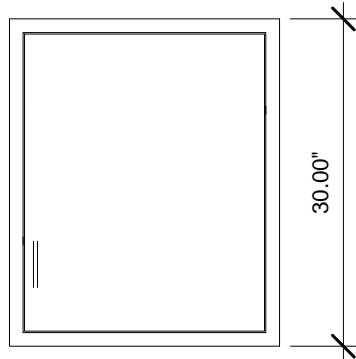

① Front
3/4" = 1'-0"

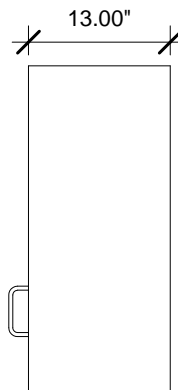

③ Right
3/4" = 1'-0"

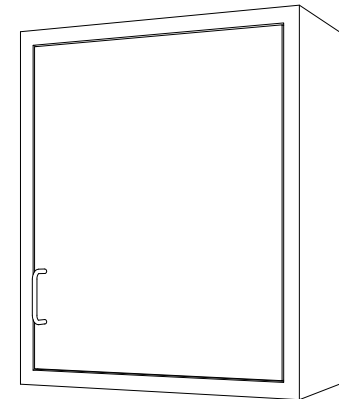

④ 3D View 1

Wall Cabinets are designed for flush face construction with a recessed back panel for uneven wall surfaces. Solid doors are double walled for added strength and sound deadened for optimal performance.

PO#: _____ DATE: _____

APPROVAL: _____

TITLE: _____

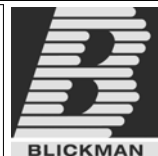

PROPRIETARY AND CONFIDENTIAL
THE INFORMATION CONTAINED IN THIS
DRAWING IS THE SOLE PROPERTY OF
BLICKMAN HEALTH INDUSTRIES. ANY
REPRODUCTION IN PART OR AS A WHOLE
WITHOUT THE WRITTEN PERMISSION OF
BLICKMAN HEALTH INDUSTRIES IS PROHIBITED.

UNLESS OTHERWISE SPECIFIED:
DIMENSIONS ARE IN INCHES
BEND RADIUS = MTL. THK.

TOLERANCES:
FRACTION: ± 1/32"
DECIMAL: ± .031"

	NAME	DATE
DRAWN	JG	2-2-12
ENG APPR.		
MATERIAL		
300 SERIES S/S		
FINISH		
APPRX WEIGHT = lbs		
DO NOT SCALE DRAWING		

BLICKMAN, INC CLIFTON, NJ		
TITLE: A24LS WALL CABINET		
SIZE A	DWG. NO. 2020224000	REV
SCALE: 1:16		SHEET 1 OF 1

5

4

3

2

1

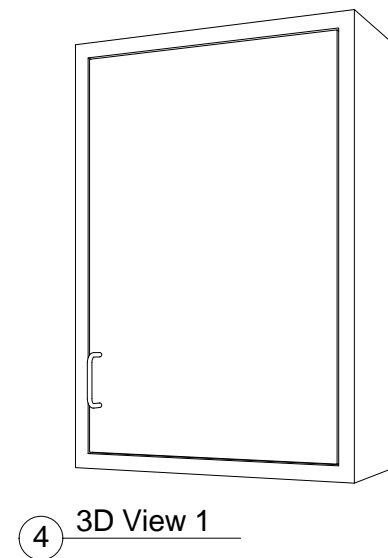
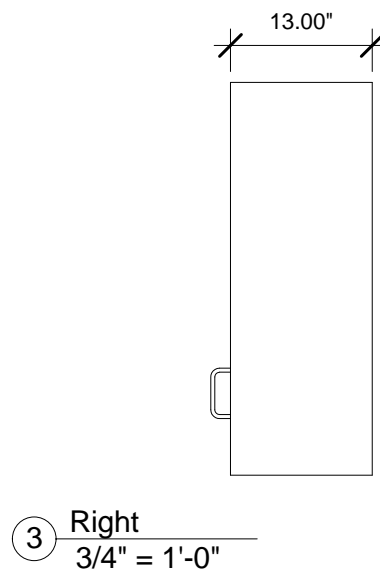
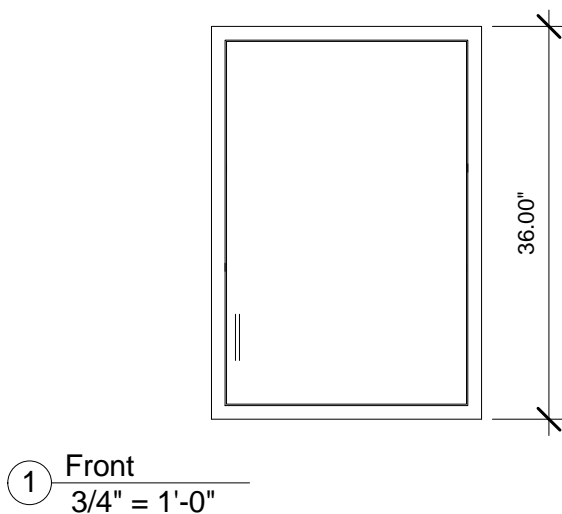
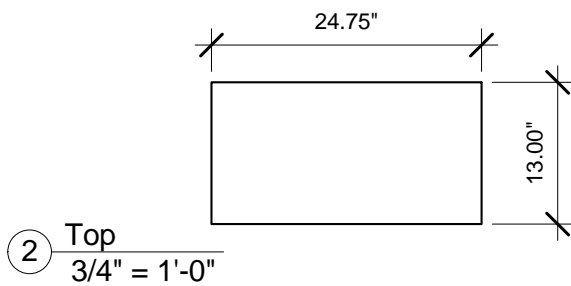

Wall Cabinets are designed for flush face construction with a recessed back panel for uneven wall surfaces. Solid doors are double walled for added strength and sound deadened for optimal performance.

PO#: _____ DATE: _____

APPROVAL: _____

TITLE: _____

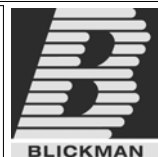

PROPRIETARY AND CONFIDENTIAL
THE INFORMATION CONTAINED IN THIS
DRAWING IS THE SOLE PROPERTY OF
BLICKMAN HEALTH INDUSTRIES. ANY
REPRODUCTION IN PART OR AS A WHOLE
WITHOUT THE WRITTEN PERMISSION OF
BLICKMAN HEALTH INDUSTRIES IS PROHIBITED.

UNLESS OTHERWISE SPECIFIED:
DIMENSIONS ARE IN INCHES
BEND RADIUS = MTL THK.
TOLERANCES:
FRACTION: ± 1/32"
DECIMAL: ± .031"

	NAME	DATE
DRAWN	JG	2-2-12
ENG APPR.		
MATERIAL		
300 SERIES S/S		
FINISH		
APPRX WEIGHT = lbs		
DO NOT SCALE DRAWING		

BLICKMAN, INC CLIFTON, NJ		
TITLE: A24MS WALL CABINET		
SIZE A	DWG. NO. 2020224360	REV
SCALE: 1:16	SHEET 1 OF 1	