



*Examine Real Quality & Value™*

# OPERATION, CARE & MAINTENANCE

## POWER IMAGING TABLES

*Models 85100, 85200, 85300 & 85309*



*Model 85300*



*Model 85100*

*Model 85200*

*Model 85309*

## THANK YOU

Thank you, for selecting and purchasing quality Clinton equipment. We are proud to serve your medical equipment needs with products that deliver value and offer superior performance. Please read these instructions carefully to insure your Clinton products are used and operated according to specifications and that they are maintained to Clinton's recommendations.

## SPECIFICATIONS

All models have a load capacity of 450 lbs.

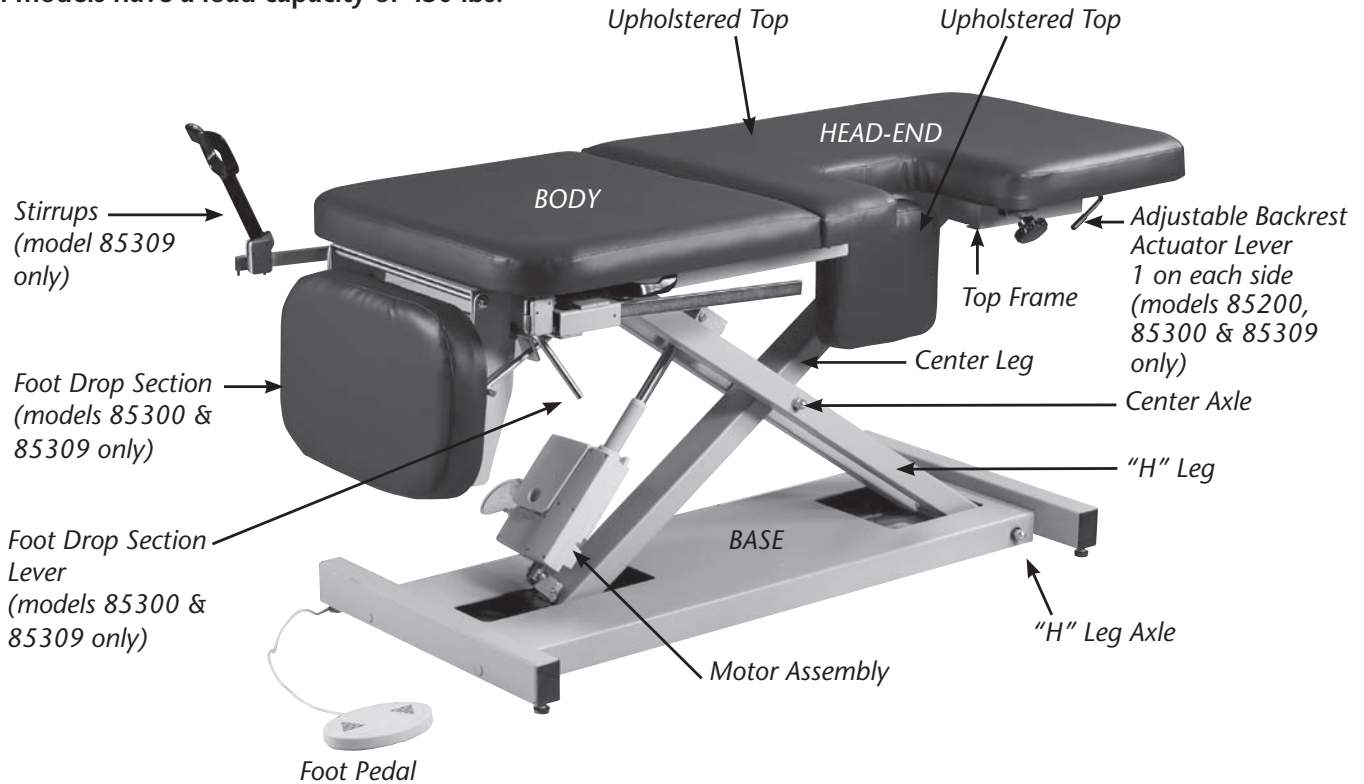

### Model Dimensions

#### Power Imaging Table with Drop Window

85100	Length	Width	Height Range
Overall	72"	27"	18"-35"

#### Power Imaging Table with 3 Section Top

85300	Length	Width	Height Range
Overall	76"	27"	18"-35"
Backrest	38"	27"	
Drop Section	13"	27"	

#### Power Imaging Table with Adjustable Backrest

85200	Length	Width	Height Range
Overall	72"	27"	18"-35"
Backrest	38"	27"	

#### Multi-Use Power Imaging Table with Stirrups

80330	Length	Width	Height Range
Overall	76"	27"	18"-35"
Backrest	38"	27"	
Drop Section	13"		

## Motor Specifications

---

### Duff Norton Motor *(standard on all models)*

The Duff Norton Motor is NOT UL listed for either the US or Canada. It IS, however, approved by the "CE" for use in Europe.

### Duff Norton Motor Power Ratings

		Push	Duty Cycle
120VAC	6 amps	8000N	1.8 min. of constant use out of every 18 min.

### SKF Motor *(optional on all models)*

The SKF Motor IS UL/CSA listed via cURus listing. It meets all qualifications for both the US and Canada AND 60601-1 Standards at the component level.

### SKF Motor Power Ratings

		Push	Duty Cycle
120VAC	8 amps	8000N	1 min. of constant use out of every 9 min.

## CLEANING GUIDELINES

---

Clinton uses only premium vinyl for upholstery, however, care should be taken when cleaning to ensure that the upholstery or color is not affected by the cleaning agent. Use only mild cleaning agents on upholstery. Clinton recommends using a 1 to 1 mix of ammonia and water or a 1 to 4 mix of bleach and water, rinse thoroughly with clean water and pat surface dry. This is not a guarantee and does not relieve the user from responsibility of the proper and safe use of all cleaning agents. Test on inconspicuous area prior to using any cleaning agent on upholstery's visible surface. Certain cleaning agents can be harmful to the surface.

## WARRANTY

---

Clinton Industries warrants manufactured products to be free of defects in materials, workmanship or design under normal use for three years on all mechanical products and one year on all electric equipment, from the date of purchase. This warranty does not include damage resulting from accident, abuse or misuse, alteration, or negligence of the product and expressly excludes normal wear of parts (including but not limited to vinyl). Contact Clinton for full warranty details.

## ADJUSTMENTS

---

### **BACKREST** *(models 85200, 85300, & 85309 only)*

---

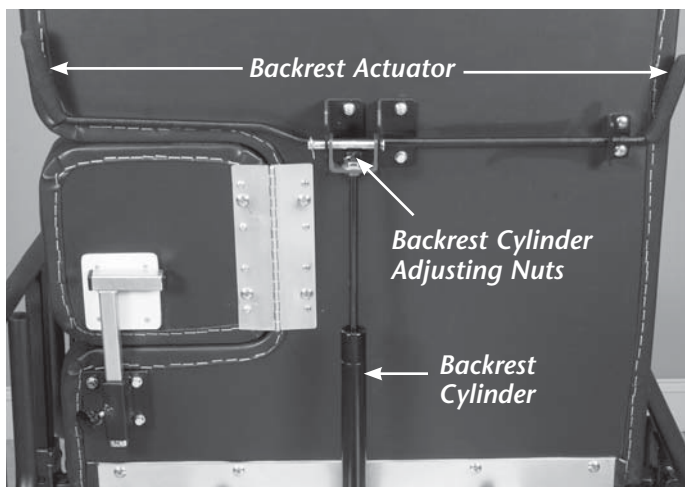

The backrest can be adjusted from either side of the table using the backrest actuator. Rotate the actuator towards the backrest to adjust. Always use your hand on top of the upholstered top to move the backrest up or down. The backrest cylinder is pressurized in the up position only and requires force to return it to the down position.

## ADJUSTMENTS *(continued)*

### BACKREST CYLINDER REPLACEMENT *(models 85200, 85300 & 85309 only)*

The backrest cylinder is replaceable in the field by following these simple directions below.



Remove cotter pin. Then remove the slide-out pin. Position tab located on the adjustment bar against cylinder pin.

Align holes in cylinder bracket with holes in table bracket by adjusting the angle until the holes line up. Install slide-out pin through holes and replace cotter pin.

Finished view of cylinder assembly.

### STIRRUPS *(model 85309 only)*

Stirrups are shown in the stored position in photo below at left. When extended, stirrups have two width positions. Position 1 is the narrowest and Position 2 the widest. The length of the stirrups can be adjusted by moving the stirrup slider to the desired location. When the patient applies foot pressure to the stirrup, it will automatically lock into position. To return the stirrups to the stored position, fold the stirrup over onto the slider bar and slide BOTH towards the head end of the table. The stirrup will store under the upholstered top.



Stirrups in the stored position

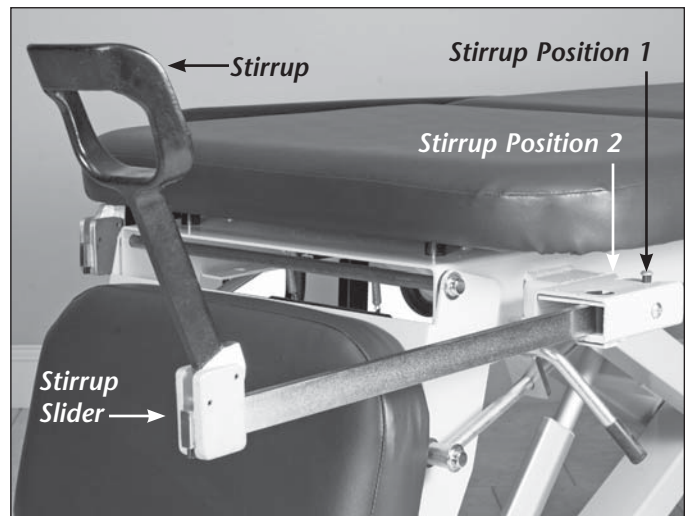

Stirrup positions

## ADJUSTMENTS *(continued)*

### FOOT DROP SECTION *(models 85300 & 85309 only)*

---

The Foot drop section is located at the foot-end of the table and is shown below at left in a semi-extended position. The foot drop section can be raised and lowered using the foot drop section levers on either side of the table. To lower the foot drop section, place your hand under the upholstered top of the foot drop section and move the lever forward towards the foot-end of the table. The lever must be kept in the forward position while gently lowering the foot drop section. To raise the drop section, place your hand under the upholstered top and gently lift. The foot drop section levers will automatically move forward and the foot drop section will lock into position wherever the lifting motion is stopped.



*Drop Section in the semi-raised position*



*Drop Section in the down position*

### DROP WINDOW *(all models)*

---

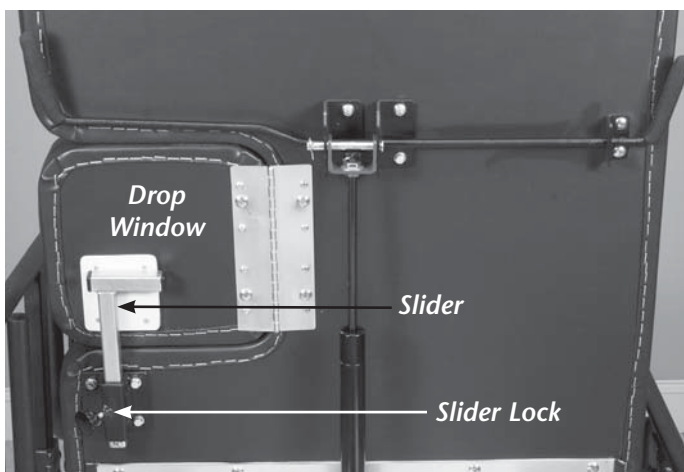

The drop window should only be opened or closed when the backrest is in the DOWN position. To open the window, unscrew the slider lock knob one turn to the left (counterclockwise). Move the slider past the window area and gently lower the drop window. To close the drop window, raise the window flush with the top, move the slider back over the drop window. Secure the slider in place by turning the slider lock knob one turn to the right (clockwise).



## ADJUSTMENTS *(continued)*

### OPTIONAL LOCKING CASTERS *(all models)*

Locking casters are an option on all models. The locking mechanism can be engaged by using your foot to depress the tab located at the rear of each caster. This locks the swivel of the caster and acts as a brake to minimize movement of the wheel. **ALL FOUR CASTERS MUST BE LOCKED TO ENSURE MINIMAL MOVEMENT OF THE TABLE.** Casters can be added or removed in the field.



*Caster in the mobile position.*



*Caster in the lock position.*

## TROUBLE SHOOTING

**PROBLEM:** *Table is squeaking.*

**SOLUTION:** Lubricate the table at designated points using Molykote G-0052Fg grease. See drawing below for lubrication locations.

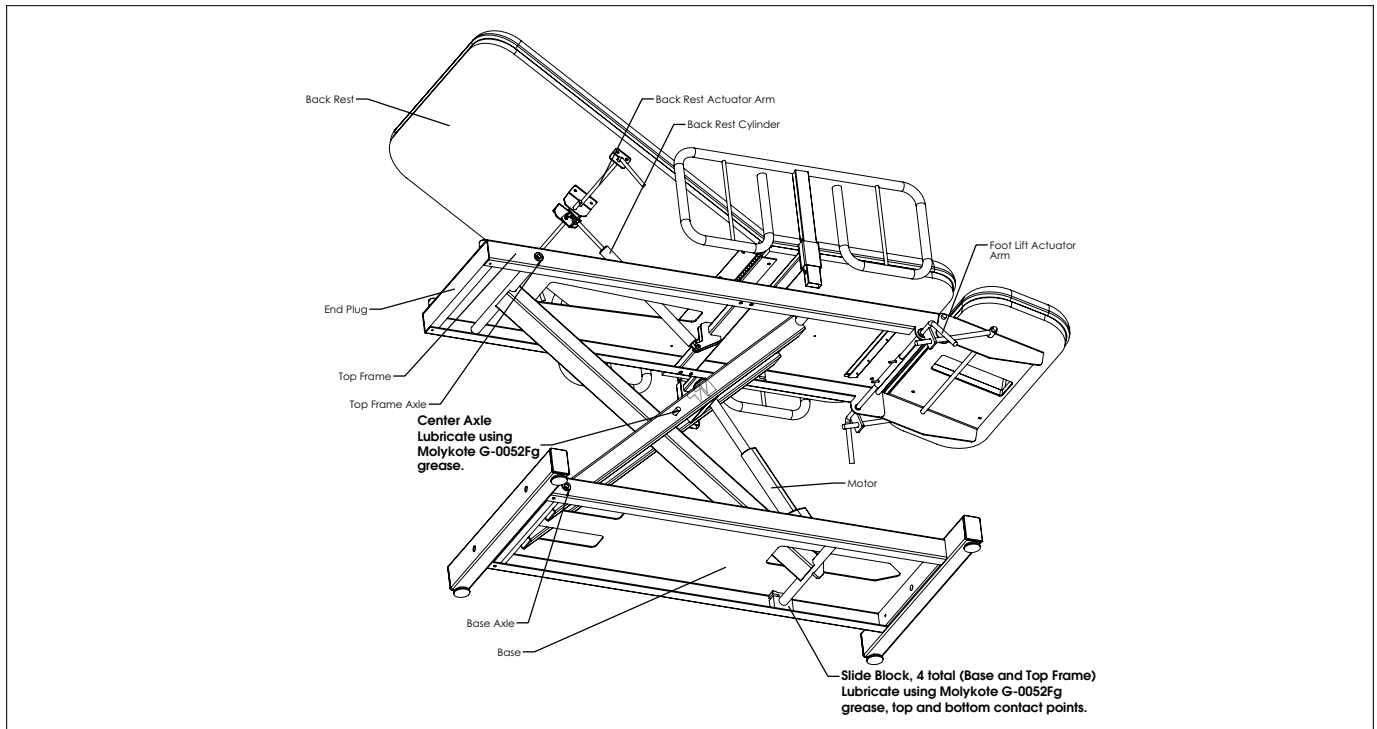

## TROUBLE SHOOTING *(continued)*

**PROBLEM:** *Backrest does not function properly.*

**SOLUTION:** If the headrest does not remain flat in the down position, loosen nut "A" and tighten nut "B."

If headrest does not move at all, loosen nut "B" and tighten nut "A."

After proper function has been achieved, tighten both nuts.

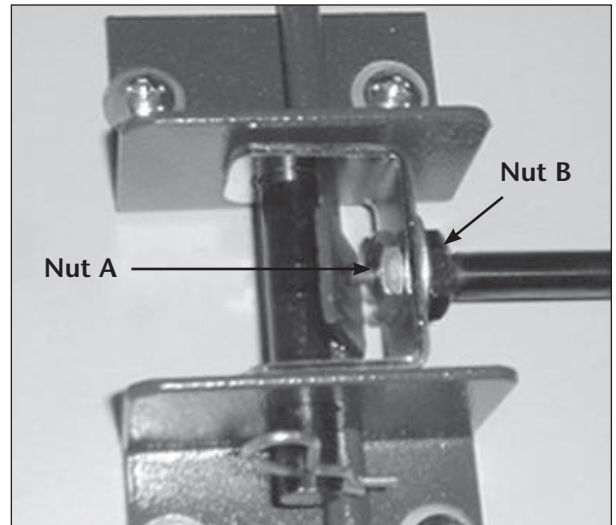

**PROBLEM:** *Table height adjustment will not work properly.*

**SOLUTION:** Make sure the table is connected to a working electrical outlet. Inspect all power cords for cuts or breaks that would interfere with the electrical connection. Check to make certain foot pedal cord is properly and securely plugged into motor. If after checking all these areas, the table will not operate, or operates improperly, call a technician, or call Clinton Industries at 800-441-9131 for assistance.

### REMOVAL OF THE MOTOR FOR SERVICE

The motor assembly is located at the foot-end of the table on the base. Next, detach the motor assembly. If possible, raise the table to its highest position. Raising the table will make it easier to remove the motor mount bolts. Using help, lower the table onto its side onto a protective surface such as a blanket or other material that will not harm the upholstered top. Remove the foot pedal controller by unplugging the DIN plug on the side of the motor. Carefully remove the upper and lower motor mount bolts to free the motor assembly.

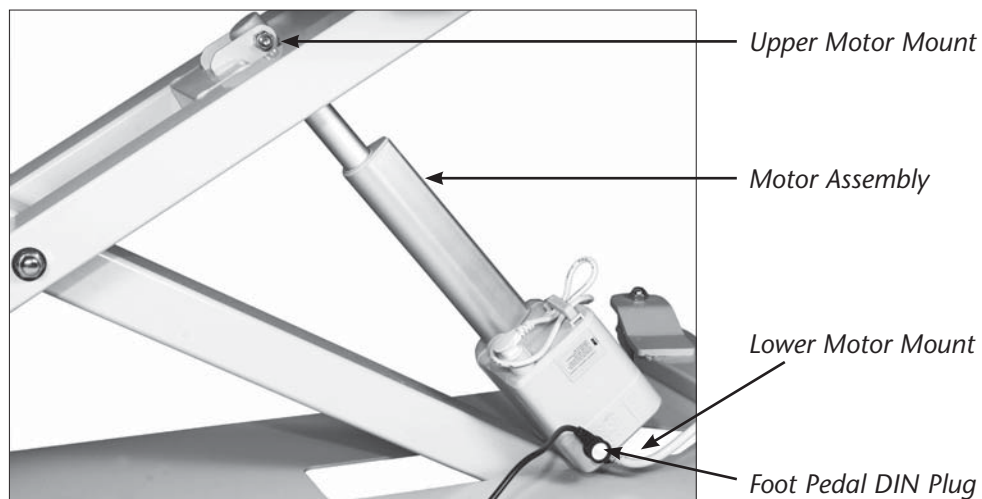



*Examine Real Quality & Value™*