

3D IMAGING C-ARM TABLE

OPERATION MANUAL

058-820
058-825



BIODEX

Biodex Medical Systems, Inc.





3D IMAGING C-ARM TABLE







This manual covers installation and operation procedures for the following Imaging C-Arm Table products:

- #058-820 3D Imaging C-Arm Table, 115 VAC
- #058-825 3D Imaging C-Arm Table, 230 VAC

NOTE: All or some of the following symbols, cautions, warnings and notes may apply to your Gait Trainer 3 and correspond to this operation manual:

Symbol	Meaning
	<i>DANGER: will result in an imminently hazardous situation if not avoided.</i>
	<i>WARNING: will result in a potentially hazardous situation if not avoided.</i>
	<i>CAUTION: may result in a potentially hazardous situation if not avoided.</i>
	<i>ATTENTION: consult accompanying documents.</i>

Symbol	Signification
	<i>DANGER : aura comme conséquence une situation d'une manière imminente dangereuse sinon évitée.</i>
	<i>AVERTISSEMENT : aura comme conséquence une situation potentiellement dangereuse sinon évitée.</i>
	<i>ATTENTION : peut avoir comme conséquence une situation potentiellement dangereuse sinon évitée.</i>
	<i>ATTENTION : consultez les documents d'accompagnement.</i>

 **CAUTION:** Federal law restricts this device to sale by or on the order of a medical practitioner. When prescribed for therapeutic purpose, a physician should clearly define the parameters of use (i.e., total work, maximum heart rate, etc.) to reduce the risk of patient injury.

INTRODUCTION

3D Imaging C-Arm Table features motorized actuation of height, X-Y tabletop, lateral roll and Trendelenburg motions, and is supported by a full line of optional accessories for imaging procedures.

Both AC and battery power are standard. When operating on battery, there are no power cords to catch on feet or block table wheels. Battery charging can be accomplished during off-hours by plugging in the AC power cord. An additional, optional battery and charging unit can provide continuous cordless operation.

 **IMPORTANT NOTE:** Remove battery if storing table for prolonged time.

 **IMPORTANT NOTE:** Lever la batterie si le table se garder en reserve por temps prolongement.

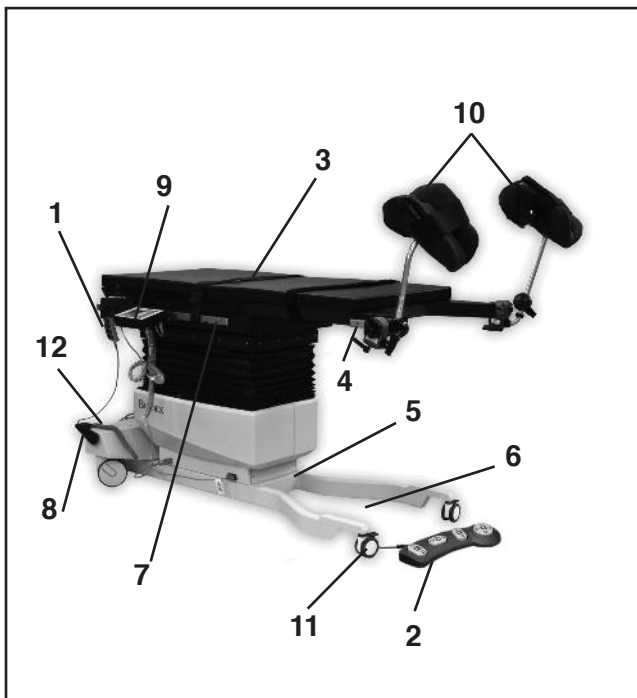



Figure 1. Parts and adjustment mechanisms.

1. Hand-Held Controller
2. Foot Controller
3. Body Restraining Straps
4. Stepper Positioning
5. Low Profile Base
6. Open Leg Design
7. Accessory Rail
8. Head End Locking Brakes and Swivel Casters
9. Main Control Panel
10. Left and Right Knee Crutches
11. Foot End Individual Locking Casters
12. Battery Pack

OPERATING INSTRUCTIONS

NOTE: This table can be operated with the power cord connected to an outlet or by using the battery. The battery recharges automatically while the table is plugged into an outlet even if the table is being used.

NOTA: Cette table fonctionne avec le cordon d'alimentation branché sur une prise ou à l'aide de la batterie. La batterie se recharge automatiquement lorsque le cordon est branché sur une prise, même si la table est en cours d'utilisation.

 **CAUTION:** Hospital grade plug to be plugged into a hospital grade receptacle only to achieve grounding reliability.

 **ATTENTION:** La fiche de qualité hùpital ne doit être branchée que sur une prise de courant de qualité hùpital, pour une mise à la terre fiable.

 **CAUTION:** Before transferring a patient onto or off the table, ensure all four caster brakes are locked. Secure the restraining straps immediately after positioning the patient on the table.

 **ATTENTION:** Avant le transfert du patient sur la table ou hors de la table, s'assurer que les quatre freins des roulettes sont bloqués. Fixer les lanières d'immobilisation dès qu'on a positionné le patient sur la table.

 **CAUTION:** The restraining straps are not intended to restrain an uncontrolled patient.

 **ATTENTION:** Les lanières d'immobilisation n'ont pas pour objet l'immobilisation d'un patient hors de contrôle.

The Locking Brakes and Swivel Casters

(See Figure 2.)

The locking brakes and swivel casters allow this table to glide effortlessly on hard surfaces and across firm rugs.

1. To release the brakes, use your toe to lift up on the caster locking lever (located at the head end of the table).
2. To lock the brakes and roll the table, step down on the caster brake lever.
3. The Foot End Casters are locked and released individually. Press down on the caster brake lever to lock, pull up on the caster break to release.

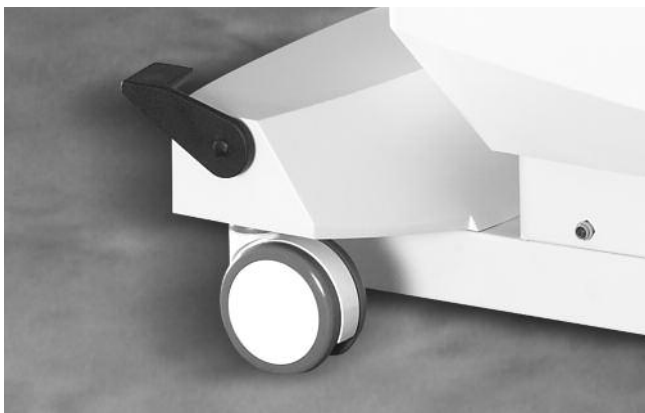

Figure 2. Locking brakes and swivel casters.

Using the Main Control Panel

The LCD Screen of the Main Control Panel displays actual tabletop position (all axes) in real time, and provides menus and prompts for positioning the table and saving up to ten table position settings which can be recalled.

The Main Control Panel can operate off battery or AC power. When the table is turned ON, the display shows the current table position.

The table motion buttons (tabletop X,Y, Trendelenburg, reverse Trendelenburg and lateral roll) are located on the right side of the Main Control Panel and correspond to the illustrations on the display panel. To activate any table motion button, press and hold the Activate button on the bottom left side of the control panel. While holding the Activate button down, press any of the table motion buttons to move the table to the desired position.

At the bottom right of the display, a Level button can be pressed (while holding down the Activate button) to bring the tabletop level at any time. The Home button, located next to the Level button, is used to bring the table to its lowest, level position.

Up to ten table set positions can be stored from the Current Table Position screen using the Main Control Panel. Buttons to perform the save procedure are located immediately to the right of the screen. To save any position in which you place the table, press the Save (top) button. The system will save the appropriate information and assign a numeric value from one to ten for that position. The position values will be displayed on the screen.

If all ten position set values are stored, the display will ask if you would like to delete a position. If so, allow the screen to return to the Current Table Position screen, then press the button opposite the "Display Saved Table Positions" prompt. You can now use the top button to scroll through the position set values until the one you wish to delete is displayed. Press the button opposite the prompt "Delete Saved Position Set." The system will request confirmation to delete. Press the button opposite "Yes" to confirm.

At this point, you can follow the prompts to delete another table position set, choose to move the table to the currently displayed position, or select another position.

Using the Hand-Held Controller

The Hand-Held Controller may be used to adjust table height, Trendelenburg/Reverse Trendelenburg, lateral roll and X-Y positioning. When not in use, the Hand-Held Controller can be hooked onto the metal loop on the restraining strap, or on the the accessory rail.



CAUTION: Before moving the tabletop, be sure that all I.V. lines, attachments and restraining straps, etc., are out of the way. Ensure the patient is fully secured to the tabletop by the restraining straps.



ATTENTION: Avant tout déplacement du dossier, veiller à en dégager les lignes de goutte-à-goutte intravéneux, les accessoires, les lanières d'immobilisation, etc. S'assurer que le patient est solidement fixé au dossier à l'aide des lanières d'immobilisation.

To adjust the table position, press and hold the appropriate switch on the hand-held controller. The tabletop will move or rotate in the direction indicated by the switch. Release the switch when the table top achieves the desired position.

Using the Joystick Controller

The Joystick Controller for motorized X-Y positioning allows intuitive positioning with proportional speed control. An adjustable icon indicator, on the top base of the joystick, can be rotated so that the joystick X-Y positioning correlates directionally to actual tabletop motion. If you move the joystick to the opposite accessory rail, be sure to rotate the icons to match.

To prevent undesired motion by accidental contact with the joystick, a thumb button on the top of the joystick must be pressed for activation.

Using the Foot-Controller

(See Figure 3.)

The Foot-Controller activates all motions. The four separate rocker style pedals control two movements each. From left to right on the Foot-Control, press and hold down the appropriate rocker switch to adjust Trendelenburg/Reverse Trendelenburg positioning, lateral roll, tabletop height and X-Y motion. Releasing the rocker switch at any time immediately stops the motion.

NOTE: When the table is used in a wet environment, it is recommended that the Foot Controller be covered with a plastic bag and sealed as watertight as possible.



Figure 3. The Foot-Controller can be used to adjust Trendelenburg/Reverse Trendelenburg positioning, lateral roll, tabletop height and X-Y motion.

Tabletop Extensions

(See Figure 4.)

There are two tabletop extensions included with the 3D Imaging C-Arm Table. The Radiolucent Extension (29" l) is used to extend the table when transferring a patient and can be used during imaging as it contains no metal cross members. The Head-End Extension (18.2" l) is also used to extend the length of the table but is non-viewable and cannot be used for imaging. Both extensions are installed using the same procedure.

To install the extensions:

To attach the extensions, simply hook the extension guides over the accessory rails at either end of the table and lower the extension into position. (See Figure 4.)

To uninstall the extensions:

Lift the end of the extension slightly and pull toward you. The extension will slide out.



Figure 4. Installing tabletop extensions.

Knee Crutch Installation

(See to Figure 5.)

The optional Knee Crutch set includes a left and right rail clamp and two offset ratchet arms. Install the rail clamps onto the accessory rails and then the offset arms with knee crutches into the rail clamps. Note that the offset ratchet arms should be inserted into the knee clamps from the foot end of the table. The wide end of the knee crutches face toward the head end of the table.

To adjust positioning of the offset arms, loosen locking lever on the crutch clamps, move the arms to the desired position and re-tighten the lever.

To adjust positioning of the crutch pads, loosen the crutch pads locking levers and tilt the pads as required.

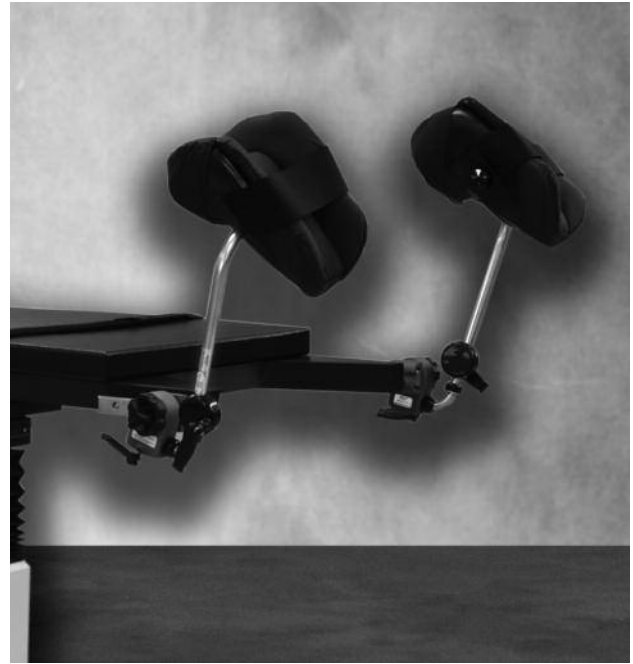

Figure 5. Knee crutches properly installed.

Arm Boards

Standard or Dura Board Arm Boards are optional. Install the rail clamps onto the accessory rails and then insert the arm board posts into the clamps and tighten to secure. To move the armboards in a horizontal plane, loosen the locking knob on the block, move the armboard to the desired position and re-tighten the knob.

I.V. Pole

The optional adjustable height I.V. pole should be installed onto the accessory rail. Loosen the I.V. pole locking knob at the base of the slide block and slide the block and pole onto the accessory rail until it is in the desired position. Tighten the locking knob to secure the pole.

To adjust the height of the I.V. pole, loosen the height adjustment locking knob and raise or lower the top section of the pole to the appropriate height. Tighten the locking knob to secure.

Disposable Skirt

(See Figure 6.)

The Biodex 3D Imaging Table includes a supply of disposable plastic sanitary skirts to protect the table bellows from patient blood, liquids, etc. The table is encircled by a magnetic-backed rubber strip, located immediately above the bellows. Secure the skirt to the bellows as described.

1. Lift the lower section of the strip on each side of the table.
2. Slide the plastic skirt underneath the strip at the foot end of the table, then lower the strip to hold the skirt in place.
3. Work around the table, tucking the top edge of the plastic skirt under each strip and lowering the strip to secure the plastic until the bellows are completely unwrapped. Be sure to overlap the skirt across the entire length of the table's foot end.
4. Remove and replace the plastic skirt for each new patient.

NOTE: Additional Bellows Skirts (part #056-802) can be ordered from Biodex Medical Systems, Inc.

Charging The Battery

This table can be operated with the power cord connected to an outlet or by using the battery. The battery recharges automatically while the table is plugged into an outlet even if the table is being used. An optional wall-mounted battery charger is also available.



Figure 6. Lift the lower section of the strip on each side of the table, slide the plastic skirt underneath and lower the strip to hold the skirt in place.



SAFETY GUIDELINES

1. Secure restraining straps and ankle safety straps immediately after placing the patient on the table. The ankle safety straps prevent the patient from sliding off the table in the Trendelenburg position. The restraining straps prevent the patient from rolling off the side of the table.

NOTE: The restraining straps are not intended to restrain an uncontrolled patient.

2. Always lock the casters before moving a patient onto or off the table.
3. This table is rated to support patients weighing up to a maximum of 500 pounds.



CONSIGNES DE SECURITE

1. Fixer les lanières d'immobilisation et les lanières de cheville immédiatement après avoir placé le patient sur la table. Les lanières de cheville empêchent le patient de glisser sous la table en position de Trendelenburg. Les lanières d'immobilisation empêchent le patient de rouler par-dessus le côté de la table.

NOTA: Les lanières d'immobilisation n'ont pas pour objet l'immobilisation d'un patient hors de contrôle.

2. Toujours bloquer les roulettes avant de faire monter le patient sur la table ou de le faire descendre.
3. La table est certifiée comme pouvant supporter un patient pesant au plus 182 kg (400 lb).

Maintenance and Cleaning

This Biodex table is virtually maintenance free. By following the instructions below at suggested time intervals, or as often as necessary, your table will remain in "like new" condition.

1. As required, clean all exterior painted surfaces, tabletop and restraining straps with a mild detergent solution.
2. Wheels and wheel locks should remain free of foreign materials and dirt accumulation. Keeping wheel assemblies free of this matter will ensure smooth table transportation and free lock/unlock wheel operation.

SPECIFICATIONS

058-820 3-D Imaging C-Arm Table, 115 VAC
058-825 3-D Imaging C-Arm Table, 230 VAC

Dimensions: 103.75" l x 26" w (264 x 66 cm) with OR accessory rails

Tabletop: 103.75" l x 24" w (264 x 61 cm) includes head and leg extension

Radiolucent Area:

3D Imaging Area: 22.5" l x 24" w (57.1 x 61 cm)

Radiolucent Extension (Fibersin™, non 3D):
29" l x 22.5" w (73.6 x 57.1 cm)

Total Radiolucent Area (Combined): 51.5" l (131 cm)

Head-End Extension (non viewable): 18.2" l x 24" w (46 x 51 cm)

Base Clearance to Floor: 1.5" h (4 cm)

Tabletop Material: Carbon fiber

Mattress: Vinyl covered 2" thick (5 cm)

Motions:

Height Adjustable: 34" h to 44" h (86 to 112 cm)

Tabletop X Motion (head to toe): 10" (25 cm)

Tabletop Y Motion (side to side): 10" (25 cm)

Trendelenburg: 0° to 20°

Reverse Trendelenburg: 0° to 20°

Lateral Roll: 0° to 20°

Controls:

Hand Control: Activates all motions

Foot Control: Activates all motions

Main Control Panel: LCD screen displays actual tabletop position (all axes) in real time, and provides menus and prompts for other functions.

Joystick Control: for motorized X-Y positioning

Wheels:

Head End: 3" (7.6 cm) swivel casters, integral locking system on base

Foot End: 5" (12.7 cm) swivel casters with central locking

Accessory Rails: Standard OR accessory rails, 1.125" x .375" (2.86 x .95 cm). Head-End 30" l (75 cm); Foot-End 7.75" l (20 cm)

Patient Capacity: 500 lb (227 kg); weight tested to four times the patient load rating.

Power: 115 VAC or 230 VAC and Battery. Battery automatically charges when table is plugged in. An additional battery can be charged with optional wall-mounted charger.

Weight: 542 lb (246 kg)

Shipping Weight: 684 lb (310 kg)

Warranty: Two year

Certifications: ETL and cETL listed to UL-60601-1, CAN/CSA® C22.2 No.: 601-1-M90, EN 60601-1 and IEC- 60601-1-2:2001-09

Optional:

056-862 Battery and Wall Charging Unit, 115 V
056-863 Battery and Wall Charging Unit, 230V
056-851 Drain Bag Frame
056-850 IV Pole, rail mounted
056-853 Crutch, Knee, Simplicity (pair)
058-862 Stirrups, PAL with boot pad (pair)
058-863 Arm Board, Dura Board with pad (pair)
058-865 Arm Board, Standard (pair)

Replacement:

056-802 Bellows Skirt, disposable plastic 250/roll
Fits Surgical C-Arm Table 840,
Urology C-arm Table and Brachytherapy Tables
056-857 Drain Bags

Authorized European Community Representative:



Emergo Europe
Molenstraat 15
2513 BH, The Hague
The Netherlands



3D BRACHY C-ARM ASSY

3DBRACHYC-ARMASS058-820-A000-A

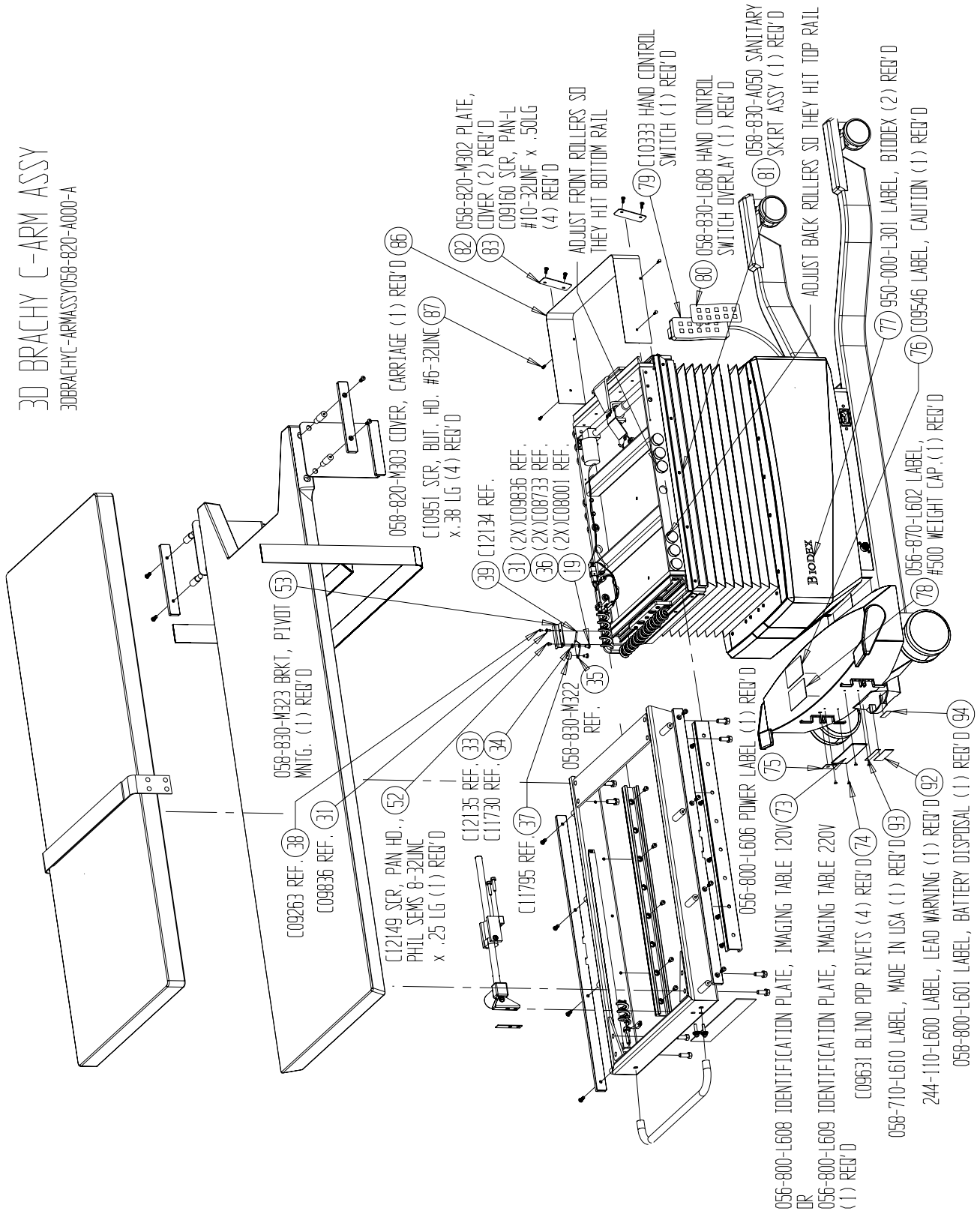

3D BRACHY C-ARM ASSY

3DBRACHYC-ARMASSTY058-820-A000-A

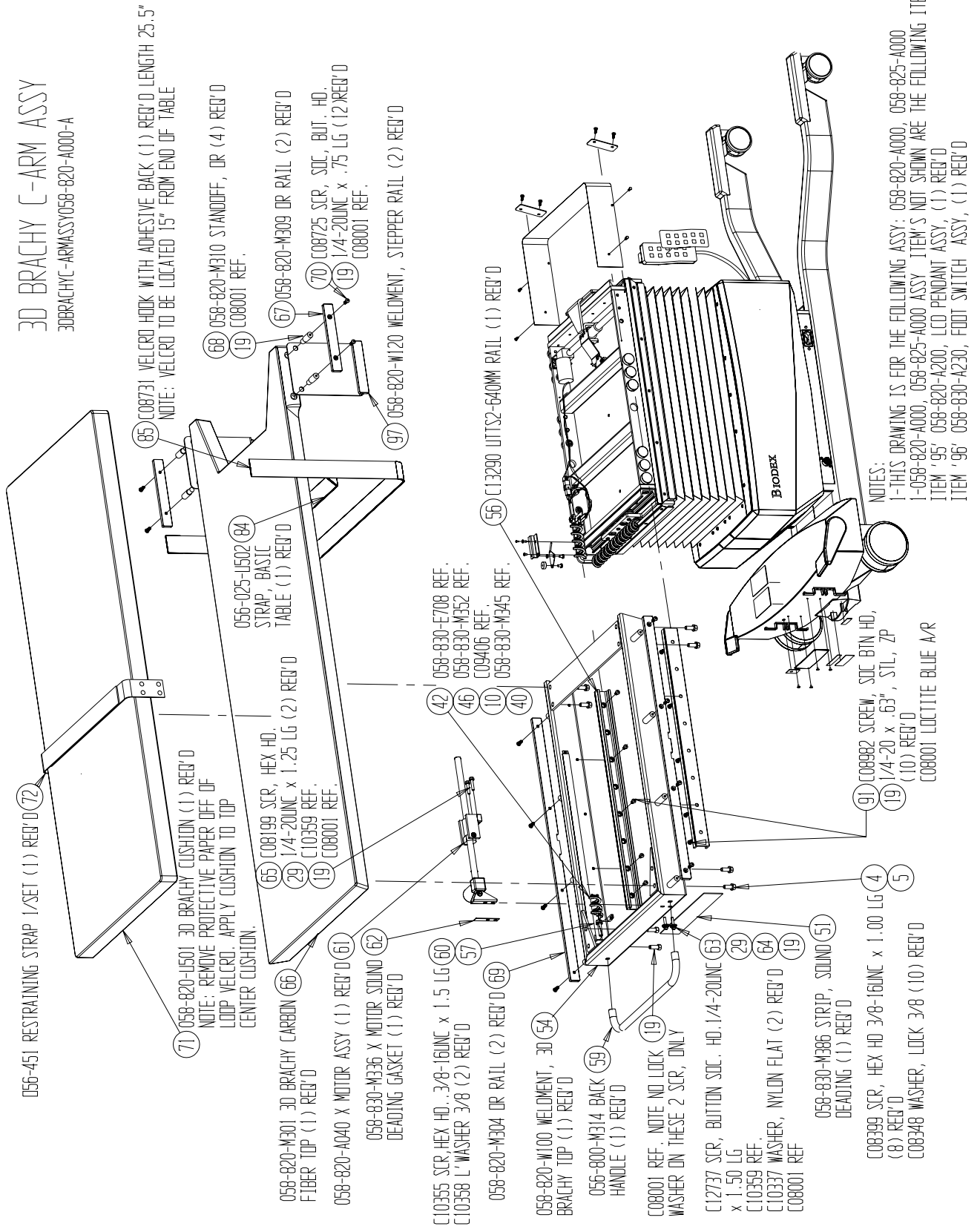

3D BRACHY C-ARM ASSY

3DBRACHYC-ASSY058-820-A000-A

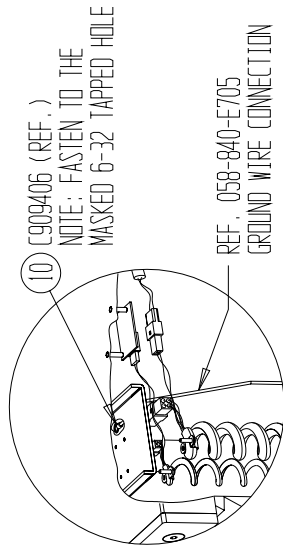

DETAIL -A-

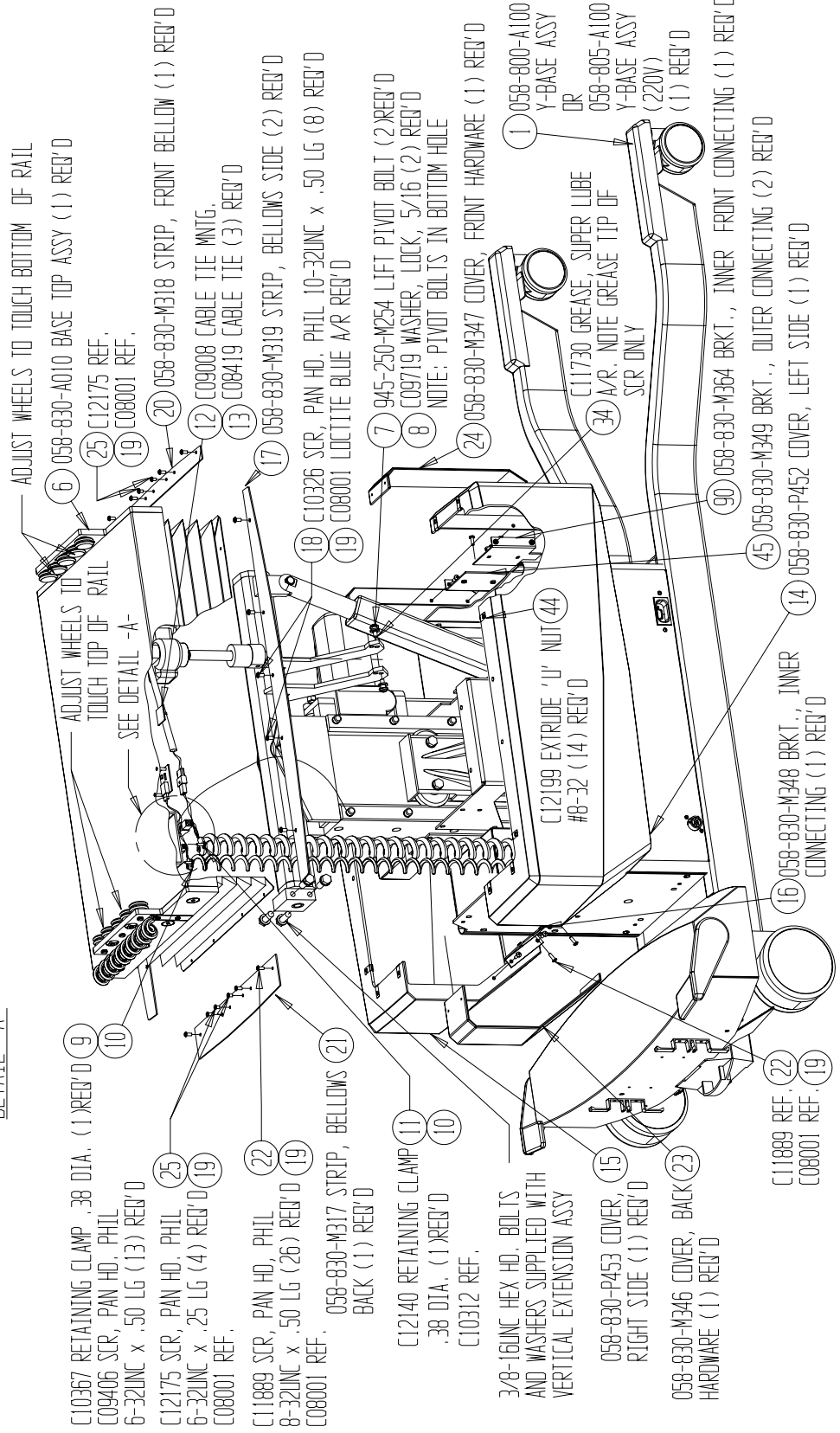

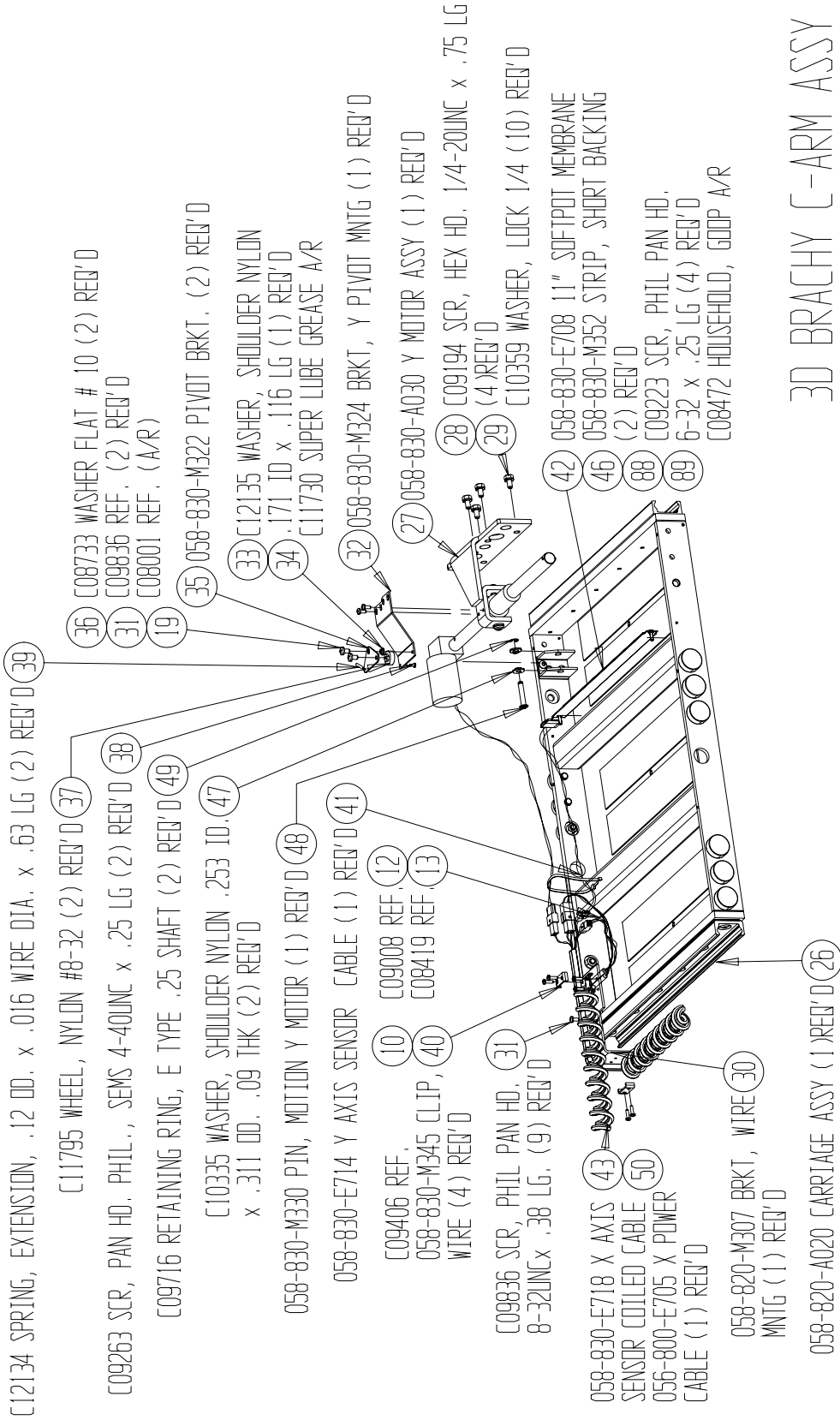

3D BRACHY C-ARM ASSY

3DBRACHYC-ASSY058-820-A000-A

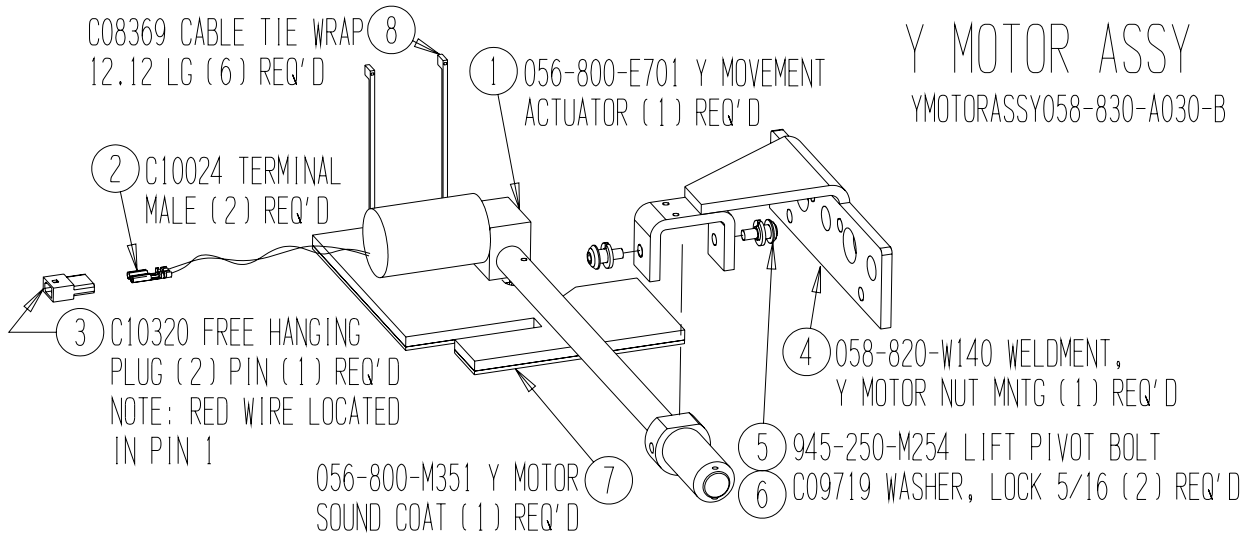
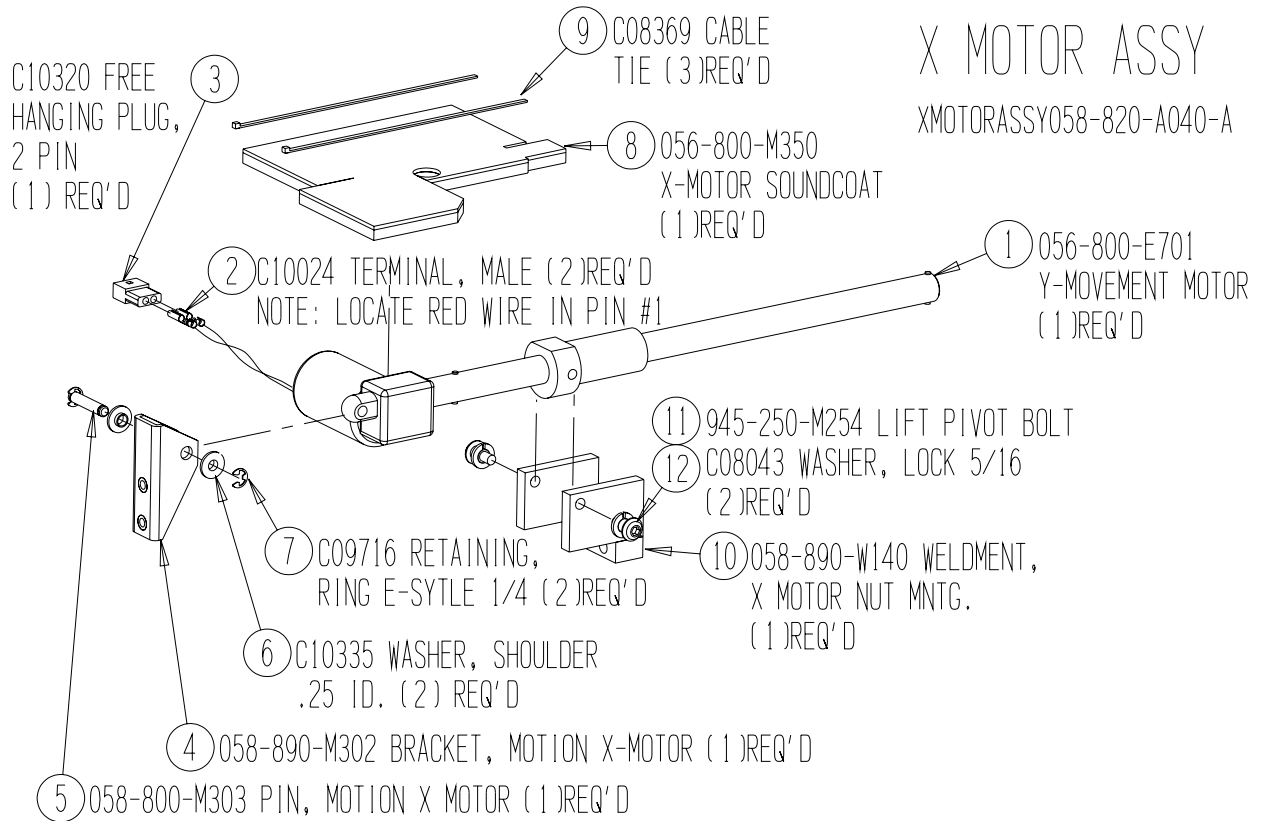

CARRIAGE ASSY

CARRIAGEASSY058-840-A070-A

058-830-M386 SOUND DEADING STRIP (6X) (18)
 NOTE: CENTER IN PAN DO NOT COVER DRAIN HOLE

056-840-M350 SHIM, .015 THK X-Y CARRIAGE (10)
 056-840-M351 SHIM, .005 THK X-Y CARRIAGE (11)
 056-840-M352 SHIM, .002 THK X-Y CARRIAGE (12)
 056-840-M353 SHIM, .001 THK X-Y CARRIAGE (13)
 (2) REQ'D

DO NOT TIGHTEN BOLTS
 SHIM ADJUSTMENT
 IS REQ'D

(17) C09880 LP3 RUST INHIBITOR APPLY RUST INHIBITOR WITH BRUSH ON MASKED SURFACES

(4) C13270 WHEEL,
 NON-ECCENTRIC
 (4) REQ'D
 C08001 REF

(6) C13271 WHEEL,
 ECCENTRIC (2) REQ'D

(7) 058-820-M308 BRKT, MOTION Y MOTOR MNTG (1) REQ'D FOR 058-840-A020 & 058-820-A020 OR 058-840-M320 BRACKET, Y MOTION MECHLOK MNTG (1) REQ'D FOR 058-840-A070

(8) 058-840-M325 Y MOTOR SOUND DEADING GASKET (1) REQ'D FOR 058-840-A070 ONLY

(4) C13270 REF
 (15) C08001 REF

(14) C13277 SW SERIES VEE CARRIAGE RAIL (440MM) (2) REQ'D

(9) C8173 REF
 (16) C08047 WASHER, LOCK 1/4, TRI-ZP (2) REQ'D

(9) C8173 SCREW, SOC BTN HD,
 1/4-20 x .50", STL, ZP (14) REQ'D
 C08001 LOCTITE BLUE A/R

(5) C09798 NUT, HEX,
 M8 x 1.25 ELASTIC
 LOCKING (4) REQ'D

(3) C13275 ROLLER,
 ECCENTRIC (2) REQ'D

(2) C13272 ROLLER, NON-ECCENTRIC (4) REQ'D
 (15) C08001 LOCTITE BLUE A/R

(3) C13275 REF

NOTE:
 LOCATE ITEMS 2,3,4,6 IN THESE HOLES FOR 058-820-A020

NOTE:
 LOCATE ITEMS 2,3,4,6 IN FRONT HOLES FOR ASSEMBLY 058-840-A020, 058-840-A070

(1) 058-820-W250 WELDMENT, CARRIAGE (1) REQ'D

NOTES:

- THIS DRAWING IS FOR THE FOLLOWING ASSY:
 058-840-A070, 058-840-A020, 058-820-A020

Y-BASE ASSY

Y-BASE ASSY 058-800-A100-A

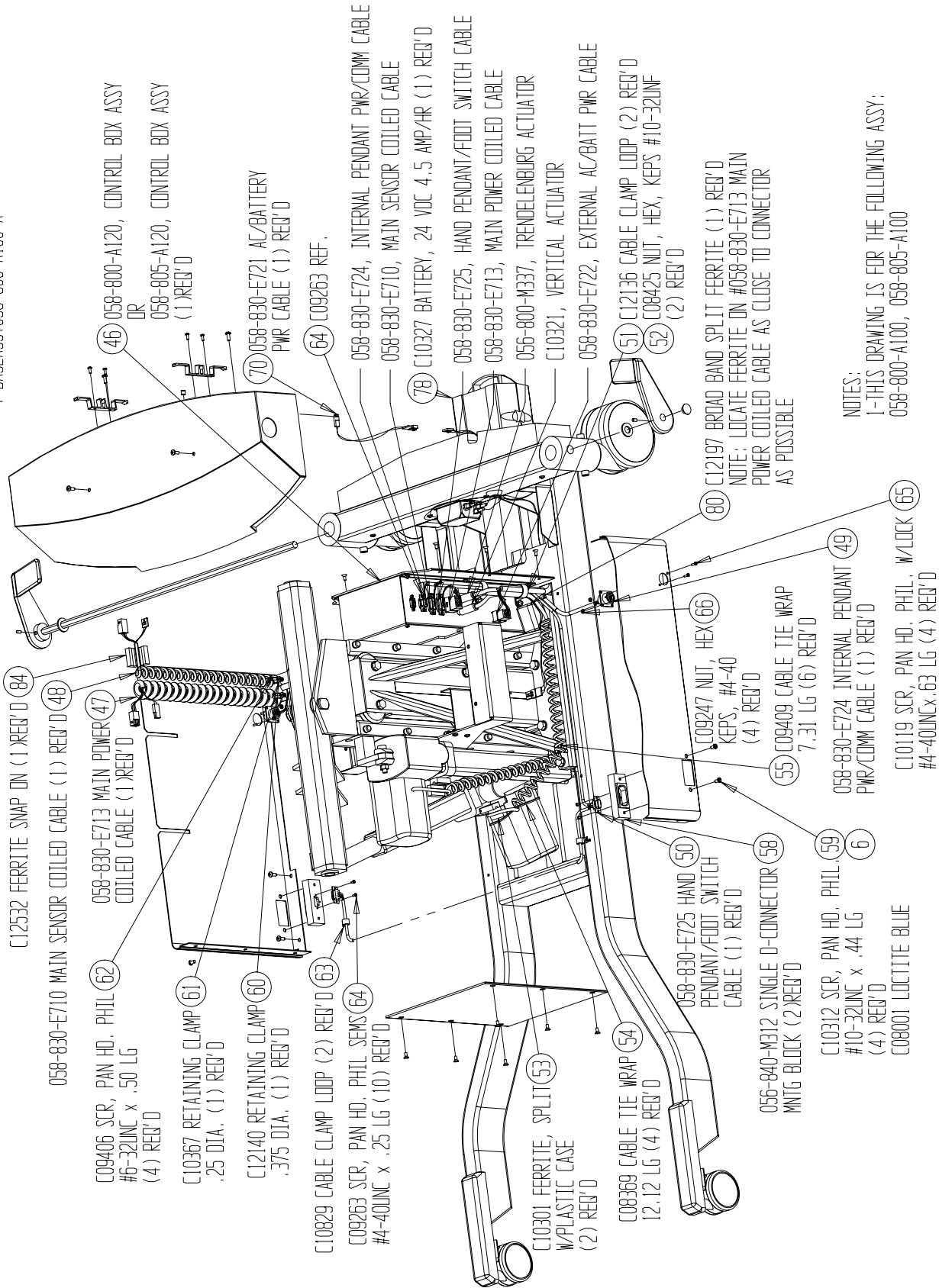

NOTES:
 1- THIS DRAWING IS FOR THE FOLLOWING ASSY:
 058-800-A100, 058-805-A100

Y-BASE ASSY

Y-BASE ASSY 058-800-A100-A

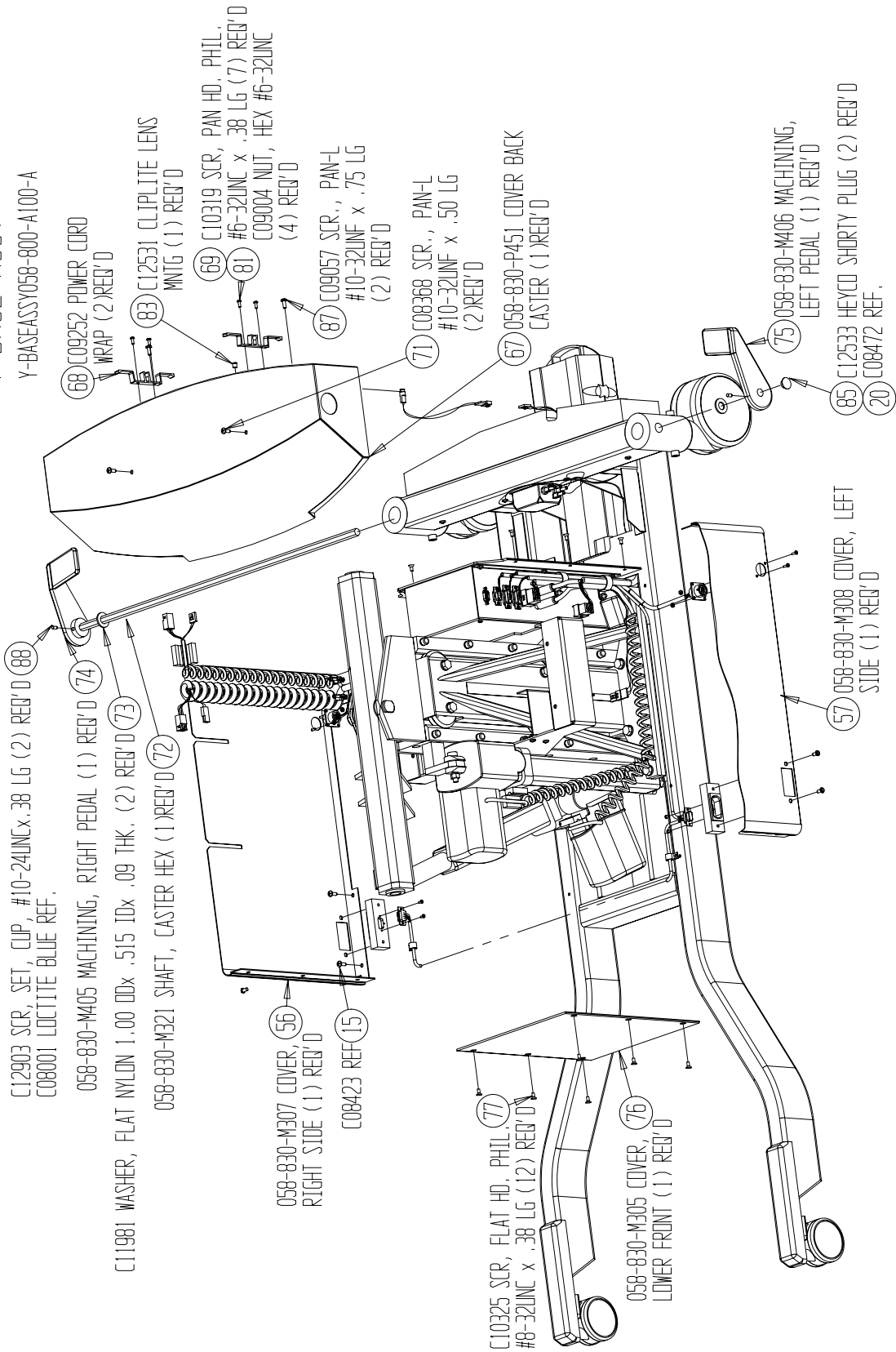

NOTES:
 1- THIS DRAWING IS FOR THE FOLLOWING ASSY:
 058-800-A100, 058-805-A100

Y-BASE ASSY

Y-BASEASSY058-800-A100-A

08559 NUT, HEX, 8MM (2) REQ'D (26)
 C08043 WASHER, LOCK 5/16 (2) REQ'D (4)

C10322 SCR, SHOULDER BOLT 28 (27)
 10 MM DIA. x 30MM LG (2) REQ'D (27)
 C08006 WASHER, FLAT 3/8 (4) REQ'D (4)

79 058-830-M352 STRIP, SHORT BACKING (1) REQ'D (86)
 C09223 SCR, PHIL., PAN HD. #6-32 x .25 LG (2) REQ'D (20)
 C08472 REF. (C08472 REF.)

44 058-830-E708 11" SOFTPOUT MEMBRANE (1) REQ'D (44)

14 C11643 FILTER, LINE, 2-STAGE G.P. (1) REQ'D (14)

12 056-800-E721 WIRE GROUND (1) REQ'D (12)

13 058-830-E734 WIRE, BREAKER TO LINE FILTER (1) REQ'D (13)

45 C09020 LABEL, GROUND (1) REQ'D (45)

10 REF. (10)

9 REF. (9)

8 C12133 REF. (8)

82 058-830-M362 REF. (82)

11 058-830-E722 EXTERNAL AC/BATT PWR CABLE (1) REQ'D (11)

18 C08996 SCR, PAN HD. (18)

6 PHIL #10-32UNF x .88 LG (2) REQ'D (6)
 C08001 LOCTITE BLUE A/R (C08001)

SEE WIRE DETAIL

17 C10314 SPACER, NYLON .50 DD. x .219 ID. x .31 LG (2) REQ'D (17)

16 056-800-E711 BATTERY CONNECTION (1) REQ'D (16)

25 C10321 LINEAR ACTUATOR (1) REQ'D (25)

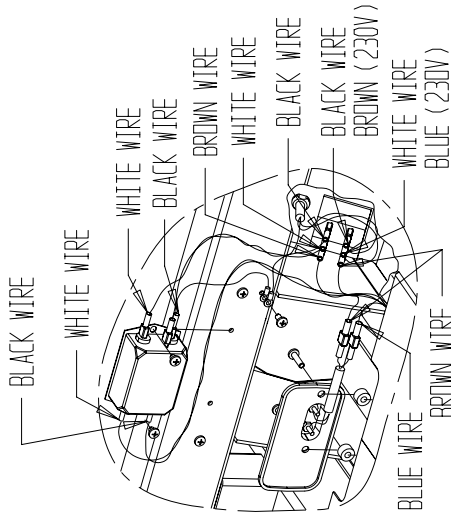

C13139 PIN, SLIC .491/.496 DIA. (2) REQ'D (30)
 C11730 GREASE REF. (41)

058-800-E713 TRENDLENBURG ACTUATOR (29)
 (1) REQ'D FOR THE FOLLOWING ASSY
 058-800-A100, 058-805-A100

Y-BASE ASSY

Y-BASE ASSY 058-800-A100-A

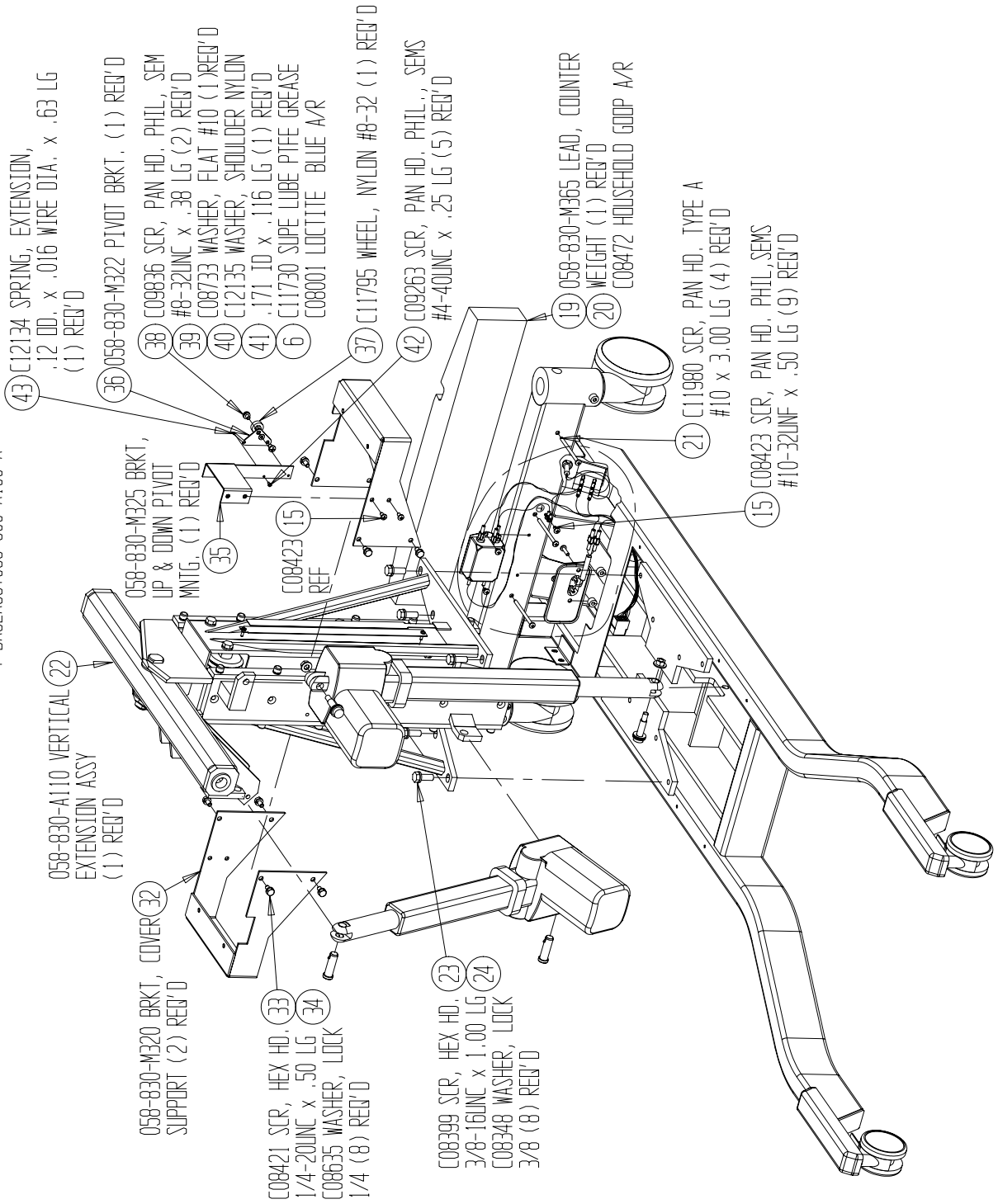

43 C12134 SPRING, EXTENSION,
.12 OD. x .016 WIRE DIA. x .63 LG
(1) REQ'D

36 058-830-M322 PIVOT BRKT. (1) REQ'D

38 C09836 SCR, PAN HD, PHIL, SEM

#8-32UNC x .38 LG (2) REQ'D

39 C08733 WASHER, FLAT #10 (1) REQ'D

40 C12135 WASHER, SHOULDER NYLON

.171 ID x .116 LG (1) REQ'D

6 C11730 SUPE LUBE PTFE GREASE

C08001 LOCTITE BLUE A/R

37 C11795 WHEEL, NYLON #8-32 (1) REQ'D

42 C09263 SCR, PAN HD, PHIL., SEMS

#4-40UNC x .25 LG (5) REQ'D

19 058-830-M365 LEAD, COUNTER

WEIGHT (1) REQ'D

C08472 HOUSEHOLD GOOP A/R

058-830-A110 VERTICAL
EXTENSION ASSY
(1) REQ'D

058-830-M320 BRKT, COVER
SUPPORT (2) REQ'D

C08421 SCR, HEX HD. (3)

1/4-20UNC x .50 LG (3)

C08635 WASHER, LOCK

1/4 (8) REQ'D

C08399 SCR, HEX HD. (2)

3/8-16UNC x 1.00 LG (2)

C08348 WASHER, LOCK

3/8 (8) REQ'D

C11980 SCR, PAN HD, TYPE A
#10 x 3.00 LG (4) REQ'D

C08423 SCR, PAN HD, PHIL, SEMS
#10-32UNC x .50 LG (9) REQ'D

Y-BASE ASSY

Y-BASEASSY058-800-A100-A

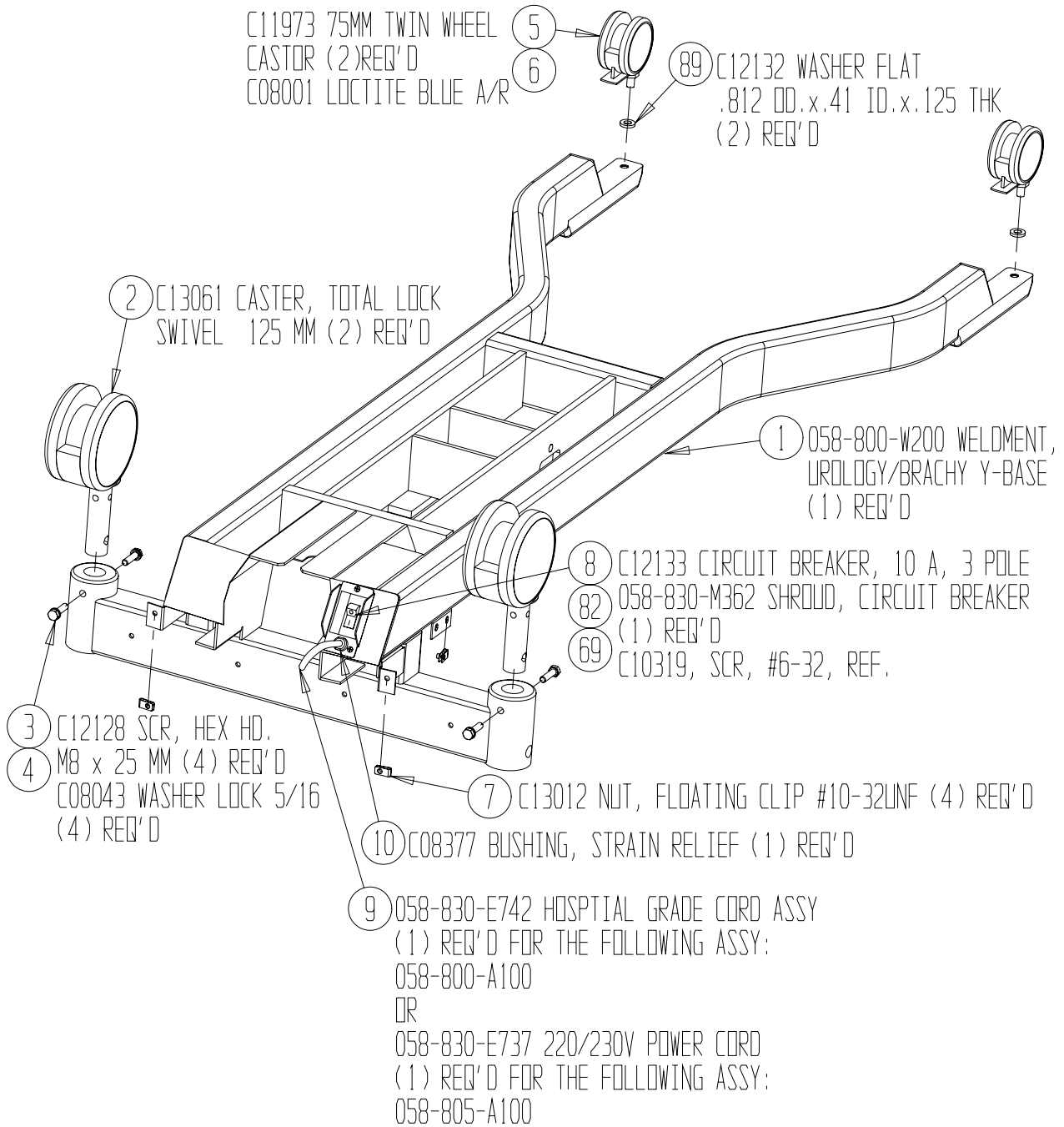

CONTROL BOX ASS'Y

CNTRLBOXASS'Y058-830-A120-F

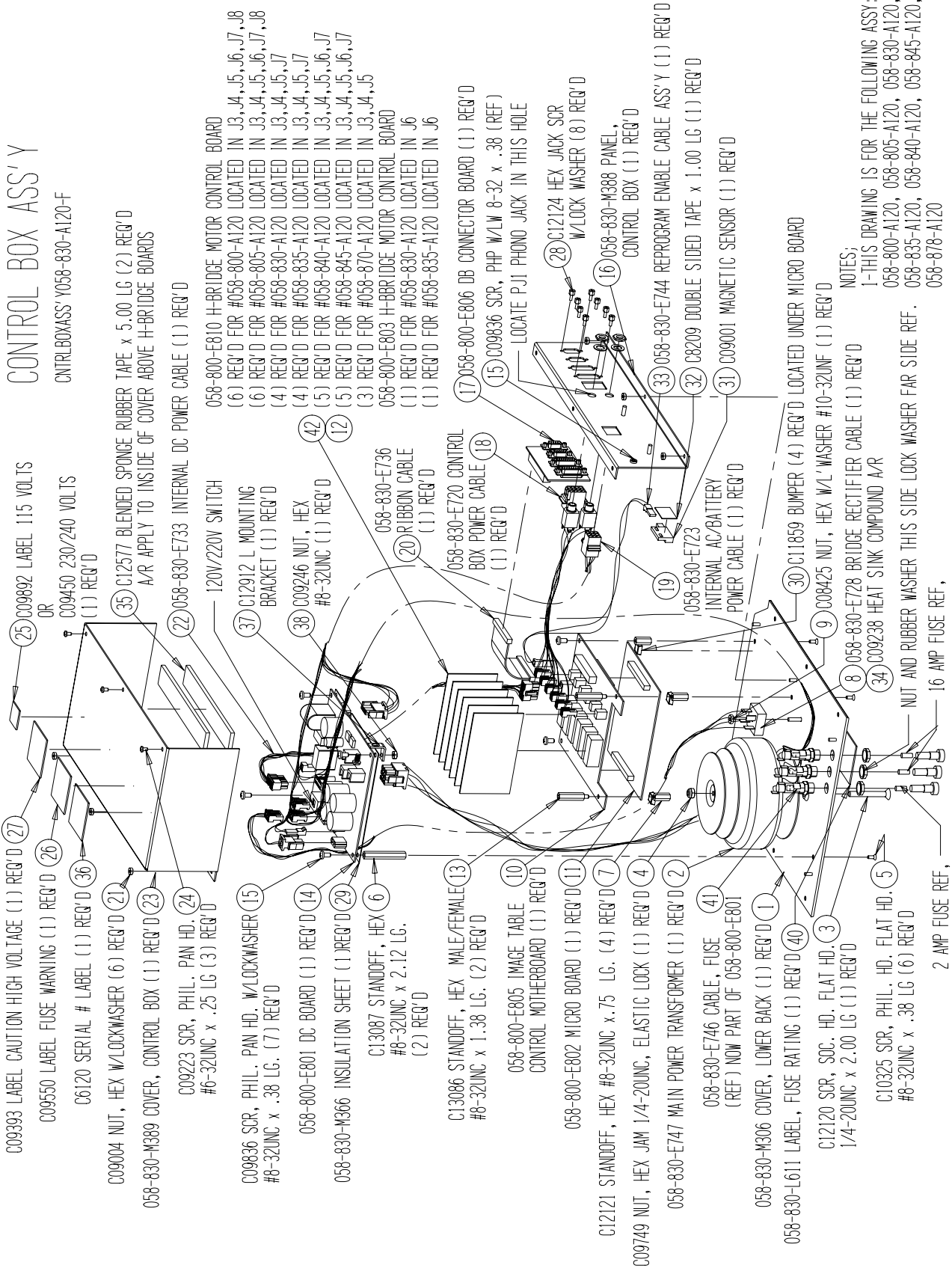

C09393 LABEL CAUTION HIGH VOLTAGE (1) REQ'D (27)
 C09550 LABEL FUSE WARNING (1) REQ'D (26)
 C6120 SERIAL # LABEL (1) REQ'D (36)
 C09004 NUT, HEX W/LOCKWASHER (6) REQ'D (21)
 058-830-M389 COVER, CONTROL BOX (1) REQ'D (23)
 C09223 SCR, PHIL. PAN HD. (24)
 #6-32UNC x .25 LG (3) REQ'D

OR
 C09450 230/240 VOLTS
 (1) REQ'D

C12577 BLENDED SPONGE RUBBER TAPE x 5.00 LG (2) REQ'D
 A/R APPLY TO INSIDE OF COVER ABOVE H-BRIDGE BOARDS
 058-830-E733 INTERNAL DC POWER CABLE (1) REQ'D
 120V/220V SWITCH

C12912 L MOUNTING BRACKET (1) REQ'D
 C09246 NUT, HEX #8-32UNC (1) REQ'D
 058-830-E736 RIBBON CABLE (1) REQ'D
 058-830-E720 CONTROL BOX POWER CABLE (1) REQ'D

C13087 STANDOFF, HEX #8-32UNC x 2.12 LG. (2) REQ'D
 C13086 STANDOFF, HEX MALE/FEMALE #8-32UNC x 1.38 LG. (2) REQ'D

058-800-E801 DC BOARD (1) REQ'D (14)
 058-830-M366 INSULATION SHEET (1) REQ'D (29)
 C13087 STANDOFF, HEX #8-32UNC x 2.12 LG. (2) REQ'D
 C13086 STANDOFF, HEX MALE/FEMALE #8-32UNC x 1.38 LG. (2) REQ'D

058-800-E805 IMAGE TABLE CONTROL MOTHERBOARD (1) REQ'D (10)
 058-800-E802 MICRO BOARD (1) REQ'D (11)
 C12121 STANDOFF, HEX #8-32UNC x .75 LG. (4) REQ'D (7)
 C09749 NUT, HEX JAM 1/4-20UNC, ELASTIC LOCK (1) REQ'D (4)
 058-830-E747 MAIN POWER TRANSFORMER (1) REQ'D (2)

058-830-E746 CABLE, FUSE (41)
 (REF) NOW PART OF 058-800-E801
 058-830-M306 COVER, LOWER BACK (1) REQ'D (1)
 058-830-L611 LABEL, FUSE RATING (1) REQ'D (40)
 C12120 SCR, SOC. HD. FLAT HD. (3)
 1/4-20UNC x 2.00 LG (1) REQ'D

C10325 SCR, PHIL. HD. FLAT HD. #8-32UNC x .38 LG (6) REQ'D
 2 AMP FUSE REF.
 NUT AND RUBBER WASHER THIS SIDE LOCK WASHER FAR SIDE REF.
 C09238 HEAT SINK COMPOUND A/R
 058-830-E728 BRIDGE RECTIFIER CABLE (1) REQ'D
 C09825 NUT, HEX W/L WASHER #10-32UNC (1) REQ'D
 C11859 BUMPER (4) REQ'D LOCATED UNDER MICRO BOARD

058-830-E723 INTERNAL AC/BATTERY POWER CABLE (1) REQ'D (19)
 058-830-E744 REPROGRAM EMABLE CABLE ASS'Y (1) REQ'D (33)
 C8209 DOUBLE SIDED TAPE x 1.00 LG (1) REQ'D (32)
 C09001 MAGNETIC SENSOR (1) REQ'D (31)

058-830-M388 PANEL, CONTROL BOX (1) REQ'D (16)
 C12124 HEX JACK SCR W/LOCK WASHER (8) REQ'D (28)
 LOCATE P/J PHONO JACK IN THIS HOLE
 C09836 SCR, PHP W/LW 8-32 x .38 (REF) (15)
 058-800-E806 DB CONNECTOR BOARD (1) REQ'D (17)

058-800-E810 H-BRIDGE MOTOR CONTROL BOARD (6) REQ'D FOR #058-800-A120 LOCATED IN J3, J4, J5, J6, J7, J8
 (6) REQ'D FOR #058-805-A120 LOCATED IN J3, J4, J5, J6, J7, J8
 (4) REQ'D FOR #058-830-A120 LOCATED IN J3, J4, J5, J7
 (4) REQ'D FOR #058-835-A120 LOCATED IN J3, J4, J5, J7
 (5) REQ'D FOR #058-840-A120 LOCATED IN J3, J4, J5, J6, J7
 (5) REQ'D FOR #058-845-A120 LOCATED IN J3, J4, J5, J6, J7
 (3) REQ'D FOR #058-870-A120 LOCATED IN J3, J4, J5
 058-800-E803 H-BRIDGE MOTOR CONTROL BOARD (1) REQ'D FOR #058-830-A120 LOCATED IN J6
 (1) REQ'D FOR #058-835-A120 LOCATED IN J6

058-830-E733 INTERNAL DC POWER CABLE (1) REQ'D
 120V/220V SWITCH
 C12912 L MOUNTING BRACKET (1) REQ'D
 C09246 NUT, HEX #8-32UNC (1) REQ'D
 058-830-E736 RIBBON CABLE (1) REQ'D
 058-830-E720 CONTROL BOX POWER CABLE (1) REQ'D

C13087 STANDOFF, HEX #8-32UNC x 2.12 LG. (2) REQ'D
 C13086 STANDOFF, HEX MALE/FEMALE #8-32UNC x 1.38 LG. (2) REQ'D

058-800-E805 IMAGE TABLE CONTROL MOTHERBOARD (1) REQ'D (10)
 058-800-E802 MICRO BOARD (1) REQ'D (11)
 C12121 STANDOFF, HEX #8-32UNC x .75 LG. (4) REQ'D (7)
 C09749 NUT, HEX JAM 1/4-20UNC, ELASTIC LOCK (1) REQ'D (4)
 058-830-E747 MAIN POWER TRANSFORMER (1) REQ'D (2)

058-830-E746 CABLE, FUSE (41)
 (REF) NOW PART OF 058-800-E801
 058-830-M306 COVER, LOWER BACK (1) REQ'D (1)
 058-830-L611 LABEL, FUSE RATING (1) REQ'D (40)
 C12120 SCR, SOC. HD. FLAT HD. (3)
 1/4-20UNC x 2.00 LG (1) REQ'D

C10325 SCR, PHIL. HD. FLAT HD. #8-32UNC x .38 LG (6) REQ'D
 2 AMP FUSE REF.
 NUT AND RUBBER WASHER THIS SIDE LOCK WASHER FAR SIDE REF.
 C09238 HEAT SINK COMPOUND A/R
 058-830-E728 BRIDGE RECTIFIER CABLE (1) REQ'D
 C09825 NUT, HEX W/L WASHER #10-32UNC (1) REQ'D
 C11859 BUMPER (4) REQ'D LOCATED UNDER MICRO BOARD

NOTES:
 1-THESE DRAWING IS FOR THE FOLLOWING ASSY:
 058-800-A120, 058-805-A120, 058-830-A120,
 058-835-A120, 058-840-A120, 058-845-A120,
 058-878-A120

VIEWABLE LEG EXTENSION ASSY

VIEWABLELEGEXTASSY058-820-A080-

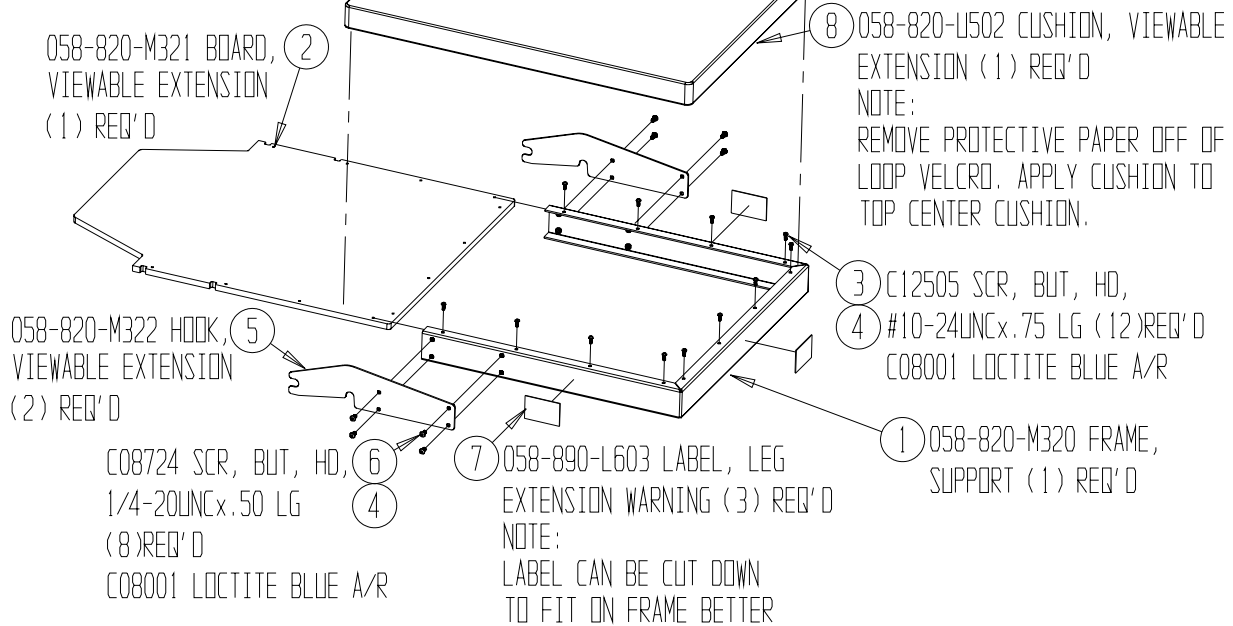

NON-VIEWABLE EXTENSION ASSY

NON-VIEWABLEEXTASSY058-820-A060-A

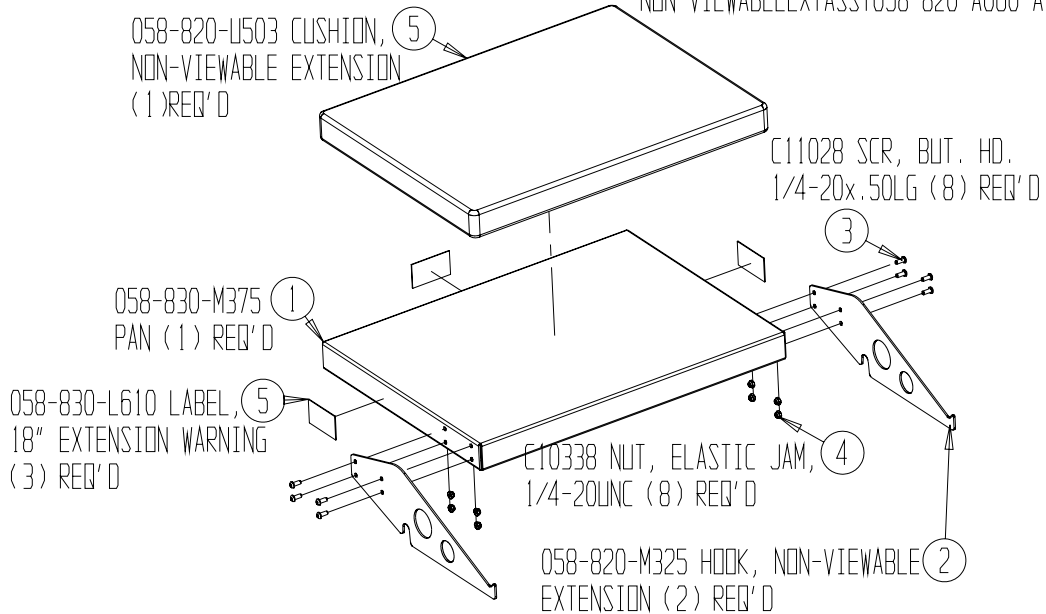

BIODEX

Biodex Medical Systems, Inc.