

# SURGICAL C-ARM TABLE

---

## INSTALLATION/ OPERATION MANUAL

058-840

058-845



# BIODEX

Biomed Medical Systems, Inc.



# SURGICAL C-ARM TABLE

---



















**This manual covers installation and operation procedures for the following products:**

- #058-840      Table, Surgical C-Arm - 840, 115 VAC
- #058-845      Table, Surgical C-Arm - 840, 230 VAC

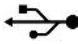

## DEFINITION OF SYMBOLS

*The following symbols and their associated definitions are used and implied throughout this manual.*

Symbol	Definition
	Carefully read these instructions prior to use
	Caution
	General Warning
	General Mandatory Action
	Dangerous Voltage
	“On” Power
	“Off” Power
	Earth (ground)
	Alternating Current
	Fuse
	USB Connector/Cable
	Waste in Electrical Equipment
	Date of Manufacture
	Type B Applied Part
	CE Mark
	CE Mark for products with EC Certificate
	Certified for Safety by ETL Intertek



# SURGICAL C-ARM TABLE

## INTRODUCTION

The Surgical C-Arm Table 840 is designed for image-guided procedures where stability, access, and precise, quiet, vibration-free positioning are essential. A cantilevered low attenuation carbon fiber tabletop, with choice of contoured or rectangular design, accommodates portable or ceiling-suspended C-Arms. The contoured top provides ample workspace for anesthesiologists, yet the narrowness required for cervical procedures. The NEW rectangular top offers additional space to allow for superior image quality for long-leg runoff studies. Choose the top that best suits your needs to achieve optimum image resolution.

The extra-large radiolucent area, free-float X-Y tabletop, motorized control of height, lateral roll, Trendelenburg motions and the catheter tray extension make the Surgical C-Arm Table - 840 ideal for cardiovascular procedures. The radiolucent area is free of cross members, allowing full fluoroscopic visualization and unobstructed C-Arm positioning. Functional design provides complete access with reduced radiation exposure to clinicians. Patient comfort and stability are assured by two-inch thick table padding and three adjustable straps with hook and loop fastening. The contoured tabletop features a face cutout for prone positioning.

## Control Made Easy

The portable hand-held and foot operated controllers ensure quick and safe tabletop positioning, and can be positioned from any point around the table. Both controllers offer the freedom to adjust height, lateral roll and Trendelenburg motions. The hand-held controller provides the back to level function. The foot-operated controller also releases the tabletop for X-Y positioning and is ideal when hands are busy with other functions.

## Free-Float Feature

A push-button release for the free-float feature is located at the end of a handgrip. When employing any degree of tilt or roll, X and Y positions are "locked" to prevent gravity induced X or Y motion. Selective "lockout" of X or Y movement is also provided: head-to-toe (X) float can be maintained during lateral roll; side-to-side (Y) float can be maintained during Trendelenburg positioning.

Both AC and battery power are standard. When operating on battery, there are no power cords to catch on feet or block table wheels. Battery charging can be accomplished during off hours by plugging in the AC power cord. An optional battery with separate charging unit can provide continuous cordless operation.

 **IMPORTANT NOTE:** Remove battery if storing table for prolonged time.

 **IMPORTANT NOTE:** Lever le batterie si le table se garder en reserve por temps prolongement.

**NOTE:** The 840 tabletop is made of carbon fiber. This material, as used in this product, is certified to meet all the requirements of radiation performance standards of 21 CFR Subchapter J.



Figure 1. Parts and adjustment mechanisms.

1. Hand-Held Controller
2. Foot Controller
3. Free-Float X-Y Tabletop Release Button
4. Foot End Locking Brakes and Swivel Casters
5. Battery Pack
6. Front End Caster Brake Locking Bar

## OPERATING INSTRUCTIONS

 **CAUTION:** Refer to instruction manual before operating or servicing system.

 **ATTENTION:** Se référer à la notice d'utilisation avant d'utiliser l'équipement.

**NOTE:** This table can be operated with the power cord connected to an outlet or by using the battery. The battery recharges automatically while the table is plugged into an outlet even if the table is being used.

**NOTA:** Cette table fonctionne avec le cordon d'alimentation branché sur une prise ou à l'aide de la batterie. La batterie se recharge automatiquement lorsque le cordon est branché sur une prise, même si la table est en cours d'utilisation.

 **CAUTION:** Hospital grade plug to be plugged into a hospital grade receptacle only to achieve grounding reliability.

 **ATTENTION:** La fiche de qualité hôpital ne doit être branchée que sur une prise de courant de qualité hôpital, pour une mise à la terre fiable.

 **CAUTION:** Before transferring a patient onto or off the table, ensure all four caster brakes are locked. Secure the restraining straps immediately after positioning the patient on the table.

 **ATTENTION:** Avant le transfert du patient sur la table ou hors de la table, s'assurer que les quatre freins des roulettes sont bloqués. Fixer les lanières d'immobilisation dès qu'on a positionné le patient sur la table.

 **CAUTION:** The restraining straps are not intended to restrain an uncontrolled patient.

 **ATTENTION:** Les lanières d'immobilisation n'ont pas pour objet l'immobilisation d'un patient hors de contrôle.



## The Locking Brakes and Swivel Casters

(See Figure 2.)

The locking brakes and swivel casters allow this table to glide effortlessly on hard surfaces and across firm rugs. The foot end casters are locked from either side of the table while the head end casters are locked together using the Caster Brake Locking Bar.

1. To release the lock on the brakes and swivel casters at the foot end of the table, use your toe to lift up on the foot end caster brake locking lever on either side of the table.
2. To lock the foot end brakes and swivel casters, step down on the foot end caster brake locking lever on either side of the table.
3. To lock the brakes and swivel casters for the head end of the table, use your toe to press down on the head end caster brake locking bar.
4. To release the head end brake and swivel casters, use your toe to lift up on the head end caster brake locking bar.

**NOTE:** The head end caster brake locking bar, when pressed down in the lock position, raises the head end casters slightly off the ground. The amount that casters are raised can be adjusted by simply using a 5/8" open-end wrench to adjust up or down the support foot located under the head end caster brake locking bar.

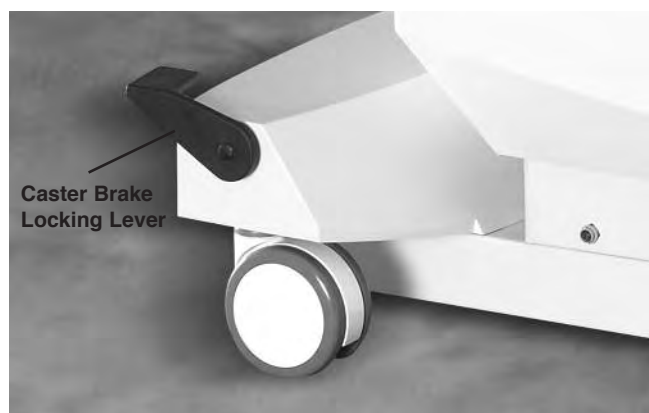

Figure 2. Locking brakes and swivel casters.

## Using the Hand-Held Controller

The hand-held controller may be used to adjust table height, Trendelenburg/Reverse Trendelenburg, lateral roll and X-Y positioning. When not in use, the Hand-Held Controller can be hooked onto the metal loop on the restraining strap, or on the accessory rail.



**CAUTION:** Before moving the tabletop, be sure that all I.V. lines, attachments and restraining straps, etc., are out of the way. Ensure the patient is fully secured to the tabletop by the restraining straps.



**ATTENTION:** Avant tout déplacement du dossier, veiller à en dégager les lignes de goutte-à-goutte intravéneux, les accessoires, les lanières d'immobilisation, etc. S'assurer que le patient est solidement fixé au dossier à l'aide des lanières d'immobilisation.

To adjust the table position, press and hold the appropriate switch on the hand-held controller. The tabletop will move or rotate in the direction indicated by the switch. Release the switch when the tabletop achieves the desired position.

## Motorized Note for Hand-Held and Foot Controllers

**NOTE:** The table can perform only one motorized function (i.e. raising or lowering the tabletop, lateral roll, X-Y movement, Trendelenburg/Reverse Trendelenburg) at a time. If you press a second button on the Hand-Held Controller (or the Foot Controller) while the table is already performing a motorized function the tabletop movement will stop. At that point, you will need to release all buttons before you can resume the selected function.

**NOTA:** La table ne peut exécuter qu'un seul déplacement motorisé à la fois (p. ex.: élévation ou abaissement du dossier, rotation à gauche ou à droite sur l'axe longitudinal, déplacement le long des axes X et Y, position de Trendelenburg / position de Trendelenburg inversée). Le fait d'appuyer sur un second bouton de la commande à main (ou sur une seconde pédale) en cours de déplacement de l'appareil provoque l'arrêt du mouvement du dossier. Il faut alors relâcher tous les boutons avant de reprendre la fonction choisie.

## Using the Foot Controller

The Foot Controller activates all motions. The four separate rocker style pedals control two movements each. From left to right on the Foot Control, press and hold down the appropriate rocker switch to adjust Trendelenburg/Reverse Trendelenburg positioning, lateral roll, tabletop height, and X-Y motion. Releasing the rocker switch at any time immediately stops the motion.

**NOTE:** When the table is used in a wet environment, it is recommended that the Foot Controller be covered with a plastic bag and sealed as watertight as possible.



### Positioning The X-Y Free-Float Tabletop

(See Figure 3.)

The X-Y free-float tabletop is positioned using the black tabletop handgrips. The handgrip has a push button that, when depressed, allows the table to move in both the X and Y planes. To move the tabletop, depress the push button on the handgrip and, using both handgrips, slide the tabletop to the desired position. Release the button to lock the tabletop in place.

The tabletop handgrips may be positioned at any point along the accessory rail. You can position the grips in either a horizontal or vertical plane. To position the grips, loosen the handgrip locking knob, slide the grip to the desired position along the accessory rail, then tighten the locking knob to secure the grip.

**NOTE:** The X-Y Free-Float Tabletop Release Button will not allow the tabletop to “float” if the table is tilted with lateral roll.



Figure 3. Push button (on handle) releases tabletop for free-float X-Y motion.

### Disposable Skirt

(See Figure 4.)

The Biodex Surgical C-Arm Table comes supplied with Plastic Sanitary Skirts to protect the table bellows from patient blood, liquids, etc. The table is encircled by a magnetic-backed rubber strip, located immediately above the bellows. Secure the skirt to the bellows as described.

1. Lift the lower section of the strip on each side of the table.
2. Slide the plastic skirt underneath the strip at the foot end of the table, then lower the strip to hold the skirt in place.
3. Work around the table, tucking the top edge of the plastic skirt under each strip and lowering the strip to secure the plastic until the bellows are completely unwrapped. Be sure to overlap the skirt across the entire length of the table's foot end.
4. Remove and replace the plastic skirt for each new patient.

**NOTE:** Additional Bellows Skirts (part #056-802) can be ordered from Biodex Medical Systems, Inc.



Figure 4. Lift the lower section of the strip on each side of the table, slide the plastic skirt underneath and lower the strip to hold the skirt in place.

### Catheter Tray Extension

(See Figure 5.)

The removable extension can be used to provide additional table length for accommodation of catheters within the patient's sterile field. This makes the procedure easier, safer and reduces the risk of breaking the sterility of the catheters.



**CAUTION:** The Catheter Extension is not radiolucent and not suitable for patient support.



**ATTENTION:** L'extension du Cathéter n'est pas radiotransparent et ne pas convenable por supporte an patient.

To attach the Catheter Tray Extension, simply hook the Extension guides over the accessory rails at the foot end of the table and lower the extension into position.

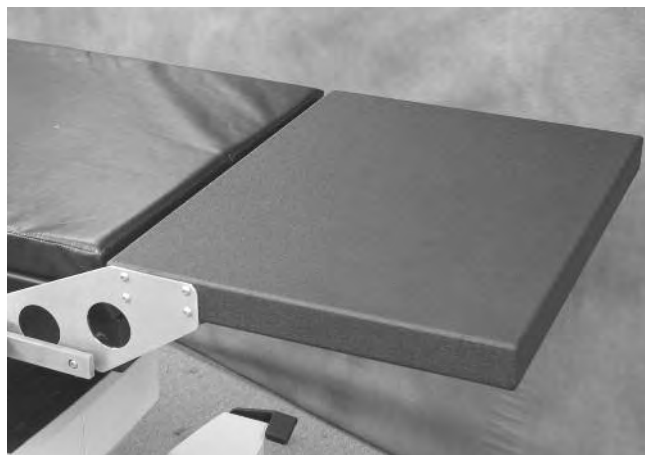

Figure 5. Catheter Extension.



### I.V. Pole (Optional)

The adjustable height I.V. pole should be installed onto the O.R. accessory rail. Loosen the I.V. pole locking knob at the base of the slide block and slide the block and pole onto the accessory rail until it is in the desired position. Tighten the locking knob to secure the pole.

To adjust the height of the I.V. pole, loosen the height adjustment locking knob and raise or lower the top section of the pole to the appropriate height. Tighten the locking knob to secure.

### Charging The Battery

This table can be operated with the power cord connected to an outlet or by using the battery. The battery recharges automatically while the table is plugged into an outlet even if the table is being used. An optional wall-mounted battery charger is also available.

**NOTE:** The table must remain plugged into an outlet when the battery is removed or reinstalled. If you remove the battery for any reason while the table is not plugged into a working outlet, the battery will discharge at a faster rate. Once the battery has been reinstalled, and you have verified that the table is operating, you may remove the power cord plug from the outlet and operate on battery power.



### SAFETY GUIDELINES

1. Secure restraining straps immediately after placing the patient on the table. The restraining straps prevent the patient from rolling off the side of the table.

**NOTE:** The restraining straps are not intended to restrain an uncontrolled patient.

2. Always lock the casters before moving a patient onto or off the table.
3. This table is rated to support patients weighing up to a maximum of 500 pounds.



### CONSIGNES DE SECURITE

1. Fixer les lanières d'immobilisation et les lanières de cheville immédiatement après avoir placé le patient sur la table. Les lanières de cheville empêchent le patient de glisser sous la table en position de Trendelenburg. Les lanières d'immobilisation empêchent le patient de rouler par-dessus le côté de la table.

**NOTA:** Les lanières d'immobilisation n'ont pas pour objet l'immobilisation d'un patient hors de contrôle.

2. Toujours bloquer les roulettes avant de faire monter le patient sur la table ou de le faire descendre.
3. La table est certifiée comme pouvant supporter un patient pesant au plus 227 kg (500 lb).

### MAINTENANCE AND CLEANING

The Biodex Surgical C-Arm Table is virtually maintenance free. By following the instructions below at suggested time intervals, or as often as necessary, your table will remain in "like new" condition.

1. As required, clean all exterior painted surfaces, tabletop and restraining straps with a mild detergent solution.
2. Wheels and wheel locks should remain free of foreign materials and dirt accumulation. Keeping wheel assemblies free of this matter will ensure smooth table transportation and free lock/unlock wheel operation.



**CAUTION:** Disconnect power from source before removing panel or covers. Reliable grounding achieved only by connecting this unit to an equivalent marked hospital only or hospital grade receptacle.



**ATTENTION:** Déconnecter la prise secteur avant d'ouvrir le coffret. Une terre fiable ne peut être obtenue que par la connexion à une prise secteur de qualité hospitalière.



## SPECIFICATIONS

**Dimensions:** 104" l x 26" w (260 x 66 cm) with OR accessory rails

**Tabletop:** 101" l x 24" w (252 x 61 cm)

**Catheter Tray Extension (removable):** 18" l x 24" w (45.7 x 61 cm) non-radiolucent

### Radiolucent Area:

51" l x 24" w (128 x 61 cm) unobstructed head to accessory rail

20" l x 17.5" w (50.8 x 44 cm) additional, between accessory rails

**Radiolucent Area, Total Length:** 71" l (178 cm)

**Tabletop Material:** Carbon fiber with integral head section

**Mattress:** Seamless, 2" thick (5 cm)

### Attenuation:

**Tabletop:** .7 mm Aluminum equivalence

**Mattress:** .5 mm Aluminum equivalence

### Motions:

**Height Adjustable:** 33.5" to 43.5" (84 to 109 cm)

**Tabletop X Motion (head-to-toe float):** 20" (51 cm)

**Tabletop Y Motion (side-to-side float):** 10" (25.4 cm)

**Trendelenburg:** 0° to 20°

**Reverse Trendelenburg:** 0° to 20°

**Lateral Roll:** 0° to 20°

### Controls:

**Hand Control:** height, lateral roll and Trendelenburg motions

**Foot Control:** activates all motions (has release for float)

**Push Button:** releases X-Y Tabletop motions

### Wheels:

Head End – 3" (7.62 cm) swivel casters, integral locking system on base

Foot End – 5" (12.7 cm) swivel casters with central locking

**Accessory Rails:** Standard OR accessory rails 49.5" x 1.12" x .375" (124 x 2.86 x .95 cm) mounted near foot end of table

**Patient Restraints:** Three body straps

**Finish:** Powder coat

**Patient Capacity:** 500 lb (227 kg); weight tested to four times the patient load rating.

**Lift Capacity:** May vary between 460 lb - 500 lb (209 - 227 kg) based on line voltage

**Power:** 115 VAC or 230 VAC and Battery. Battery automatically charges when table is plugged in. An additional battery can be charged with optional wall-mounted charger.

### Standard Accessory:

- Catheter Tray Extension (removable)
- Bellows Skirt (disposable, 250/roll) and dispenser

**Warranty:** Two years

**Certifications:** ETL and cETL Listed to UL-60601-1®, CAN/CSA® C22.2 No.: 601-1-M90, EN 60601-1 and IEC 60601-1-2, CE MARKED

## OPTIONAL

056-862 Battery and Charging Unit, 115 VAC

056-863 Battery and Charging Unit, 230 VAC

056-850 IV Pole, Rail Mounted

056-865 Arm Board, Carbon Fiber, one arm

056-866 Arm Board, Carbon Fiber, two arms

058-864 Arm Board, Surgical, Carbon Fiber

058-849 Clamp, Accessory, C-Arm Table

058-856 Radiation Shield, Head/Cervical

058-857 Radiation Shield, Thoracic/AB

## REPLACEMENT

056-802 Bellows Skirt, disposable plastic, 250/roll  
*Fits Surgical C-Arm Tables 840, 800,  
810 and 820*

Authorized European Community Representative:



Emergo Europe  
Molenstraat 15  
2513 BH, The Hague  
The Netherlands



TYPE B EQUIPMENT



# **ELECTROMAGNETIC COMPATABILITY CHART**

<b>Standard</b>	<b>Test Method</b>	<b>RangeLimits</b>	<b>Limits</b>	<b>Result</b>
IEC 61000-3-2	Harmonics	100 Hz to 2KHz	Class A	THD=48.82%
IEC 61000-3-3	Flicker	observation time (TP) 10 min	-	-
		max voltage change (dmax)	4%	2.37%
		max Rel steady state voltage change (dc)	3%	0.00%
		duration of d(t)>3%(t)	.2 sec	0.00 sec
		short term flicker Sev (PST)	1.00	0.23
		long term flicker Sev (PLT)	.65	0.23
IEC 61000-4-2	Electrostatic Discharge	Contact: 2, 4 & 6Kv pos/neg 1pps /10 sec Air: 2, 4, & 8Kv pos/neg 1pps / 10 sec	no degradation of performance	complied
IEC 61000-4-3	Radiated Immunity	80 MHz to 1000 MHz / 3v/m Horiz & Vertical @ 2M 1000 MHz to 2500 MHz / 3v/m Horiz & Vertical @ 1M	no degradation of performance	complied
IEC 61000-4-4	Electrical Fast Transient/ Burst, Power Leads	PWR Input leads .5, 1, & 2 Kv / pos & neg / 5KHz Rep Rate	no degradation of performance	complied
IEC 61000-4-6	Conducted Immunity, Power Leads	150 KHz to 80 MHz /3Vrms	no degradation of performance	complied
IEC 61000-4-8	Magnetic Immunity	3A/M RMS @ 50/60 Hz	no degradation of performance	complied
IEC 61000-4-11	Voltage Dips and Interrupts	<b>Int Duration</b> Int 20msecpause 10 sec Int 100msecpause 10 sec Int 500msecpause 10 sec Int 5000msecpause 10 sec	<b>% reduction</b> no degradation of performance no degradation of performance no degradation of performance no degradation of performance	complied complied complied complied complied
CISPR 11	Conducted Emissions	150 KHz - 500 KHz, .5MHZ – 5MHZ,5 MHz - 30 MHz, Class B, Group 1	66/56/60 dbuV QP 56/46/50 dbuV AV	complied
CISPR 11	Radiated Emissions	30 MHz – 230 MHz / 230MHz - 1GHz, Class B, Group 1	30/37 dbuVm @ 10 m	complied
IEC 61000-4-5	Surge Immunity, Power Leads	2 Kv common mode / 1 Kv, differentia 1ppm, pos/neg	no degradation of performance	complied



54 C12149 SCR, PAN HO., PHIL SEMS #8-32UNC x .25 LG (1) RED O









# C-ARM ASSY

12 C09008 CABLE TIE MNTG.  
13 C08419 CABLE TIE  
(3) REQ'D FOR #058-830-A000, #058-835-A000  
(5) REQ'D FOR #058-840-A000, #058-845-A000

11 C10367 RETAINING CLAMP .25 DIA.  
(1) REQ'D  
10 C09405 SCR, PAN HD, PHIL  
#6-32UNC x .50 LG (12) REQ'D

9 C12175 SCR, PAN HD, PHIL  
#6-32UNC x .25 LG (4) REQ'D  
C08001 REF.

25 C12175 SCR, PAN HD, PHIL  
#6-32UNC x .25 LG (4) REQ'D  
C08001 REF.

20 058-830-M318 STRIP, FRONT BELLOW (1) REQ'D  
17 058-830-M319 STRIP, BELLOWS SIDE (2) REQ'D

18 C10326 SCR, PAN HD, PHIL  
#10-32UNC x .50 LG (4) REQ'D  
C08001 LOCITITE BLUE A/R REQ'D

7 945-250-M254 LIFT PIVOT BOLT  
(2) REQ'D FOR #058-830-A000, #058-835-A000  
(4) REQ'D FOR #058-940-A000, #058-945-A000  
C09719 WASHER, LOCK, 5/16 (2) REQ'D

8 058-830-M317 STRIP, BACK (1) REQ'D  
C08001 REF.

2 055-800-W190 PIVOT TUBE  
PIN WELDMENT (1) REQ'D  
C08116 GREASE, WHITE LITHIUM A/R

3 C08116 GREASE, WHITE LITHIUM A/R

4 C08389 SCR, HEX HD  
3/8-16UNC x 1.00 LG  
C08348 WASHER, LOCK 3/8 (12) REQ'D

15 058-830-P453 COVER, RIGHT SIDE (1) REQ'D  
058-830-M346 COVER, BACK (23) REQ'D  
C11889 REF. (22)  
C08001 REF. (19)

14 058-830-P452 COVER, LEFT SIDE (1) REQ'D

16 058-830-M348 BRKT., INNER CONNECTING (1) REQ'D

1 058-830-A100 I-BASE ASSY OR  
058-835-A100 I-BASE ASSY (220V) (1) REQ'D

93 058-830-M354 BRKT., INNER FRONT CONNECTING (1) REQ'D  
82 058-830-M349 BRKT., OUTER CONNECTING (2) REQ'D  
83 C12199 EXTRUDE 'U' NUT #8-32 (14) REQ'D

24 058-830-M347 COVER, FRONT HARDWARE (1) REQ'D

6 058-830-A010 BASE TOP ASSY (1) REQ'D

ADJUST WHEELS TO TOUCH BOTTOM OF RAIL

ADJUST WHEELS TO TOUCH TOP OF RAIL



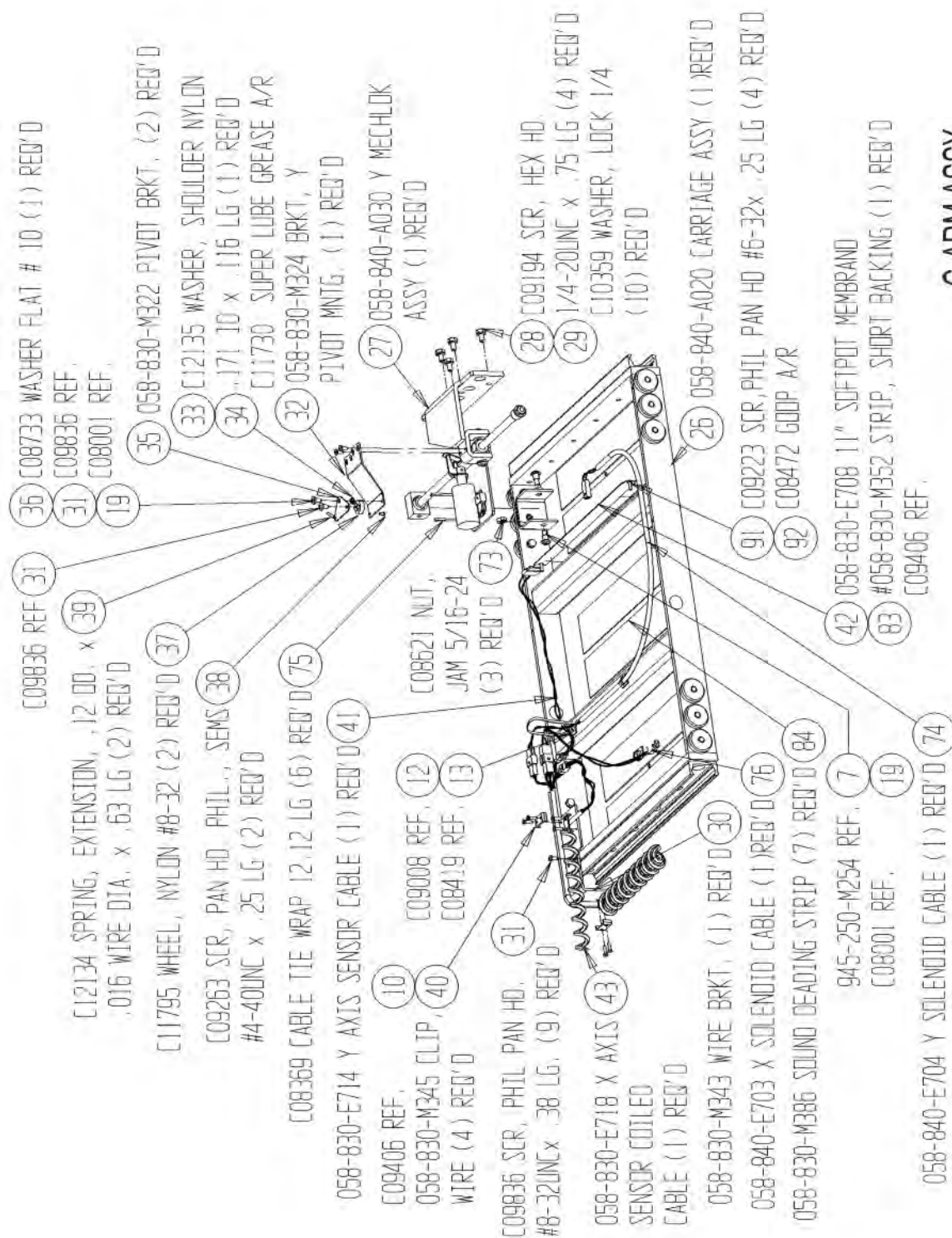

## C-ARM ASSY

ONLY USED ON THE 058-840-A000 ASSY



[12532 FERRITE SNAP ON (1) REQ'D (102)  
 058-830-E710 MAIN SENSOR COILED CABLE (1) REQ'D (67)  
 058-830-E713 MAIN POWER COILED CABLE (1) REQ'D (66)  
 [09406 SCR, PAN HD, PHIL #6-32UNC x .50 LG (4) REQ'D (81)  
 [10367 RETAINING CLAMP .25 DIA. (1) REQ'D (80)  
 [12140 RETAINING CLAMP .375 DIA. (1) REQ'D (79)  
 [10829 CABLE CLAMP LOOP (2) REQ'D (82)  
 [10301 FERRITE, SPLIT W/PLASTIC CASE (2) REQ'D (72)  
 [08369 CABLE TIE WRAP 12 LG (4) REQ'D (73)  
 058-830-E725 HAND PENDANT/FOOT SWITCH CABLE (1) REQ'D (69)  
 058-840-M312 SINGLE D-CONNECTOR (77)  
 MNTG BLOCK (2) REQ'D (78)  
 [10312 SCR, PAN HD, PHIL #10-32UNC x .44 LG (4) REQ'D (20)  
 [08001 LOCTITE BLUE (78)  
 [10321, VERTICAL ACTUATOR (10321)  
 058-830-E724, INTERNAL PENDANT PWR/COMM CABLE (10321)  
 058-830-E710, MAIN SENSOR COILED CABLE (10321)  
 058-830-E725, HAND PENDANT/FOOT SWITCH CABLE (10321)  
 058-830-E713, MAIN POWER COILED CABLE (10321)  
 058-800-M337, TRENDLENBURG ACTUATOR (10321)  
 [10327 BATTERY, 24 VOL 4.5 AMP/HR (1) REQ'D (95)  
 058-830-E722, EXTERNAL AC/BATT PWR CABLE (10327)  
 [12136 CABLE CLAMP LOOP (2) REQ'D (70)  
 [08425 NUT, HEX, KEPS #10-32UNC (2) REQ'D (71)  
 [10119 SCR, PAN HD, PHIL #4-40UNC x .63 LG (4) REQ'D (84)  
 058-830-E724, INTERNAL PENDANT PWR/COMM CABLE (1) REQ'D (68)  
 [09247 NUT, HEX KEPS, #4-40 (4) REQ'D (85)  
 [12197 BROAD BAND SPLIT FERRITE (1) REQ'D (97)  
 NOTE: LOCATE FERRITE ON #058-830-E713 MAIN POWER COILED CABLE AS CLOSE TO CONNECTOR AS POSSIBLE  
 058-830-E710 MAIN SENSOR COILED CABLE (1) REQ'D (67)  
 058-830-E713 MAIN POWER COILED CABLE (1) REQ'D (66)  
 058-830-E725 HAND PENDANT/FOOT SWITCH CABLE (1) REQ'D (69)  
 058-840-M312 SINGLE D-CONNECTOR (77)  
 MNTG BLOCK (2) REQ'D (78)  
 [10312 SCR, PAN HD, PHIL #10-32UNC x .44 LG (4) REQ'D (20)  
 [08001 LOCTITE BLUE (78)  
 [10321, VERTICAL ACTUATOR (10321)  
 058-830-E724, INTERNAL PENDANT PWR/COMM CABLE (10321)  
 058-830-E710, MAIN SENSOR COILED CABLE (10321)  
 058-830-E725, HAND PENDANT/FOOT SWITCH CABLE (10321)  
 058-830-E713, MAIN POWER COILED CABLE (10321)  
 058-800-M337, TRENDLENBURG ACTUATOR (10321)  
 [10327 BATTERY, 24 VOL 4.5 AMP/HR (1) REQ'D (95)  
 058-830-E722, EXTERNAL AC/BATT PWR CABLE (10327)  
 [12136 CABLE CLAMP LOOP (2) REQ'D (70)  
 [08425 NUT, HEX, KEPS #10-32UNC (2) REQ'D (71)  
 [10119 SCR, PAN HD, PHIL #4-40UNC x .63 LG (4) REQ'D (84)  
 058-830-E724, INTERNAL PENDANT PWR/COMM CABLE (1) REQ'D (68)  
 [09247 NUT, HEX KEPS, #4-40 (4) REQ'D (85)  
 [12197 BROAD BAND SPLIT FERRITE (1) REQ'D (97)  
 NOTE: LOCATE FERRITE ON #058-830-E713 MAIN POWER COILED CABLE AS CLOSE TO CONNECTOR AS POSSIBLE  
 058-830-E710 MAIN SENSOR COILED CABLE (1) REQ'D (67)  
 058-830-E713 MAIN POWER COILED CABLE (1) REQ'D (66)  
 058-830-E725 HAND PENDANT/FOOT SWITCH CABLE (1) REQ'D (69)  
 058-840-M312 SINGLE D-CONNECTOR (77)  
 MNTG BLOCK (2) REQ'D (78)  
 [10312 SCR, PAN HD, PHIL #10-32UNC x .44 LG (4) REQ'D (20)  
 [08001 LOCTITE BLUE (78)  
 [10321, VERTICAL ACTUATOR (10321)  
 058-830-E724, INTERNAL PENDANT PWR/COMM CABLE (10321)  
 058-830-E710, MAIN SENSOR COILED CABLE (10321)  
 058-830-E725, HAND PENDANT/FOOT SWITCH CABLE (10321)  
 058-830-E713, MAIN POWER COILED CABLE (10321)  
 058-800-M337, TRENDLENBURG ACTUATOR (10321)  
 [10327 BATTERY, 24 VOL 4.5 AMP/HR (1) REQ'D (95)  
 058-830-E722, EXTERNAL AC/BATT PWR CABLE (10327)  
 [12136 CABLE CLAMP LOOP (2) REQ'D (70)  
 [08425 NUT, HEX, KEPS #10-32UNC (2) REQ'D (71)  
 [10119 SCR, PAN HD, PHIL #4-40UNC x .63 LG (4) REQ'D (84)  
 058-830-E724, INTERNAL PENDANT PWR/COMM CABLE (1) REQ'D (68)  
 [09247 NUT, HEX KEPS, #4-40 (4) REQ'D (85)  
 [12197 BROAD BAND SPLIT FERRITE (1) REQ'D (97)  
 NOTE: LOCATE FERRITE ON #058-830-E713 MAIN POWER COILED CABLE AS CLOSE TO CONNECTOR AS POSSIBLE  
 058-830-E710 MAIN SENSOR COILED CABLE (1) REQ'D (67)  
 058-830-E713 MAIN POWER COILED CABLE (1) REQ'D (66)  
 058-830-E725 HAND PENDANT/FOOT SWITCH CABLE (1) REQ'D (69)  
 058-840-M312 SINGLE D-CONNECTOR (77)  
 MNTG BLOCK (2) REQ'D (78)  
 [10312 SCR, PAN HD, PHIL #10-32UNC x .44 LG (4) REQ'D (20)  
 [08001 LOCTITE BLUE (78)  
 [10321, VERTICAL ACTUATOR (10321)  
 058-830-E724, INTERNAL PENDANT PWR/COMM CABLE (10321)  
 058-830-E710, MAIN SENSOR COILED CABLE (10321)  
 058-830-E725, HAND PENDANT/FOOT SWITCH CABLE (10321)  
 058-830-E713, MAIN POWER COILED CABLE (10321)  
 058-800-M337, TRENDLENBURG ACTUATOR (10321)  
 [10327 BATTERY, 24 VOL 4.5 AMP/HR (1) REQ'D (95)  
 058-830-E722, EXTERNAL AC/BATT PWR CABLE (10327)  
 [12136 CABLE CLAMP LOOP (2) REQ'D (70)  
 [08425 NUT, HEX, KEPS #10-32UNC (2) REQ'D (71)  
 [10119 SCR, PAN HD, PHIL #4-40UNC x .63 LG (4) REQ'D (84)  
 058-830-E724, INTERNAL PENDANT PWR/COMM CABLE (1) REQ'D (68)  
 [09247 NUT, HEX KEPS, #4-40 (4) REQ'D (85)  
 [12197 BROAD BAND SPLIT FERRITE (1) REQ'D (97)  
 NOTE: LOCATE FERRITE ON #058-830-E713 MAIN POWER COILED CABLE AS CLOSE TO CONNECTOR AS POSSIBLE  
 058-830-E710 MAIN SENSOR COILED CABLE (1) REQ'D (67)  
 058-830-E713 MAIN POWER COILED CABLE (1) REQ'D (66)  
 058-830-E725 HAND PENDANT/FOOT SWITCH CABLE (1) REQ'D (69)  
 058-840-M312 SINGLE D-CONNECTOR (77)  
 MNTG BLOCK (2) REQ'D (78)  
 [10312 SCR, PAN HD, PHIL #10-32UNC x .44 LG (4) REQ'D (20)  
 [08001 LOCTITE BLUE (78)  
 [10321, VERTICAL ACTUATOR (10321)  
 058-830-E724, INTERNAL PENDANT PWR/COMM CABLE (10321)  
 058-830-E710, MAIN SENSOR COILED CABLE (10321)  
 058-830-E725, HAND PENDANT/FOOT SWITCH CABLE (10321)  
 058-830-E713, MAIN POWER COILED CABLE (10321)  
 058-800-M337, TRENDLENBURG ACTUATOR (10321)  
 [10327 BATTERY, 24 VOL 4.5 AMP/HR (1) REQ'D (95)  
 058-830-E722, EXTERNAL AC/BATT PWR CABLE (10327)  
 [12136 CABLE CLAMP LOOP (2) REQ'D (70)  
 [08425 NUT, HEX, KEPS #10-32UNC (2) REQ'D (71)  
 [10119 SCR, PAN HD, PHIL #4-40UNC x .63 LG (4) REQ'D (84)  
 058-830-E724, INTERNAL PENDANT PWR/COMM CABLE (1) REQ'D (68)  
 [09247 NUT, HEX KEPS, #4-40 (4) REQ'D (85)  
 [12197 BROAD BAND SPLIT FERRITE (1) REQ'D (97)  
 NOTE: LOCATE FERRITE ON #058-830-E713 MAIN POWER COILED CABLE AS CLOSE TO CONNECTOR AS POSSIBLE  
 058-830-E710 MAIN SENSOR COILED CABLE (1) REQ'D (67)  
 058-830-E713 MAIN POWER COILED CABLE (1) REQ'D (66)  
 058-830-E725 HAND PENDANT/FOOT SWITCH CABLE (1) REQ'D (69)  
 058-840-M312 SINGLE D-CONNECTOR (77)  
 MNTG BLOCK (2) REQ'D (78)  
 [10312 SCR, PAN HD, PHIL #10-32UNC x .44 LG (4) REQ'D (20)  
 [08001 LOCTITE BLUE (78)  
 [10321, VERTICAL ACTUATOR (10321)  
 058-830-E724, INTERNAL PENDANT PWR/COMM CABLE (10321)  
 058-830-E710, MAIN SENSOR COILED CABLE (10321)  
 058-830-E725, HAND PENDANT/FOOT SWITCH CABLE (10321)  
 058-830-E713, MAIN POWER COILED CABLE (10321)  
 058-800-M337, TRENDLENBURG ACTUATOR (10321)  
 [10327 BATTERY, 24 VOL 4.5 AMP/HR (1) REQ'D (95)  
 058-830-E722, EXTERNAL AC/BATT PWR CABLE (10327)  
 [12136 CABLE CLAMP LOOP (2) REQ'D (70)  
 [08425 NUT, HEX, KEPS #10-32UNC (2) REQ'D (71)  
 [10119 SCR, PAN HD, PHIL #4-40UNC x .63 LG (4) REQ'D (84)  
 058-830-E724, INTERNAL PENDANT PWR/COMM CABLE



# I-BASE ASSY

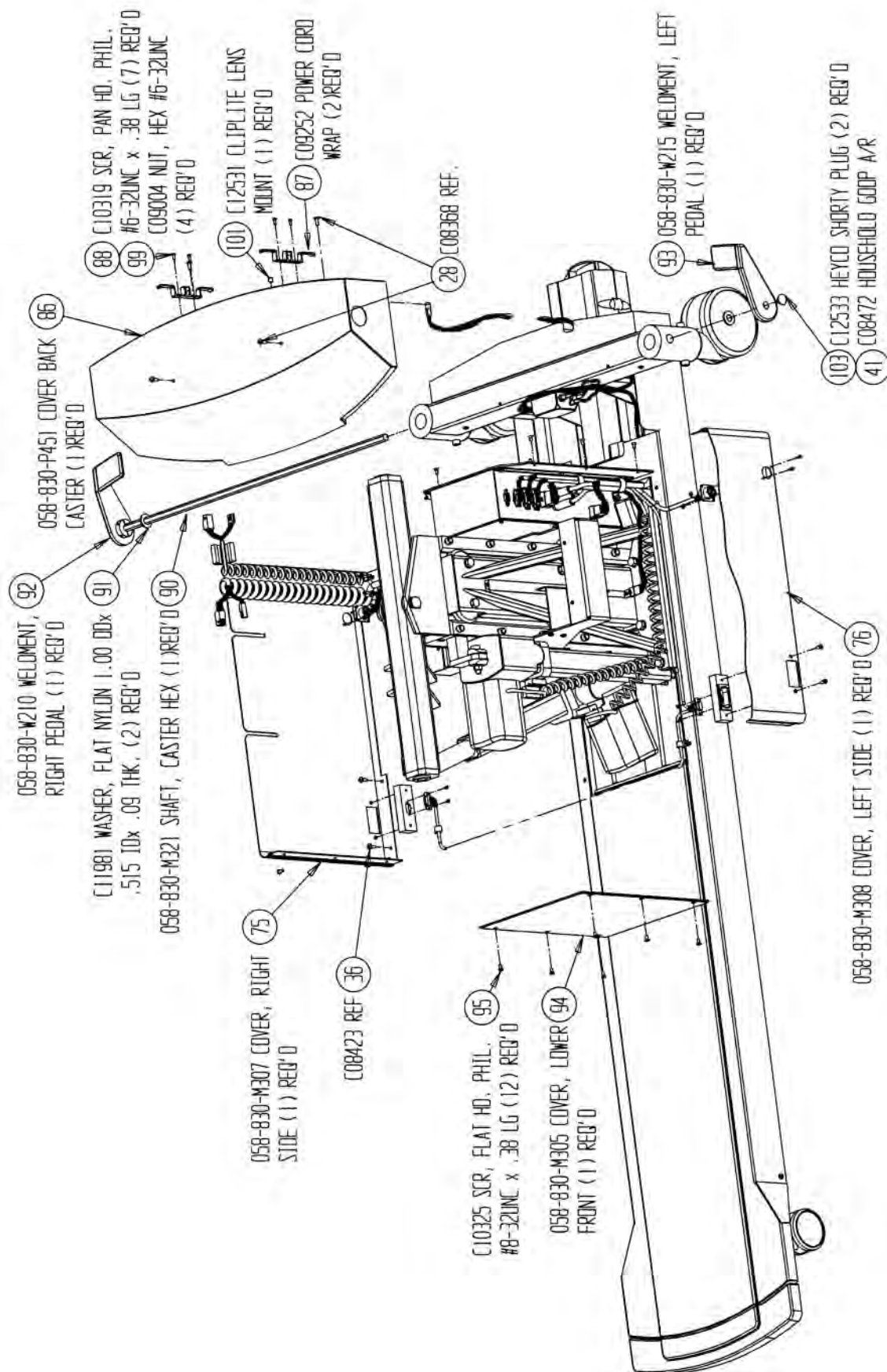



# I-BASE ASSY

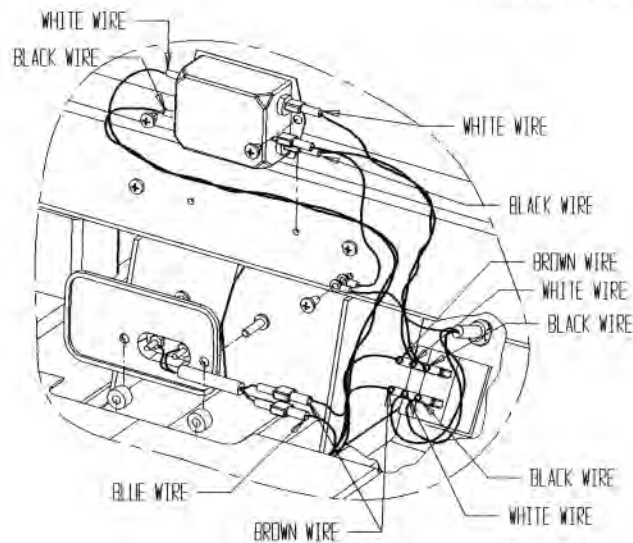
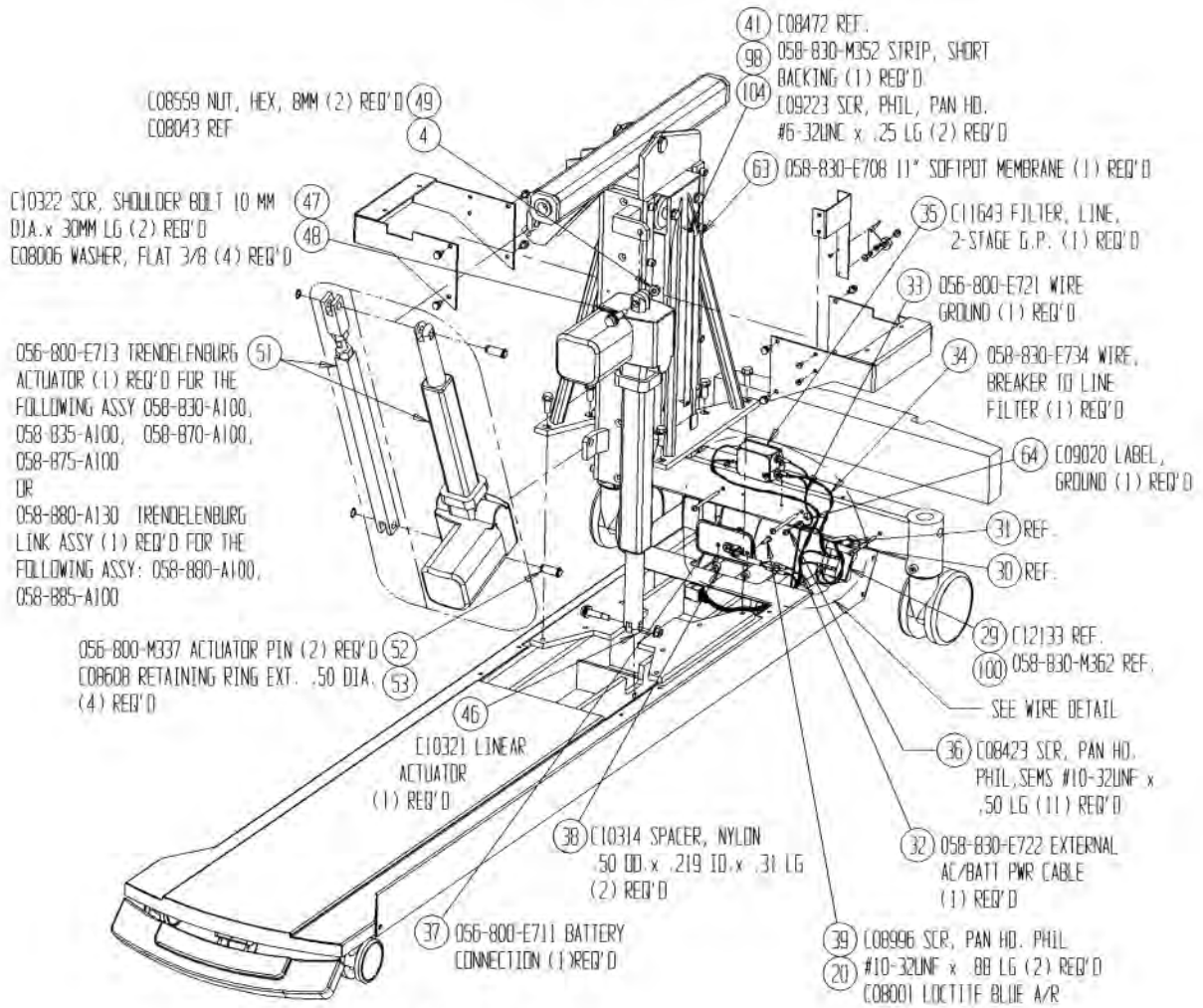

WIRE DETAIL



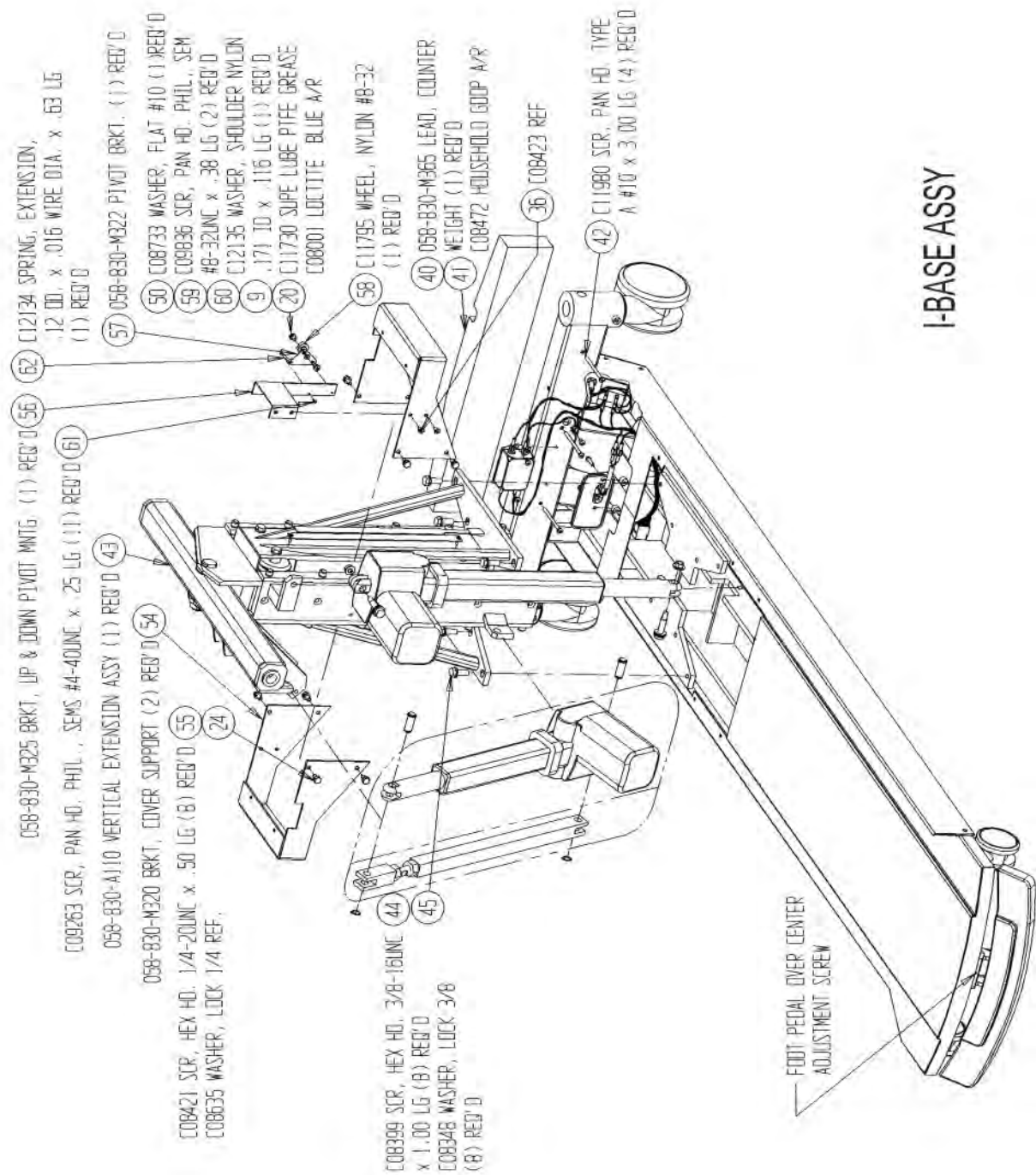



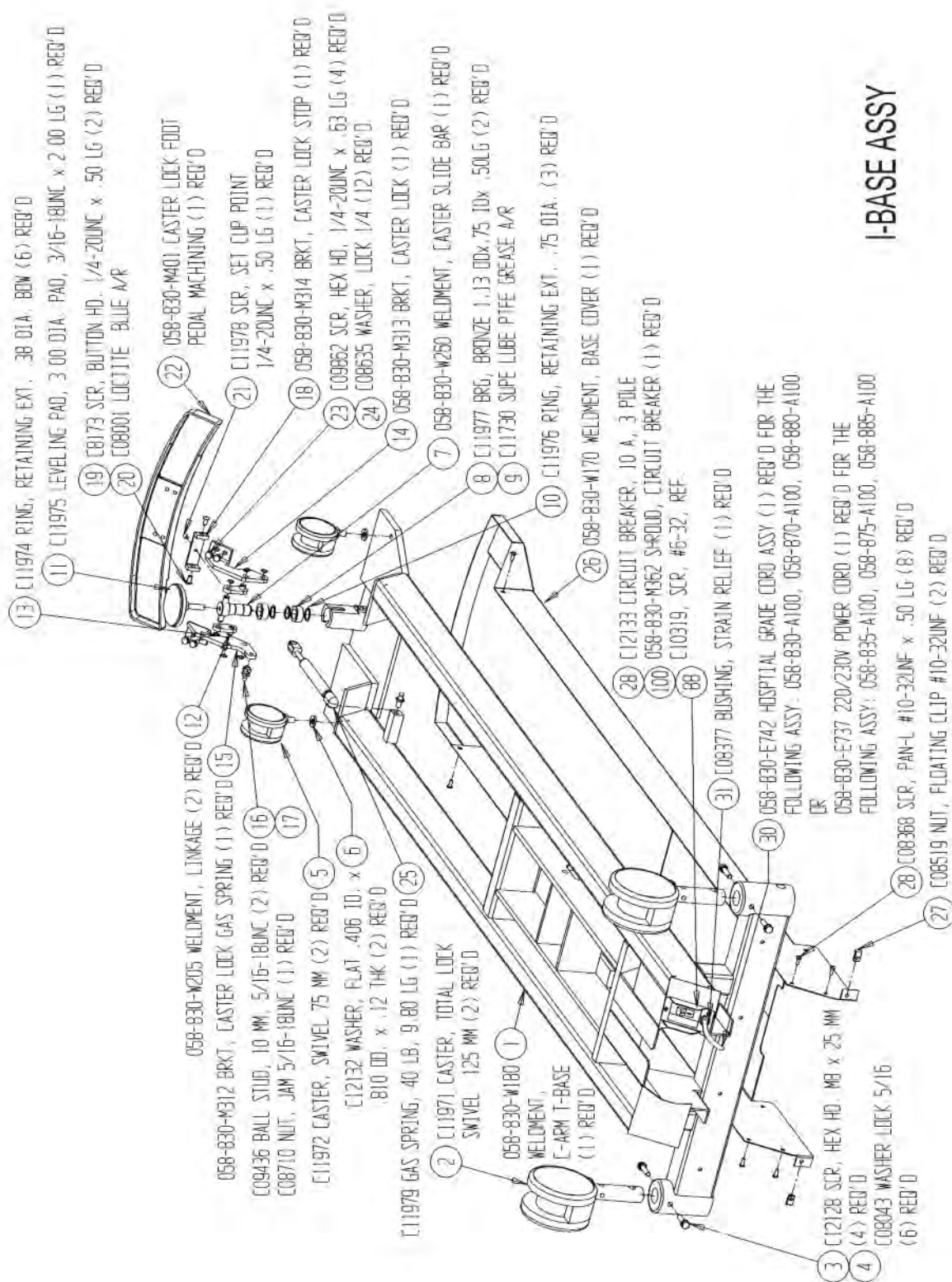

## I-BASE ASSY



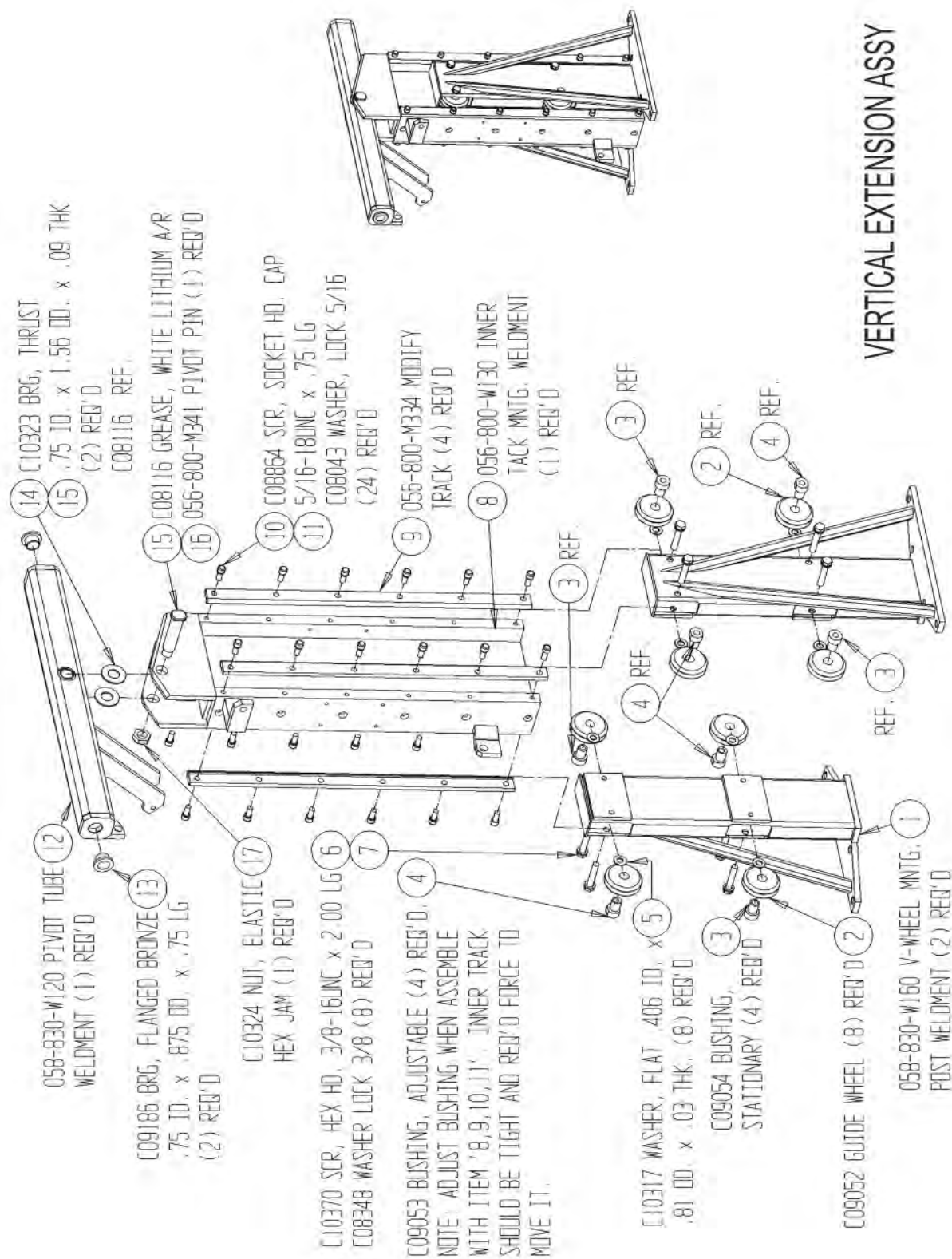



# CONTROL BOX ASSY

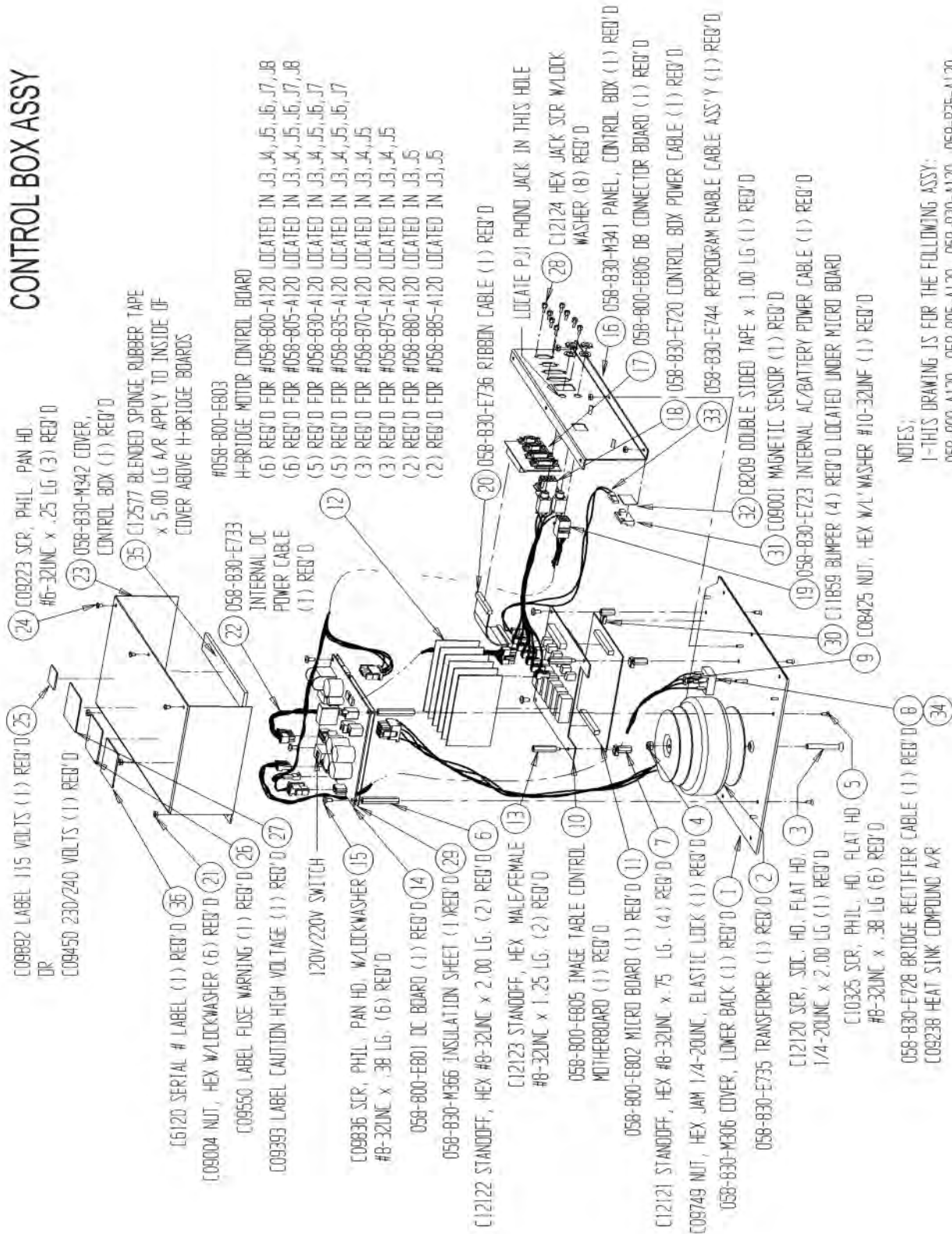

NOTES:  
1-THIS DRAWING IS FOR THE FOLLOWING ASSY:  
058-800-A120, 058-805-A120, 058-830-A120, 058-835-A120,  
058-870-A120, 058-875-A120, 058-880-A120, 058-885-A120



# BASE TOP ASSY

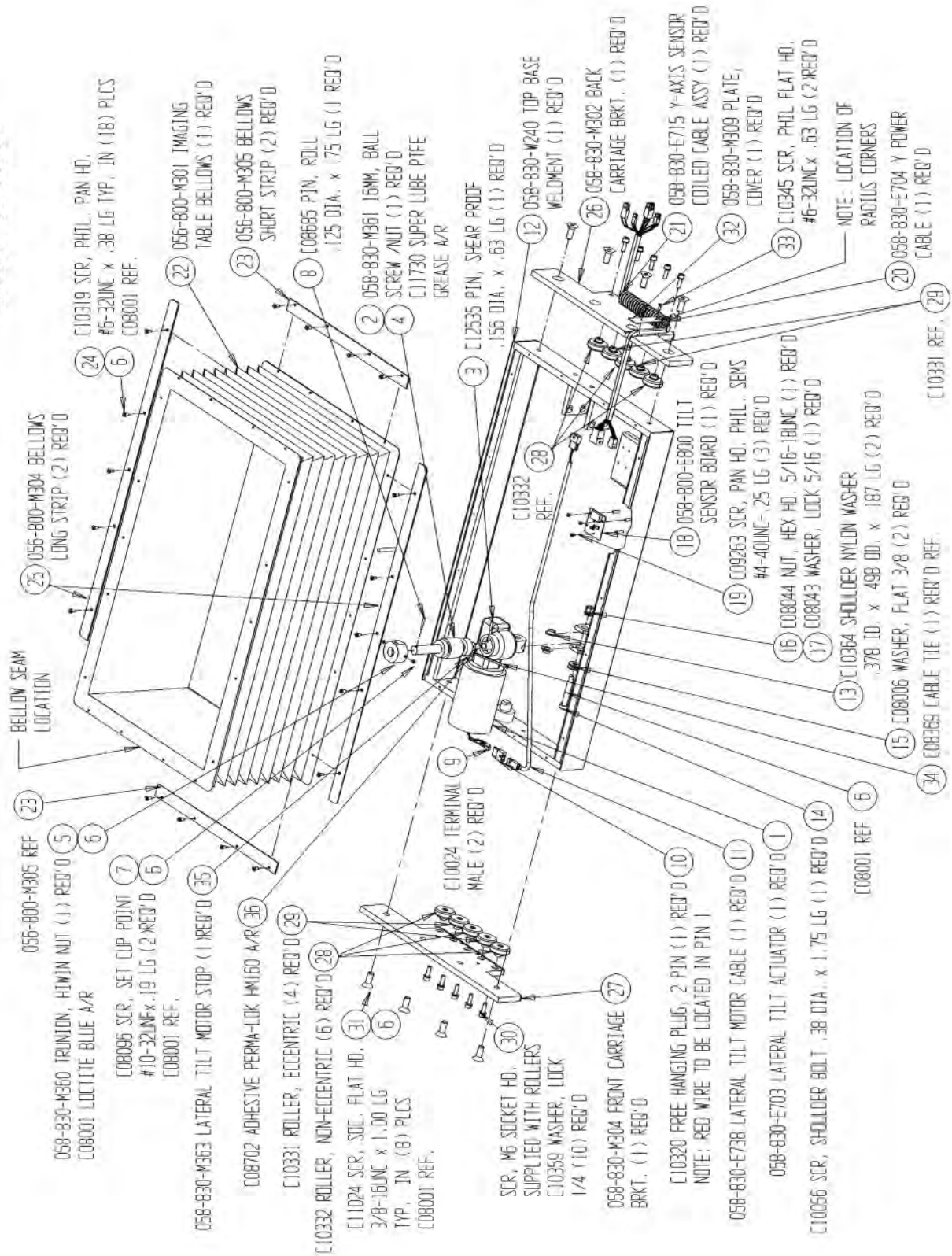



# CARRIAGE ASSY

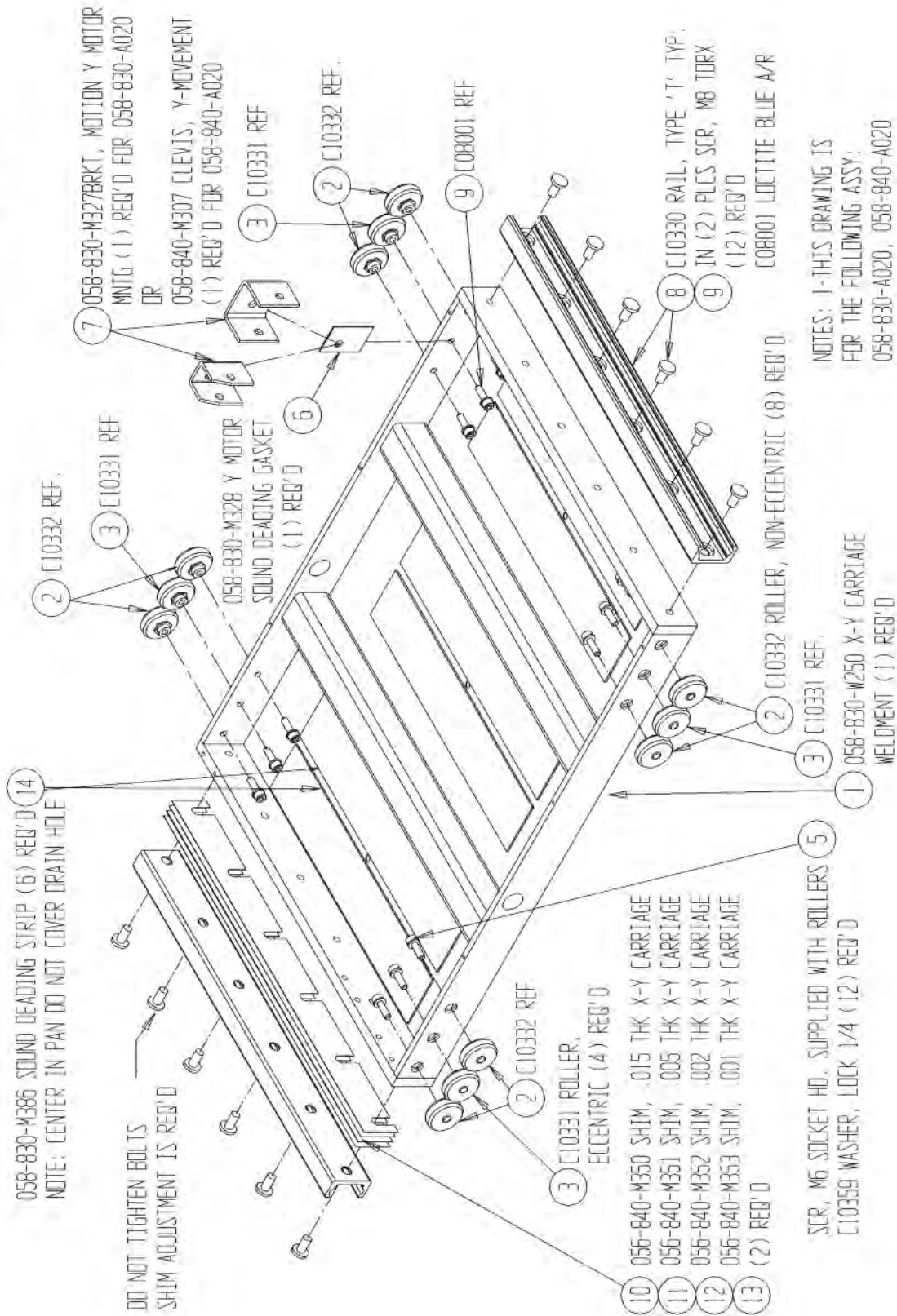



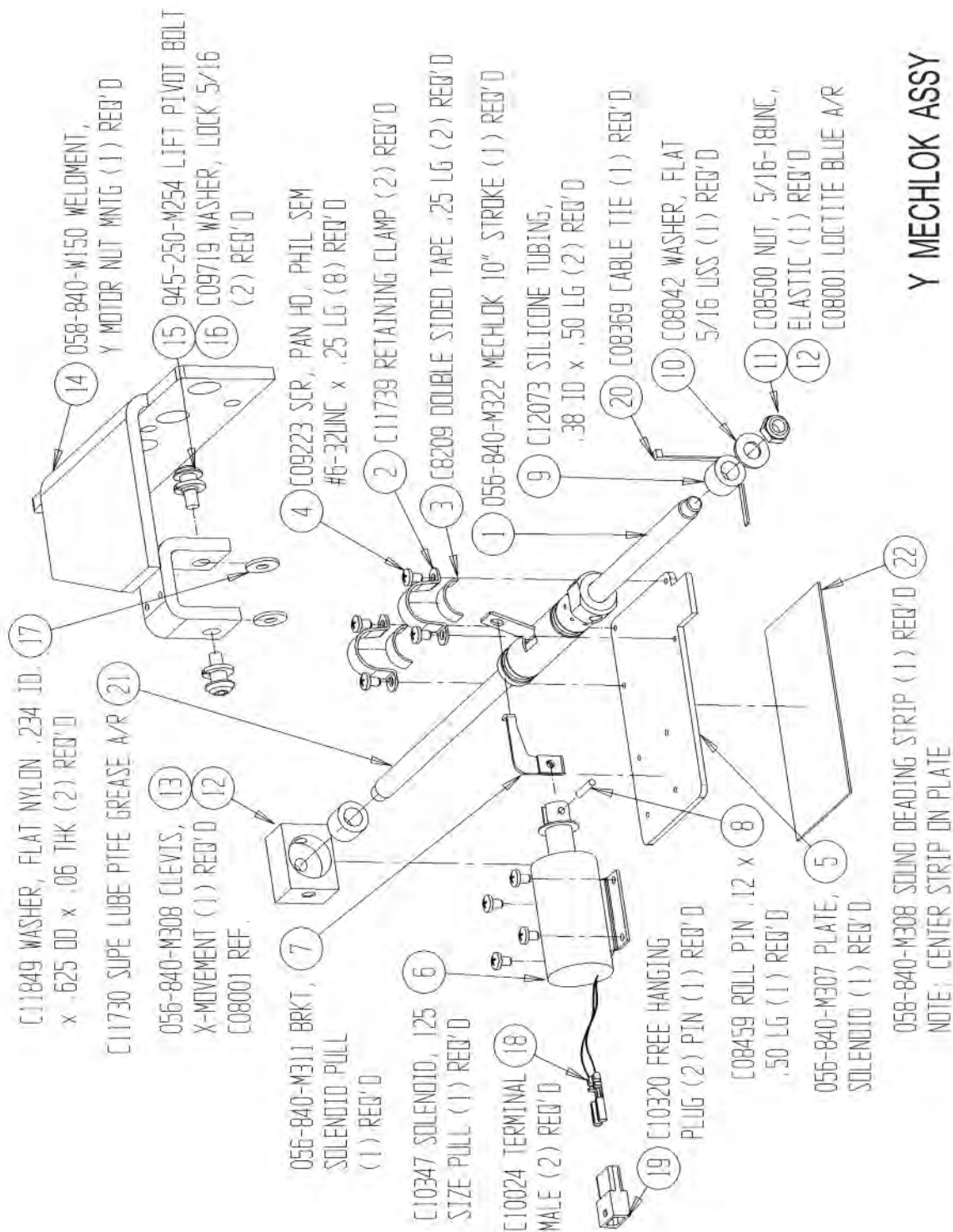

## Y MECHLOK ASSY



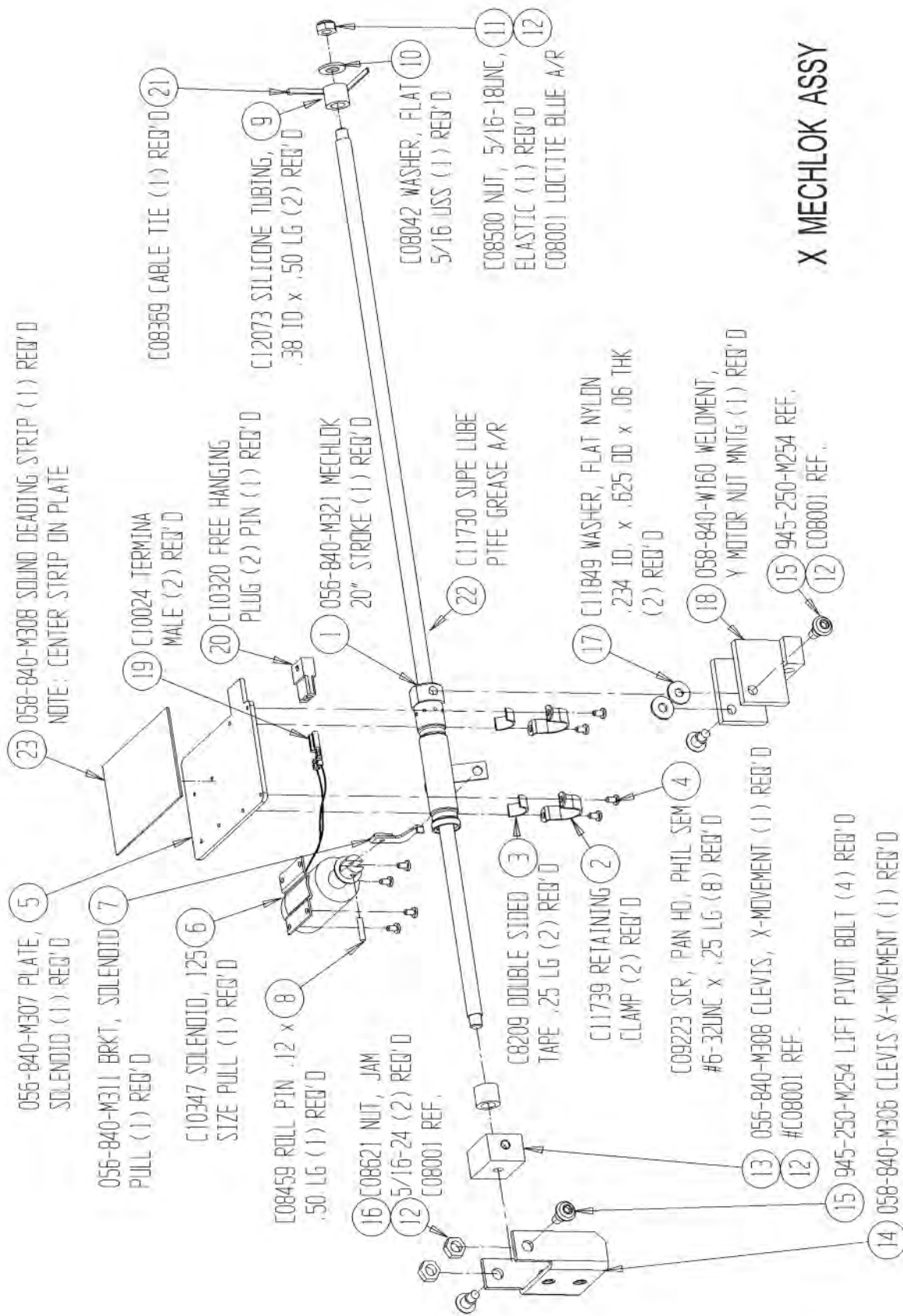

056-840-M307 PLATE, SOLENOID (1) REQ'D  
 058-840-M308 SOUND DEADING STRIP (1) REQ'D  
 NOTE: CENTER STRIP ON PLATE

- 1 056-840-M321 MECHLOK 20" STROKE (1) REQ'D
- 2 C11739 RETAINING CLAMP (2) REQ'D
- 3 C8209 DOUBLE SIDED TAPE .25 LG (2) REQ'D
- 4 C09223 SCR, PAN HD, PHIL SEM #6-32UNC x .25 LG (8) REQ'D
- 5 056-840-M307 PLATE, SOLENOID (1) REQ'D
- 6 C10347 SOLENOID, 125 SIZE PULL (1) REQ'D
- 7 C10347 SOLENOID, 125 SIZE PULL (1) REQ'D
- 8 C08459 ROLL PIN .12 x .50 LG (1) REQ'D
- 9 C12073 SILICONE TUBING .38 ID x .50 LG (2) REQ'D
- 10 C08042 WASHER, FLAT 5/16 USS (1) REQ'D
- 11 C08500 NUT, 5/16-18UNC ELASTIC (1) REQ'D
- 12 C08001 LOCTITE BLUE A/R
- 13 056-840-M308 CLEVIS, X-MOVEMENT (1) REQ'D
- 14 058-840-M306 CLEVIS X-MOVEMENT (1) REQ'D
- 15 945-250-M254 LIFT PIVOT BOLT (4) REQ'D
- 16 C08621 NUT, JAM 5/16-24 (2) REQ'D
- 17 C11849 WASHER, FLAT NYLON .234 ID. x .625 OD x .06 THK (2) REQ'D
- 18 058-840-M160 WELDMENT, Y MOTOR NUT MNTG (1) REQ'D
- 19 C10024 TERMINAL MALE (2) REQ'D
- 20 C10320 FREE HANGING PLUG (2) PIN (1) REQ'D
- 21 C08369 CABLE TIE (1) REQ'D
- 22 C11730 SLUPE LUBE PTFE GREASE A/R

# X MECHLOK ASSY



## BELLOWS SKIRT ASSY

EB209 REF.

NOTE: CLEAN BOTH SURFACES WITH ALCOHOL BEFORE APPLYING. CUT LENGTH 14.97" (2) PLCS

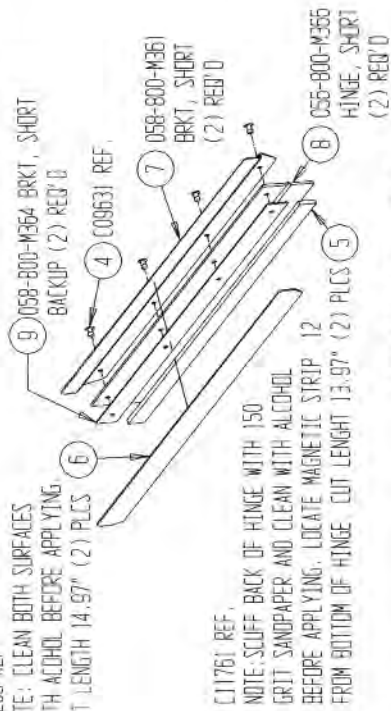

C11761 REF.

NOTE: SCUFF BACK OF HINGE WITH 150 GRIT SANDPAPER AND CLEAN WITH ALCOHOL BEFORE APPLYING. LOCATE MAGNETIC STRIP 12 FROM BOTTOM OF HINGE. CUT LENGTH 13.97" (2) PLCS

SHORT SKIRT BRACKET DETAIL

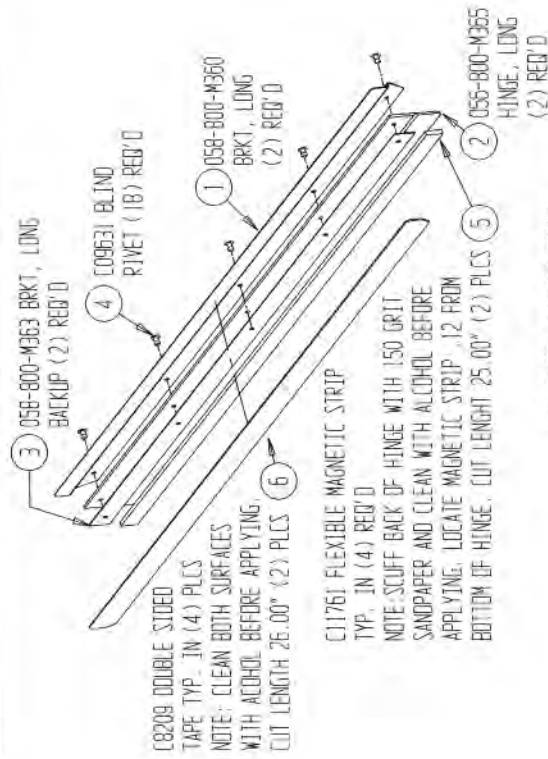

LONG SKIRT BRACKET DETAIL

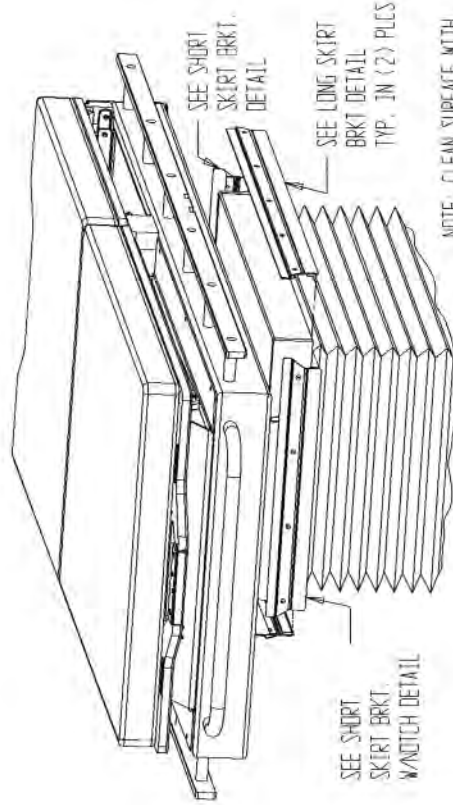

NOTE: CLEAN SURFACE WITH ALCOHOL PRIOR TO APPLYING. BRKT TO BE CENTER AND MAGNETIC TO BE EVEN WITH BOTTOM EDGE.



[illegible]

NOTES:  
1-THIS DRAWING FOR THE FOLLOWING ASSY:  
058-830-A230, 058-870-A230



# 18" NON-VIEWING EXTENSION ASSY

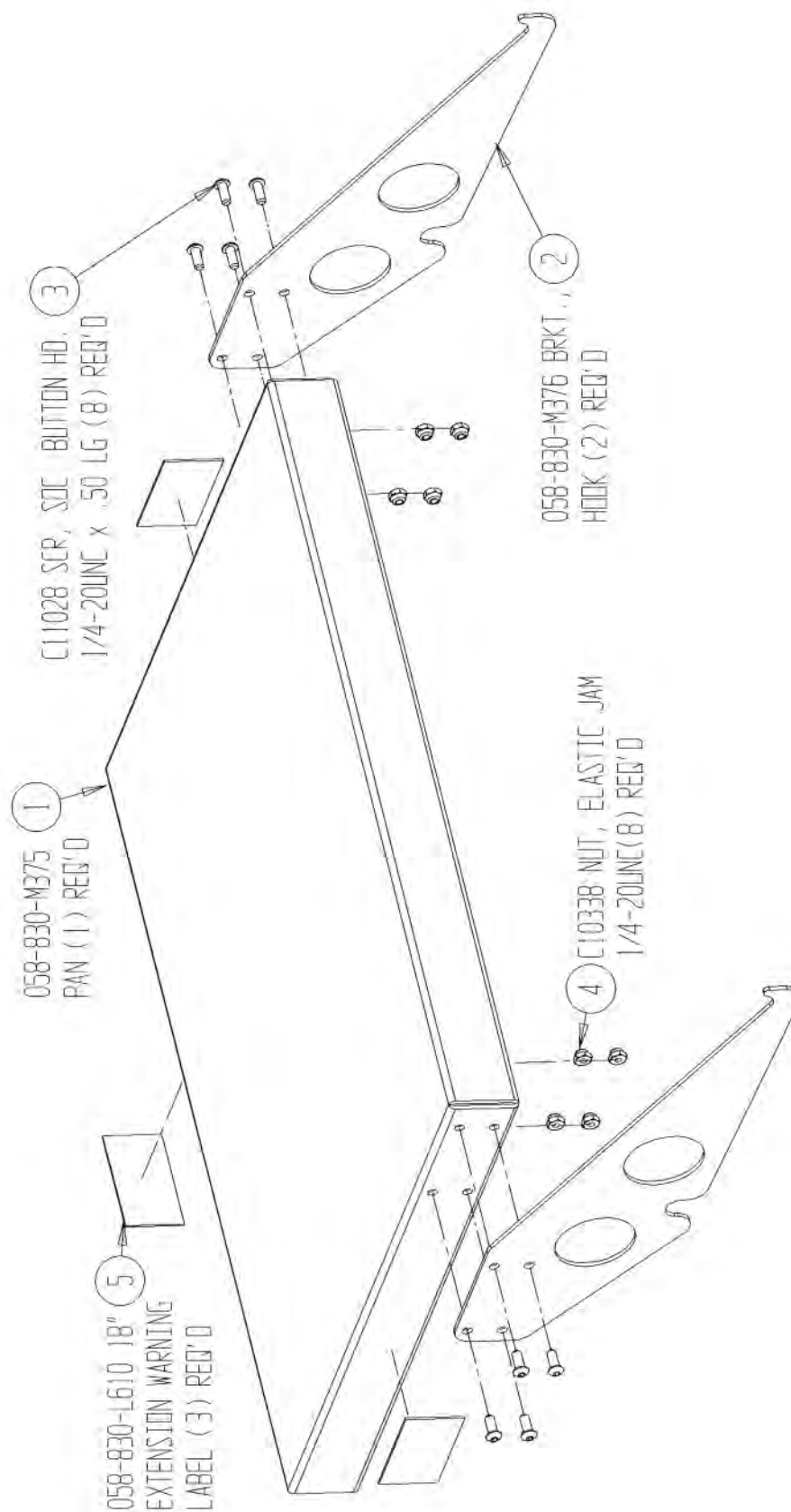



## RELEASE HANDLE ASSY

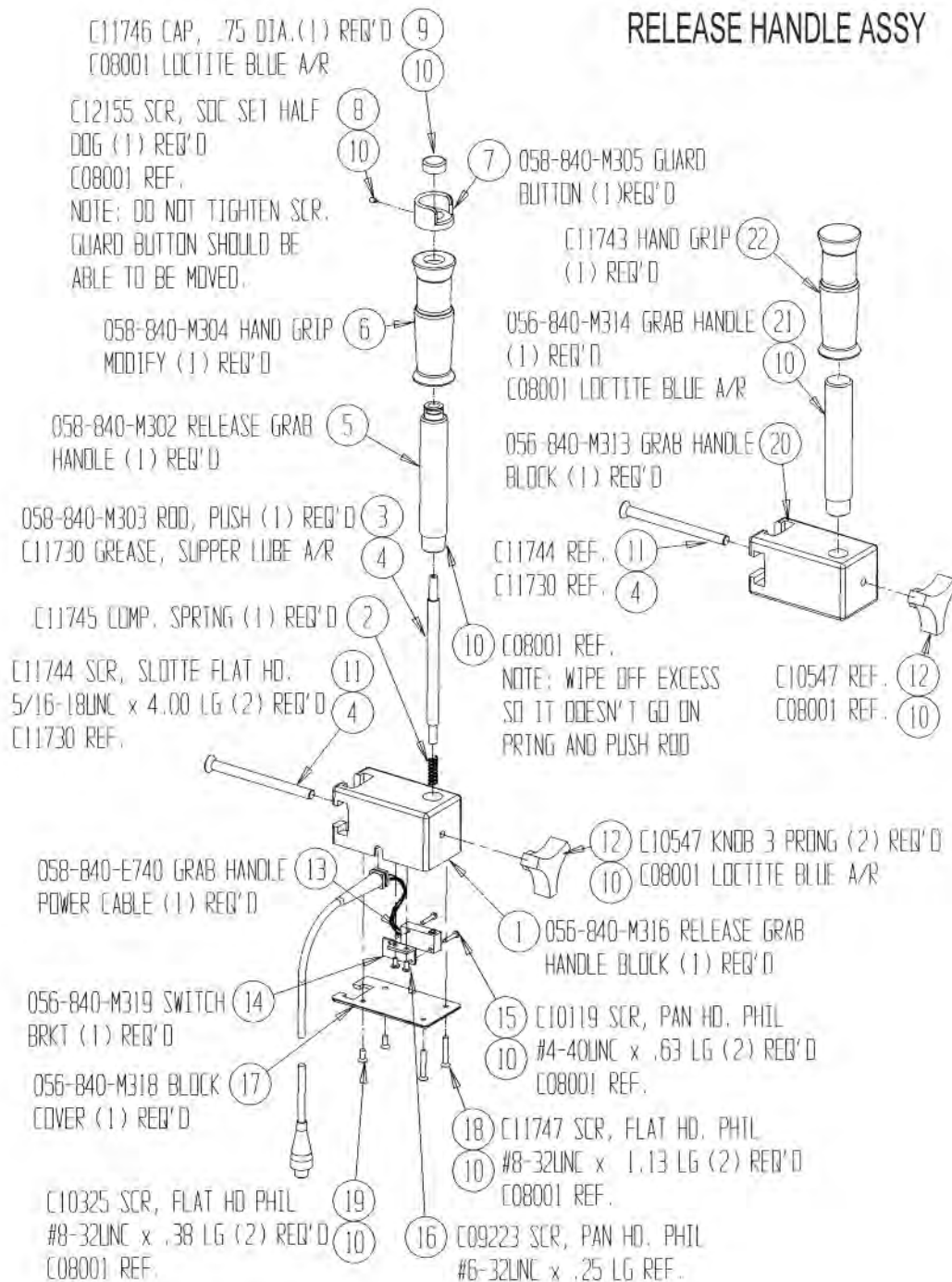

# BIODEX

Biodex Medical Systems, Inc.