

# MODEL VSU40-28

## 28 CUBIC FOOT ULTRA LOW TEMPERATURE FREEZER

	WIDTH	DEPTH	HEIGHT	WIDTH	DEPTH	HEIGHT
INTERIOR DIMENSIONS	38 IN	25 IN	51.25 IN	96 CM	63 CM	130 CM
EXTERIOR DIMENSIONS	54 IN	37 IN	79.5 IN	137 CM	93 CM	201 CM
CRATED DIMENSIONS	68 IN	45 IN	86 IN	172 CM	114 CM	218 CM

NOTE THAT SHELVES ARE SHOWN IN DEFAULT CONFIGURATION, AND CAN BE ADJUSTED IN 1" INCREMENTS

### SIDE VIEW

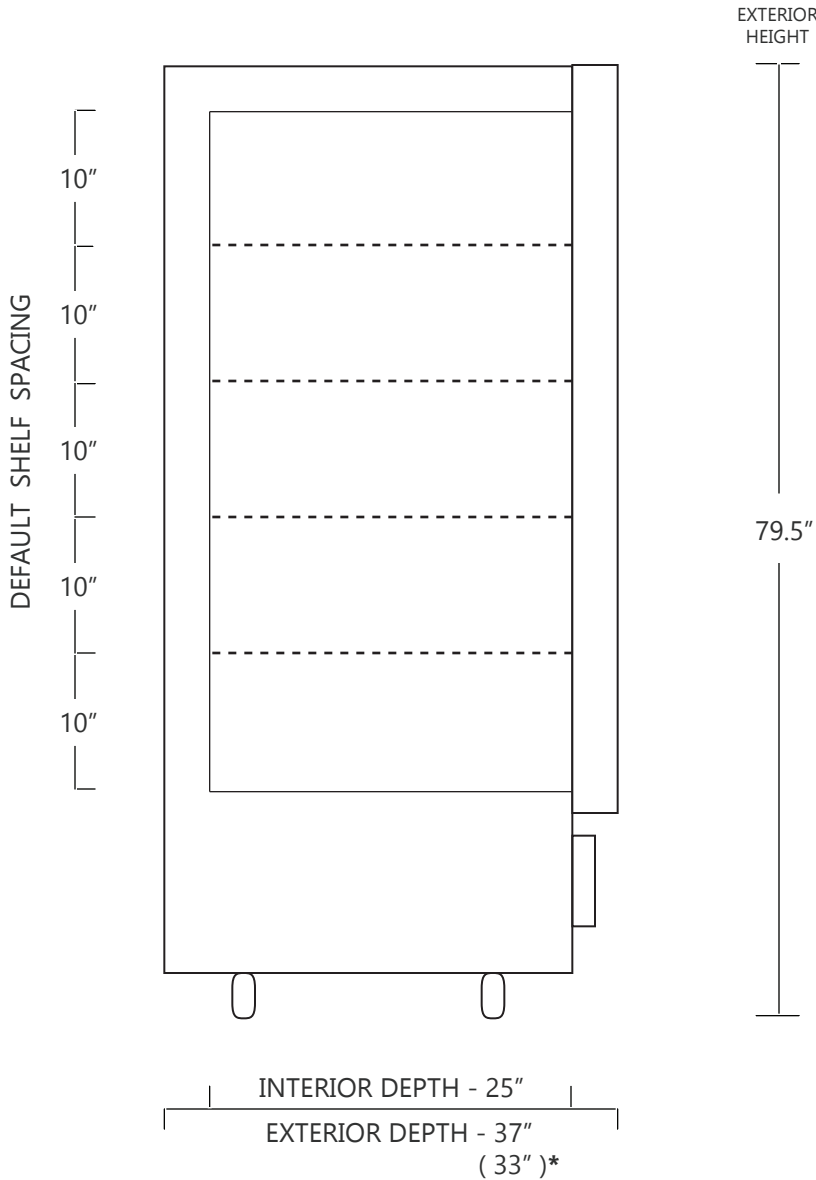

### FRONT VIEW

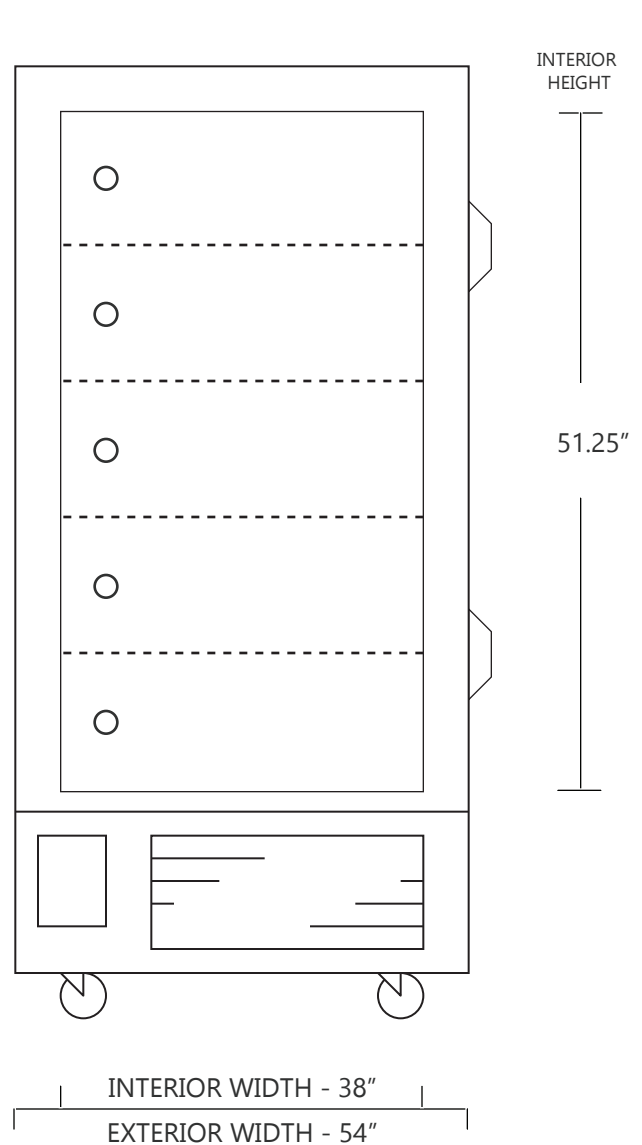

\*TO PASS THROUGH DOORWAYS, THE DOOR CAN OPEN A FULL 180°, TO REDUCE THE UNIT EXTERIOR DEPTH TO 33"

# SO-LOW



**NET WEIGHT : 950 LBS.**  
**SHIPPING WEIGHT: 1300 LBS.**

### SHIPPING OPTIONS

- DOCK-TO-DOCK DELIVERY ( REQUIRES FORKLIFT OR PALLET JACK )
- DOCK-TO-DOCK DELIVERY WITH LIFTGATE ( REQUIRES FORKLIFT OR PALLET JACK )
- INSIDE DELIVERY ( WHITE GLOVE DELIVERY )