

# MODEL VSU85-13

## 13 CUBIC FOOT ULTRA LOW TEMPERATURE FREEZER

|                     | WIDTH | DEPTH   | HEIGHT   | WIDTH  | DEPTH  | HEIGHT |
|---------------------|-------|---------|----------|--------|--------|--------|
| INTERIOR DIMENSIONS | 20 IN | 22 IN   | 51.25 IN | 50 CM  | 55 CM  | 130 CM |
| EXTERIOR DIMENSIONS | 35 IN | 34.5 IN | 79.5 IN  | 88 CM  | 87 CM  | 201 CM |
| CRATED DIMENSIONS   | 46 IN | 43 IN   | 86 IN    | 116 CM | 109 CM | 218 CM |

NOTE THAT SHELVES ARE SHOWN IN DEFAULT CONFIGURATION, AND CAN BE ADJUSTED IN 1" INCREMENTS

### SIDE VIEW

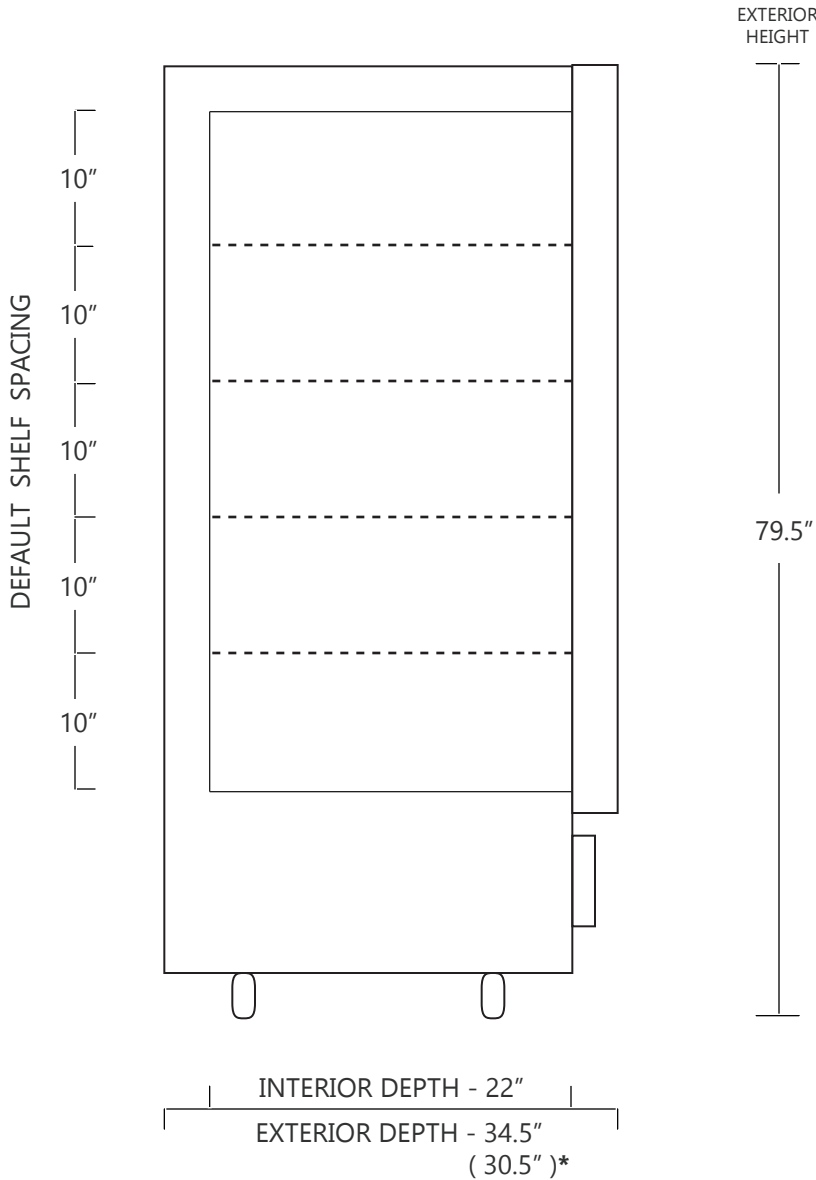

### FRONT VIEW

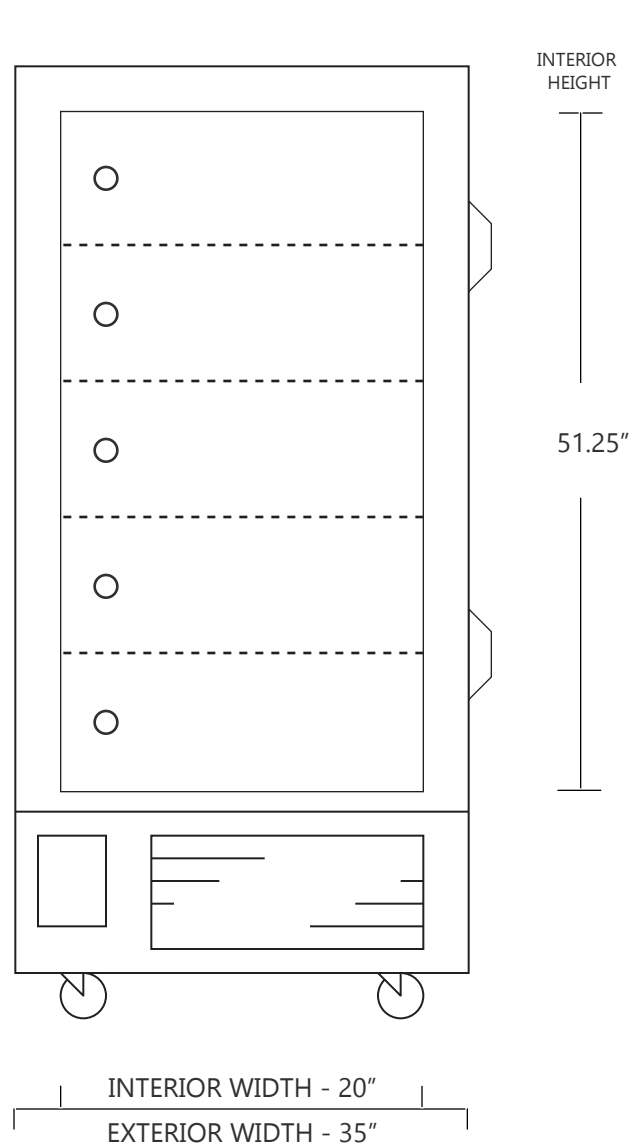

\*TO PASS THROUGH DOORWAYS, THE DOOR CAN OPEN A FULL 180°, TO REDUCE THE UNIT EXTERIOR DEPTH TO 30.5"

# SO-LOW



**NET WEIGHT : 675 LBS.**  
**SHIPPING WEIGHT: 850 LBS.**

### SHIPPING OPTIONS

DOCK-TO-DOCK DELIVERY ( REQUIRES FORKLIFT OR PALLET JACK )  
DOCK-TO-DOCK DELIVERY WITH LIFTGATE ( REQUIRES FORKLIFT OR PALLET JACK )  
INSIDE DELIVERY ( WHITE GLOVE DELIVERY )