

# GVM-MULTI

## Multi Tube Vortexer

### Quick Start Guide

#### What's in the box:

- Quick Start Guide
- User Manual
- Vortex Mixer
- Power Brick and 3 Cords (1 each: US plug, UK plug, EU plug)

#### INSTALLATION

1. Unpack and remove all packing materials used during shipment.
2. Place the instrument on a clean, level, and stable surface.
3. Allow approximately 4 inches surrounding the unit for safe operation.
4. Connect the appropriate power cord from your mains voltage to the external power supply and the DC power lead from the power supply to the rear socket on the vortexer.
5. Align tab on power supply lead with slot in the socket on the rear of the unit.
6. Once aligned, tighten the power supply lead to the rear socket.
7. Turn power switch on.



#### LOADING INSTRUCTIONS

1. Loosen knobs then lift and rotate lid as seen in images below.
2. Place the foam attachment in the base and place vessels in the cavities, then place upper foam between vessels and lid.
3. Reverse procedure from step 1. Lower the lid to tighten down on your vessels. Ensure the knobs are tight on both sides before starting the operation.

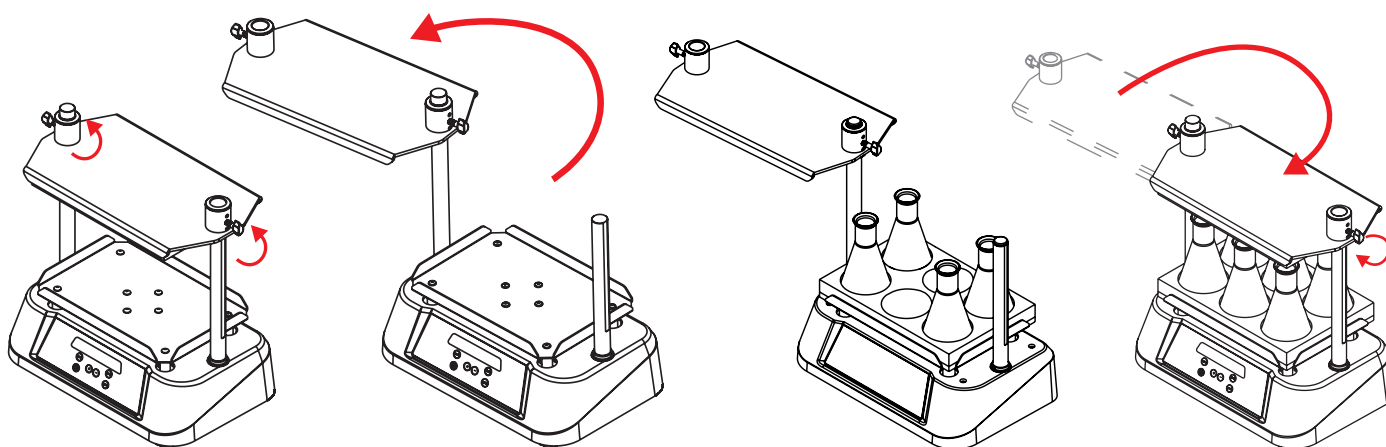

**IMPORTANT:** When vortexing lesser quantities, make sure the vessels are equally balanced to distribute weight evenly.

Continued ...

# GVM-MULTI

## Multi Tube Vortexer

### Quick Start Guide

#### CONTROL PANEL

1. Adjust settings to appropriate speed, time and pulse mode.
2. Speed, Time, and Pulse values are saved after the display flashes 5 times.
3. DO NOT turn the vortexer off and on instantaneously. Please wait 3 seconds prior to turning back on.

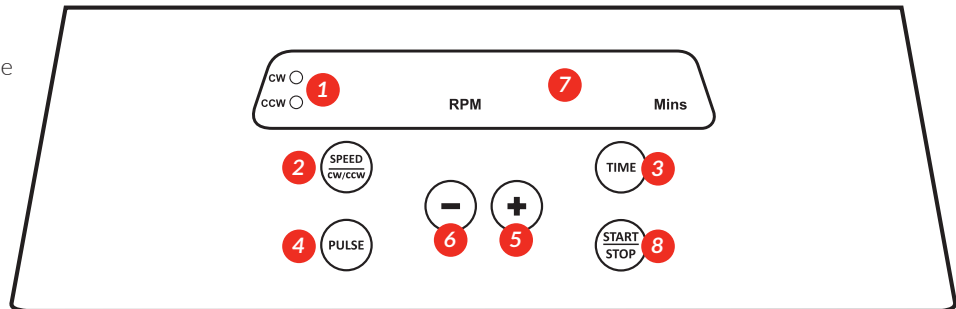

#### FUNCTION

- 1 **CW/CCW**..... LEDs show clockwise or counterclockwise motion
- 2 **SPEED**..... Press SPEED button to select speed by increment(+) / decrement(-)
- 3 **TIME**..... Press TIME button to select time by increment(+) / decrement(-)
- 4 **PULSE**..... Press PULSE button to activate pulse mode
- 5 **+** ..... Press INCREMENT button to increase the values of selected parameters; Speed, Time & Pulse
- 6 **-** ..... Press DECREMENT button to decrease the values of selected parameters; Speed, Time & Pulse
- 7 **DISPLAY**..... The digital Display shows speed value, time value and pulse parameters
- 8 **START/STOP** ... Press "START/STOP" to start or stop operation

Foam Attachment	Capacity	Maximum Recommended Speed	Maximum Recommended Fill
1.5/2mL tube foam	72 tubes	1500rpm	Not more than 75%
7mL tube foam	60 tubes	2500rpm	
15mL tube foam	45 tubes	2500rpm	
50mL tube foam	18 tubes	2500rpm	
50mL tube foam	7 tubes	As per application	
250mL flask foam	6 flasks	1200rpm	

