

PRESTAN[®]

Ultralite[®]

with CPR Feedback
-User Guide-

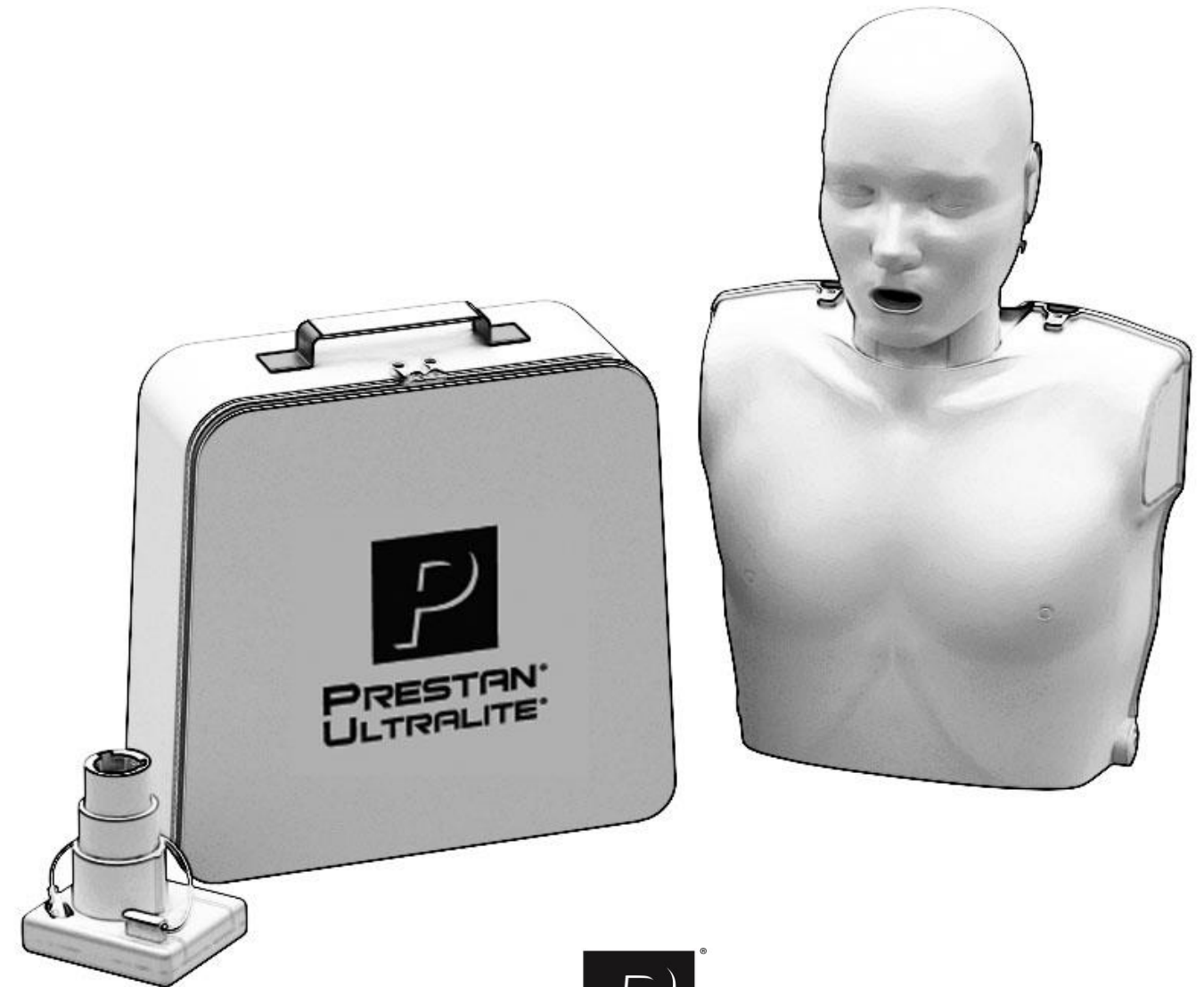

PRESTAN® Ultralite® Manikins with CPR Feedback

THANK YOU for buying the Prestan Ultralite Manikins with CPR Feedback,

CARE AND CLEANING:

- When not in use, the components should be stored in the carrying case and in a cool, dry place.
- Ultralite Manikins may be cleaned in a variety of ways. A non-abrasive cleaner is recommended:
 - They can be wiped down with a Clorox® or Lysol® disinfecting wipe.
 - Cleaned with a mixture of soap and water.
 - Sprayed or wiped with common household cleaners such as Formula 409®, Windex® or Vim®.

The face may also be sanitized with alcohol, Clorox® or Lysol® wipes. Between student uses (and prior to applying the face shield), the instructor (or student) may clean the faces with a sanitizing wipe as an extra measure of protection.

Students may be provided with an individual face shield (sold separately) which may be placed over the Face-Shield/Lung-Bag. This allows multiple students to use one Face-Shield/Lung-Bag during a session.

Order through your Prestan Authorized Distributor:

Ultralite Manikins Face Shields, 50-count

#PP-UFS-50

Ultralite Manikins Face-Shield/Lung-Bags, 10-count

#PP-ULB-10

Ultralite Manikins Face-Shield/Lung-Bags, 50-count

#PP-ULB-50

TROUBLESHOOTING:

- If you cannot get the chest to rise when you blow into the face shield lung bag:
 - Check to make sure that the head is tilted back to create an open airway.
 - Check the lung bag itself. Ensure that it is properly positioned over the compression plate, not twisted and is lying flat.
 - Check the face shield. Ensure that it is attached to the 'buttons' on the side of the manikin head and that it is flat against the face of the manikin.
 - Check the bag to insure that has not been torn by testing inflation outside of the manikin.
- If the chest does not compress and/or it seems the piston is binding:
 - Ensure proper hand placement - check horizontal hand placement and adjust to center in between the nipples.

FURTHER INFORMATION:

. If you have any questions about the Prestan Manikin line, if you would like to order more manikins, or if you would like to order any accessories for your manikin, please contact your Prestan Authorized Distributor.

PRESTAN®

Ultralite® Manikins with CPR Feedback



ASSEMBLE

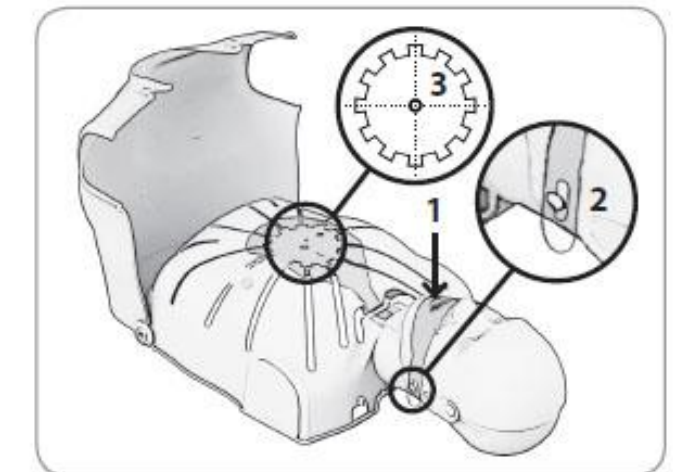
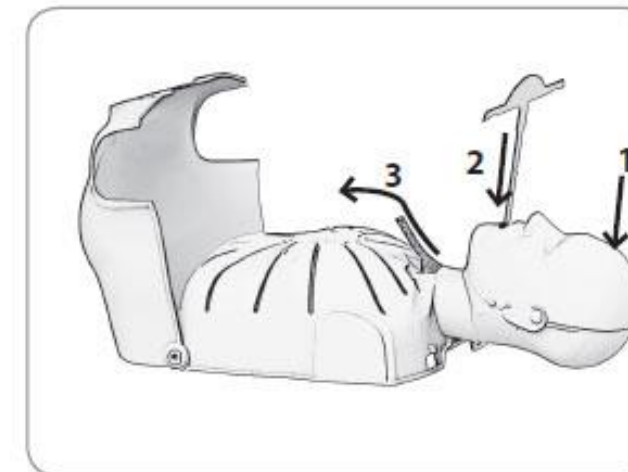
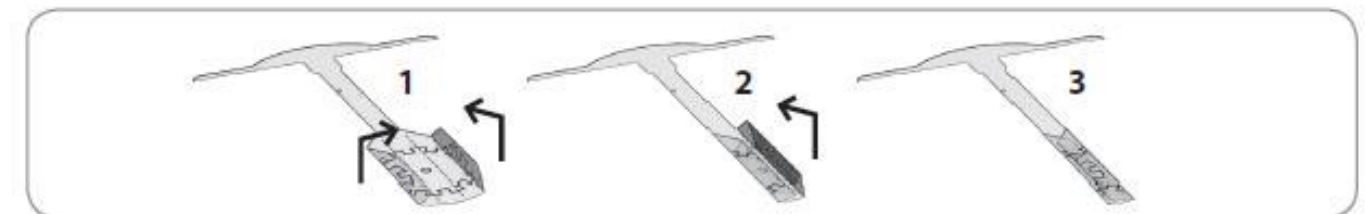
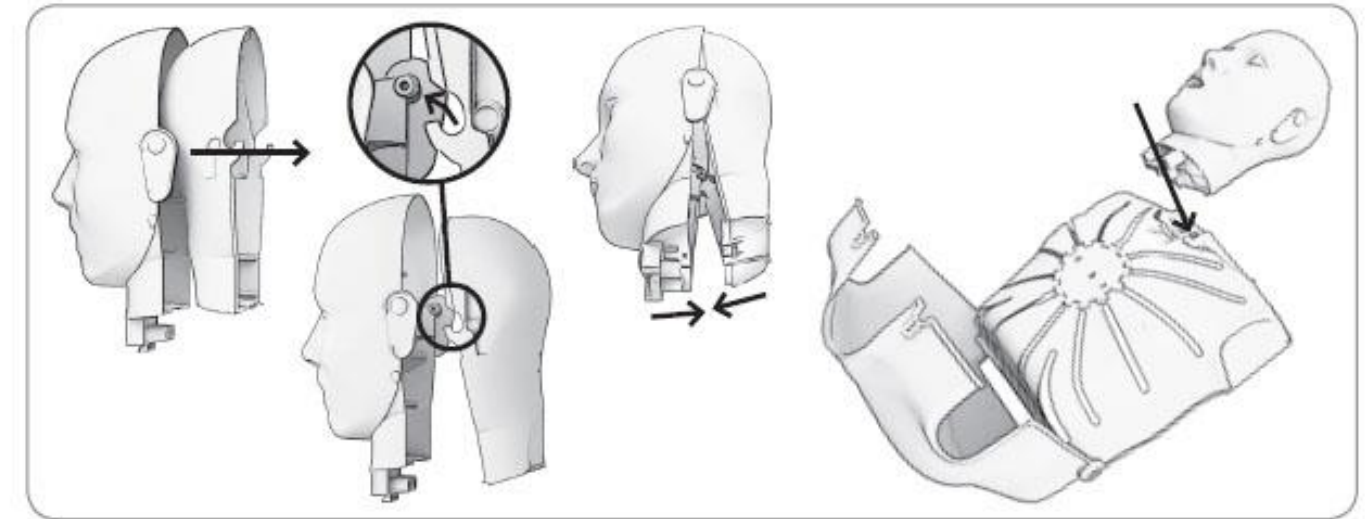
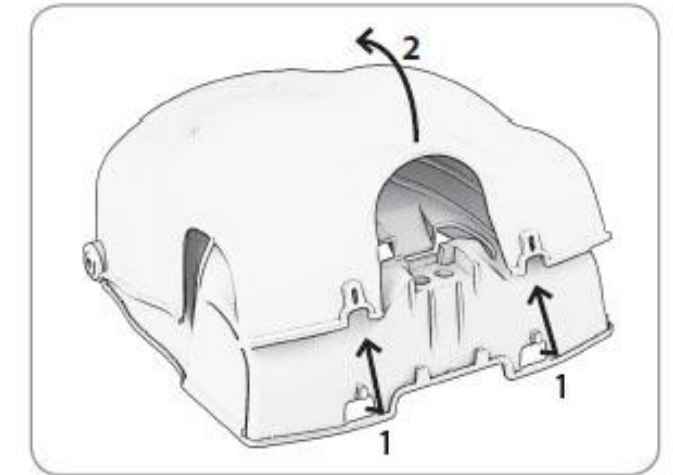
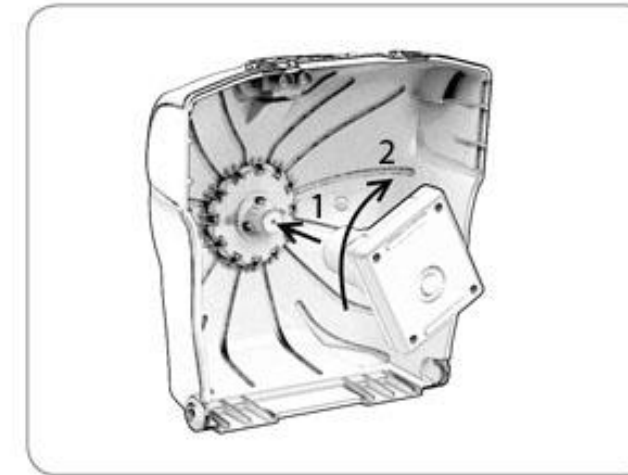

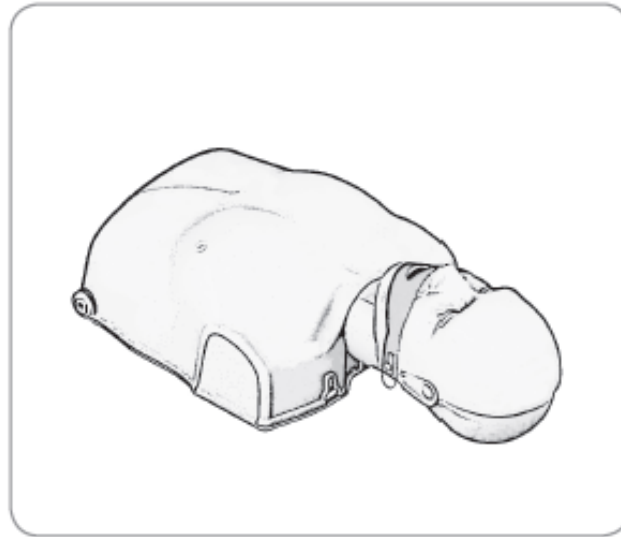
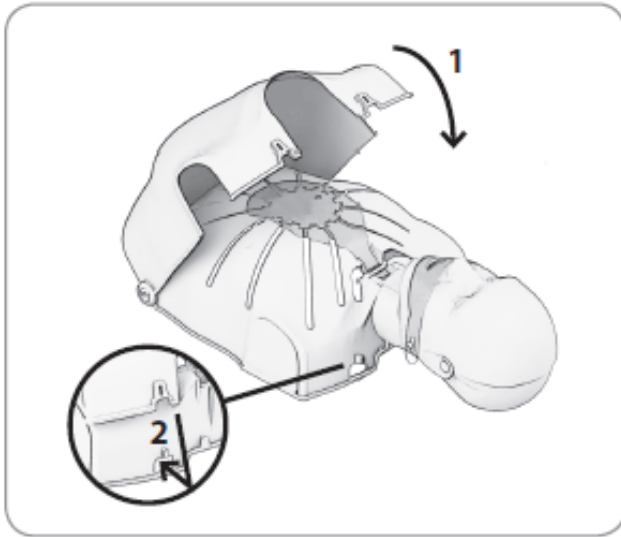

DISASSEMBLE

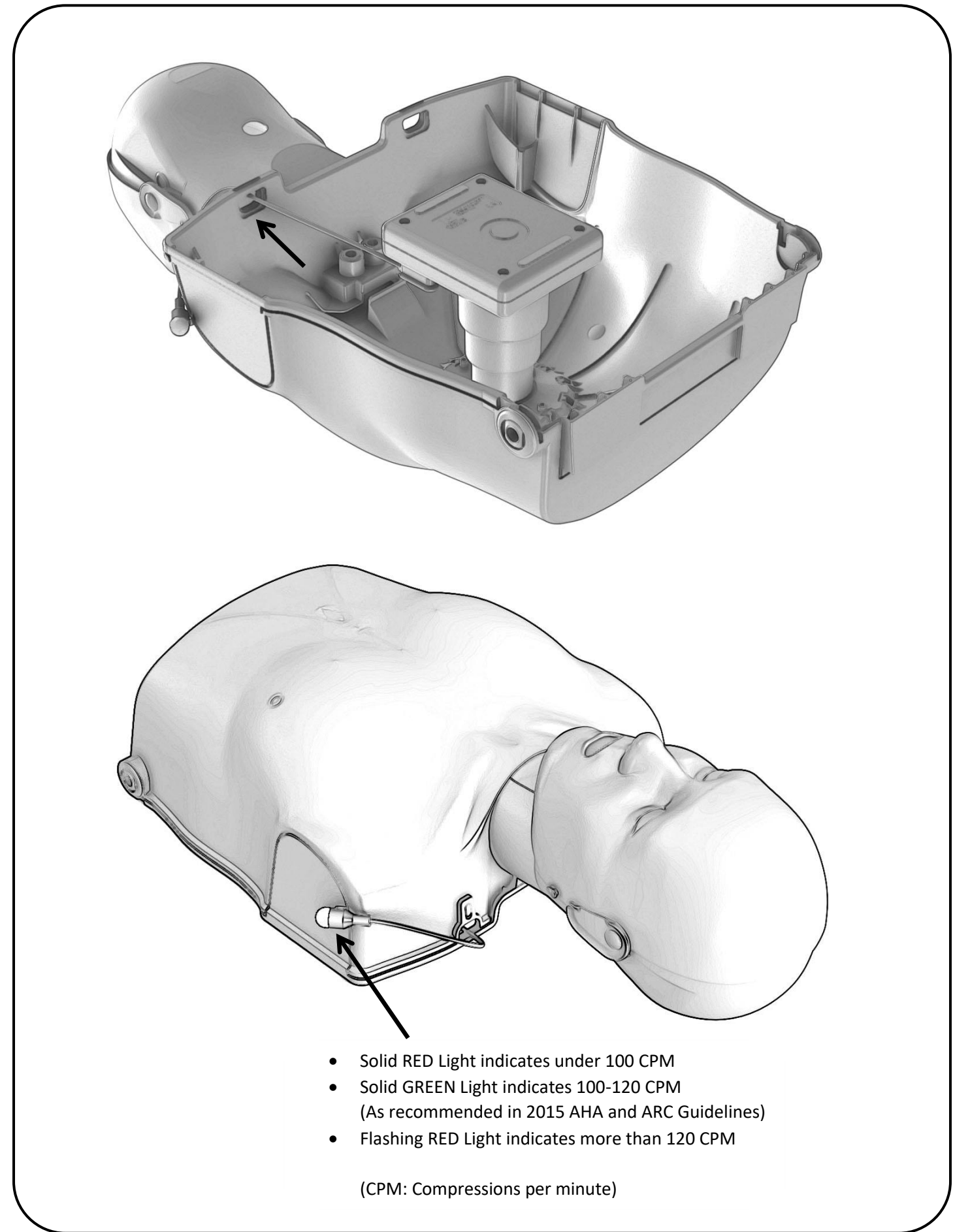
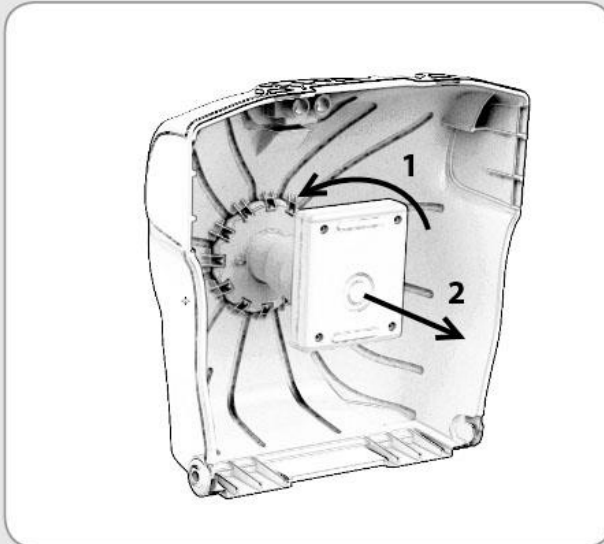
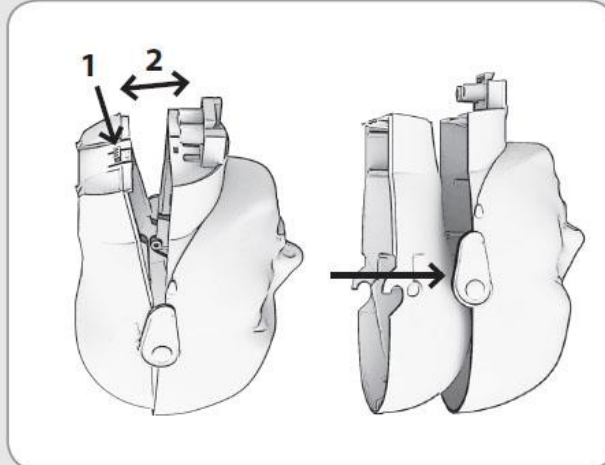
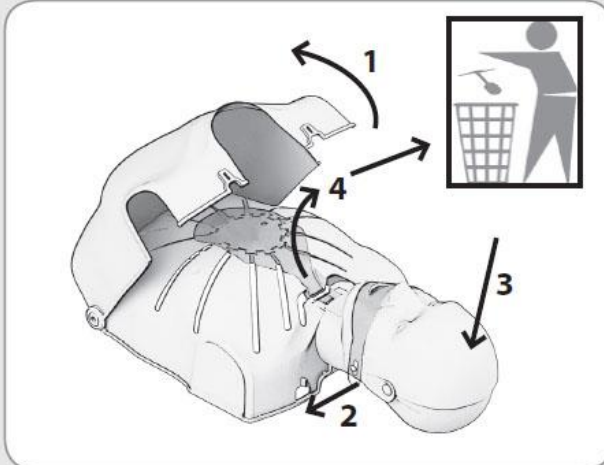

PRESTAN[®]
Infant Ultralite[®]
with CPR Feedback
-User Guide-





Setup

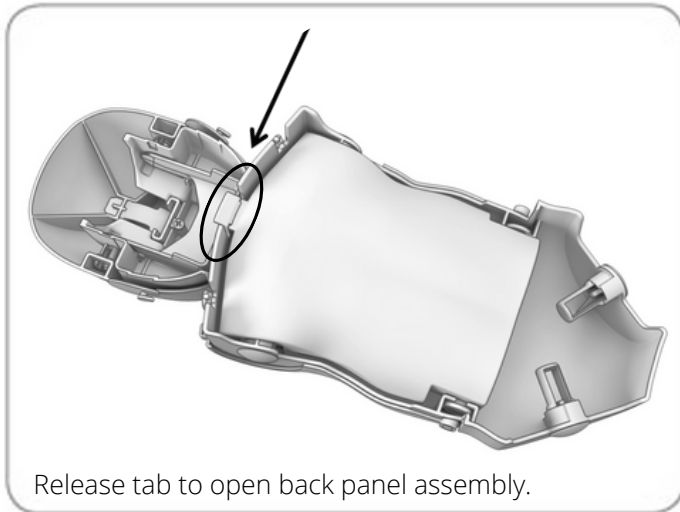

Release tab to open back panel assembly.

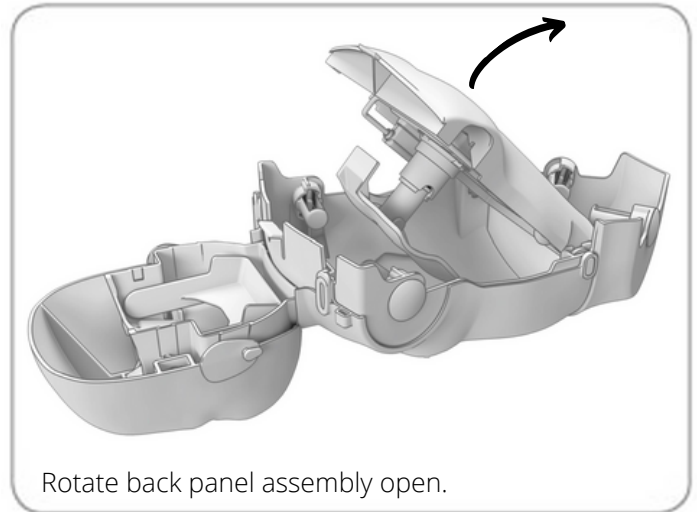

Rotate back panel assembly open.

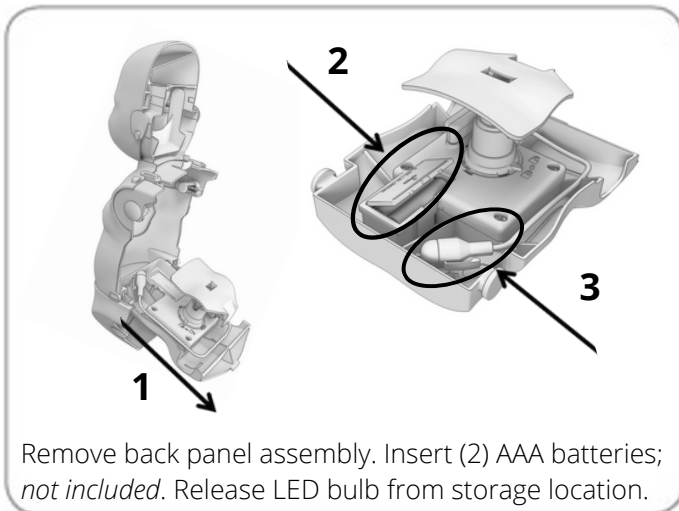

Remove back panel assembly. Insert (2) AAA batteries; *not included*. Release LED bulb from storage location.

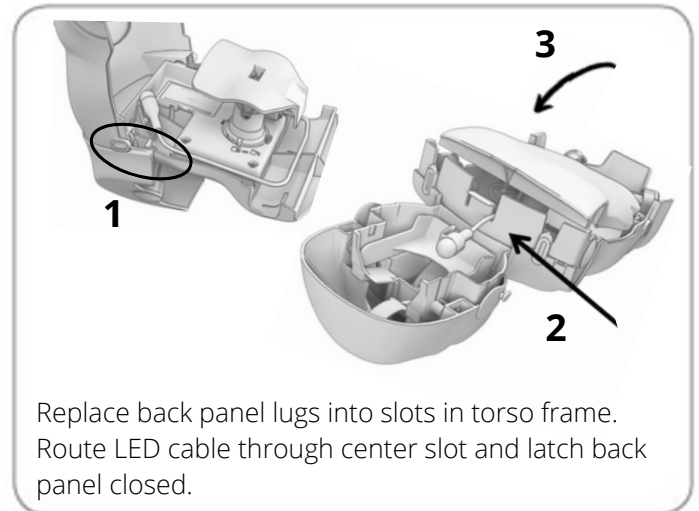

Replace back panel lugs into slots in torso frame. Route LED cable through center slot and latch back panel closed.

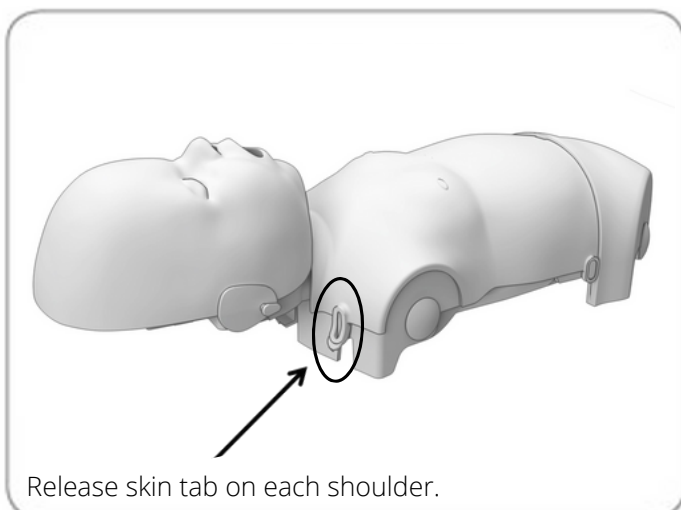

Release skin tab on each shoulder.

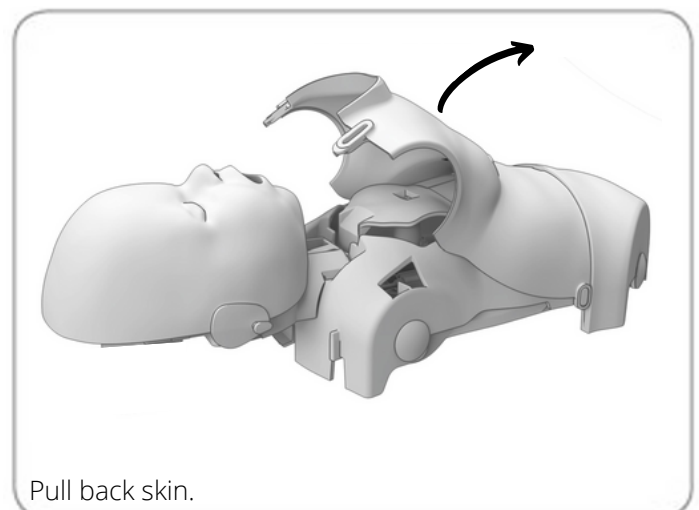

Pull back skin.



Setup (continued)

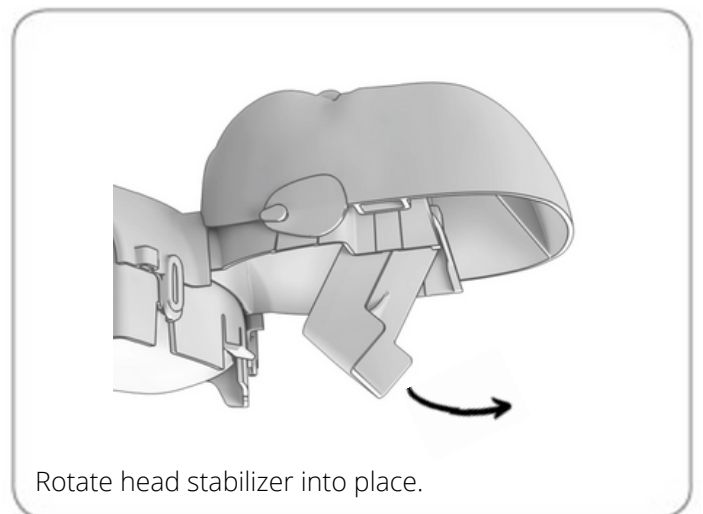
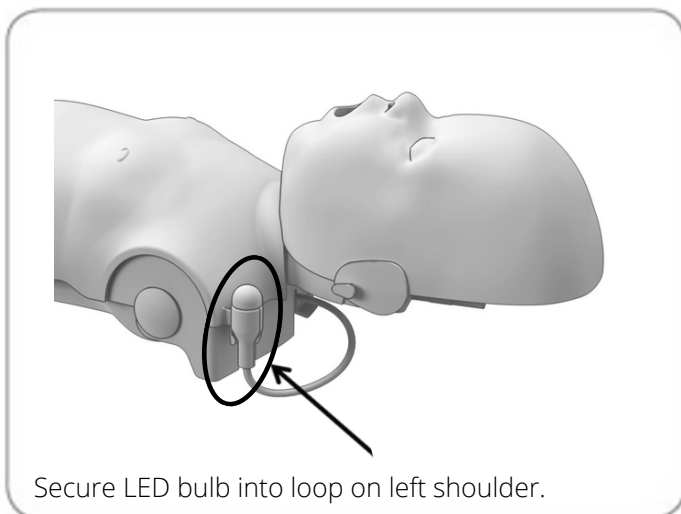
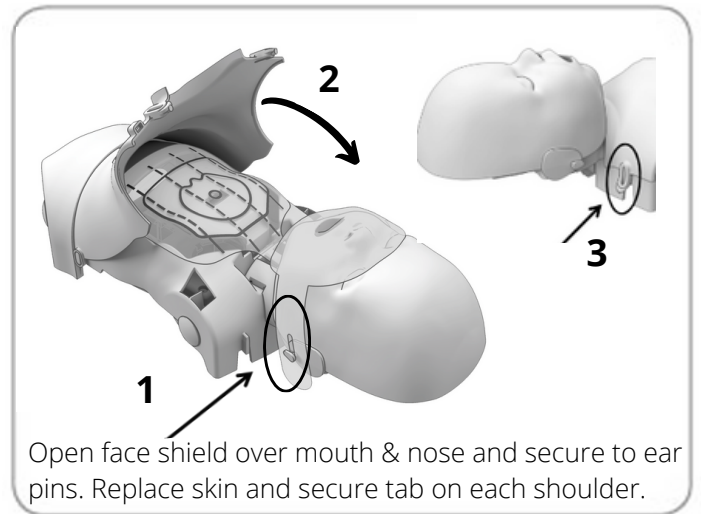
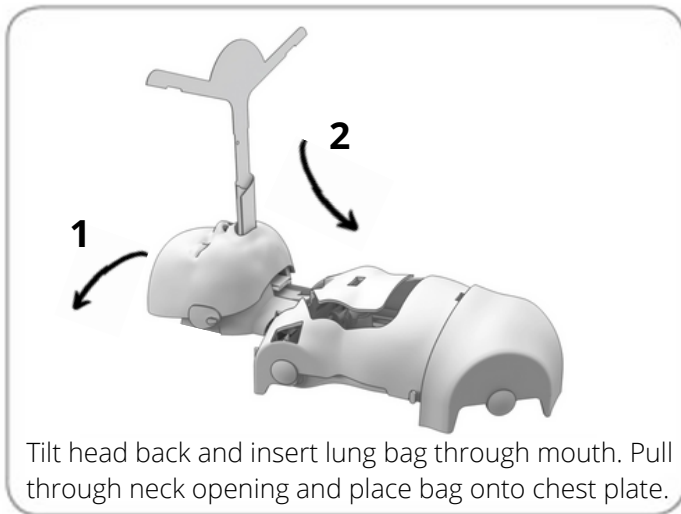
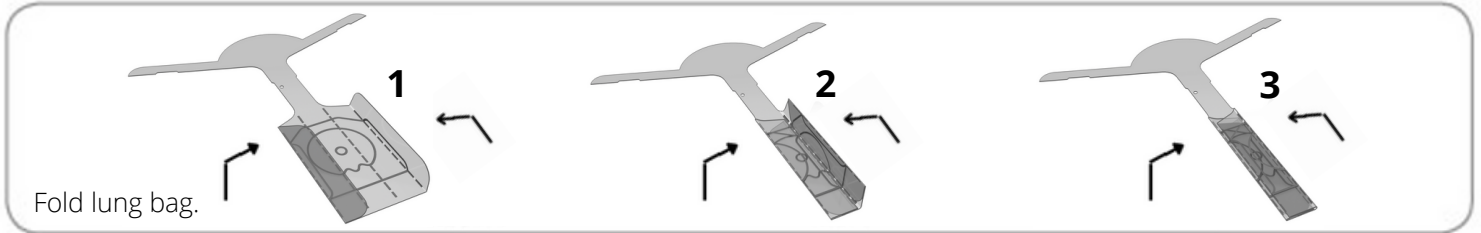

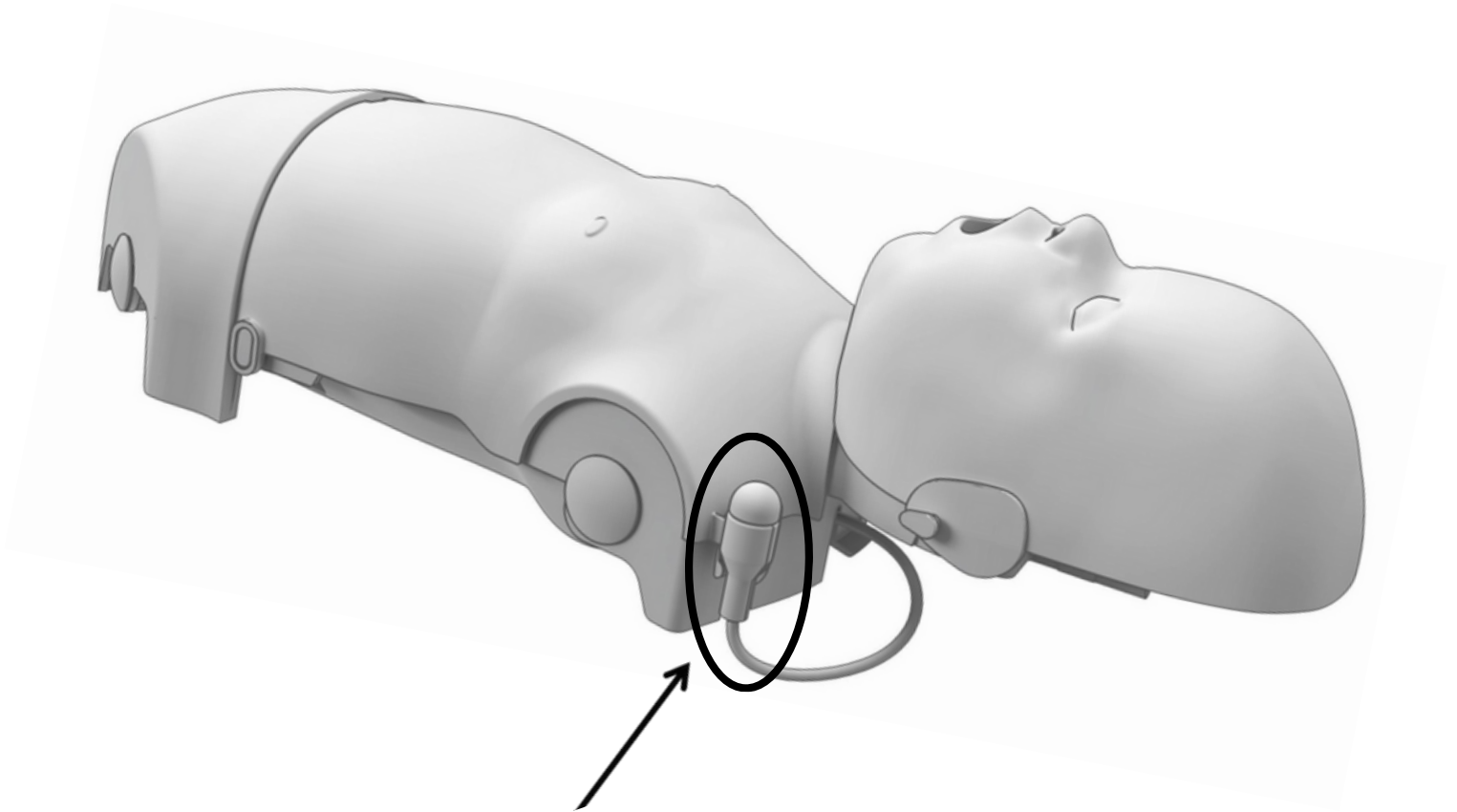

Building Confidence with PRESTAN CPR Feedback

- Solid RED LED < 100 CPM
- Solid GREEN LED = 100-120 CPM
- Flashing RED LED > 120 CPM

(CPM: Compressions per minute)

PRESTAN[®] Infant Ultralite[®] Manikin with CPR Feedback

THANK YOU for purchasing the PRESTAN Infant Ultralite Manikin with CPR Feedback.

CARE AND CLEANING:

- Ultralite Manikins may be cleaned in a variety of ways. A non-abrasive cleaner is recommended.
 - They can be wiped down with a Clorox[®] or Lysol[®] disinfecting wipe.
 - Cleaned with a mixture of soap and water
 - Sprayed or wiped with common household cleaners such as Formula 409[®], Windex[®] or Vim[®].
- The face may also be sanitized with alcohol, Clorox[®] or Lysol[®] wipes. Between student uses (and prior to applying the face shield), the instructor (or student) may clean the faces with a sanitizing wipe as an extra measure of protection.
- Students may be provided with an individual face shield (sold separately) which may be placed over the Face-Shield/Lung-Bag. This allows multiple students to use one Face-Shield/Lung-Bag during a session.

Order through your PRESTAN Authorized Distributor:

Infant Manikins Face Shields, 50-pack #PP-IFS-50
Infant Manikins Face-Shield/Lung-Bags, 50-pack #PP-ILB-50

STORAGE:

- Store the PRESTAN Manikin(s) in the nylon carry bag(s); in a cool, dry area at temperatures between 50° - 70° F (10° - 21° C) and 50% relative humidity.
- Do not stack the manikins unless they are inside the original shipping box or other protective container.
- The nylon carry bag for PRESTAN Manikin(s) is not meant to store or transport belongings (e.g. books) in addition to the manikin(s) - please use the carry bag only for the intended manikin(s) to prevent damage to the bag.
- For storage longer than 1 month, it is recommended that the batteries be removed

TROUBLESHOOTING:

- If you cannot get the chest to rise when you blow into the face shield lung bag:
 - Check to make sure that the head is tilted back to create an open airway.
 - Check the face-shield/lung-bag to ensure that it is properly positioned over the compression plate, is not twisted, and is lying flat.
 - Check the face shield lung bag to ensure that it is attached to the ear pins on the side of the manikin head and that it is flat against the face of the manikin.
 - Check the face shield lung bag to ensure that it has not been torn.
- If the chest does not compress and/or it seems the piston is binding:
 - Ensure proper hand placement - check horizontal hand placement and adjust to center in between the nipples.

Prestan® Professional AED Trainer PLUS



PRESTAN®

Prestan Professional AED Trainer PLUS



Model PP-AEDT2-101 —> **Prestan Professional AED Trainer PLUS** (requires four (4) 'C' batteries; not included) preprogrammed with English and a secondary language, one set of adult/child training pads with hard storage case, two (2) sets of pad connector pins (one (1) set is a spare) and a carry bag.



Model PP-AEDT2-401 —> **Prestan Professional AED Trainer PLUS 4-Pack** (requires sixteen (16) 'C' batteries; not included) - Four (4) AED units preprogrammed with English and a secondary language, four (4) sets of adult/ child training pads with hard storage cases, eight (8) sets of pad connector pins (four (4) sets are spares) and a 4-pack carry bag.



START HERE - GENERAL INFORMATION

- Use this instruction sheet as a reference for the Prestan Professional AED Trainer PLUS and Accessories. Please read through instructions before first use.
- Warning: The Prestan Professional AED Trainer PLUS is intended for training purposes only. It is NOT an Automated External Defibrillator (AED) and will not deliver a shock. To avoid confusion, it should NEVER be kept in the same area with AEDs.
- Owner's information – For future reference, make note of the Prestan Authorized Distributor where you purchased your AED Trainer. Contact your Distributor for product questions, reordering parts/accessories, and/or warranty issues.

Purchase Information:

Distributor Name and Phone Number

Purchase Date

Prestan Professional AED Trainer PLUS



FEATURES OF THE PRESTAN PROFESSIONAL AED TRAINER PLUS

- Adult / Child selection buttons
- Brightly illuminated shock button
 - Flashes when shock is advised
- On / Off button with lighted indicator and program pause option
- Sturdy, flip-up lid
 - Durable translucent lid & hinge
 - opening lid does not turn unit on
- Five training scenarios
- Clear & calm voice prompts
- Chest compression rate metronome
 - Metronome can be turned on or off
 - Metronome audible count reminders at ten (10), twenty (20) and thirty (30) compressions
- Automatic OR Semi-Automatic shock delivery
- Programming option to either include or not include time for breaths after compression cycle
- Remote Control Available (sold separately)
 - Controls multiple units
- Long Battery Life
 - Low battery voice prompt warning
 - Automatic shut-off for extended battery life
- Programming is compliant with current AHA Guidelines (2015)
 - Easy to replace language module if guidelines change

HIGH-PERFORMANCE TRAINING PADS

Start by installing your training pads onto the unit's pre-installed cables. See page 6 for full instructions.

- Patented **Pad Sensing System** automatically advances the scenario programming when it detects the pads have been connected to any manikin
- Pads last approximately 100 uses (depending on care and use conditions)
- Long-life adhesive leaves no messy residue and adheres well to any CPR manikin
- Pads cable is pre-connected to the AED Trainer
- Dual graphics allow for adult and child training and shows anatomical placement
- Unique pad connector with locking connector pin
- Pads are stored in a convenient hard case for adhesive and sensor protection



Prestan Professional AED Trainer PLUS



AED TRAINER PLUS FEATURE GUIDE

FRONT OF UNIT

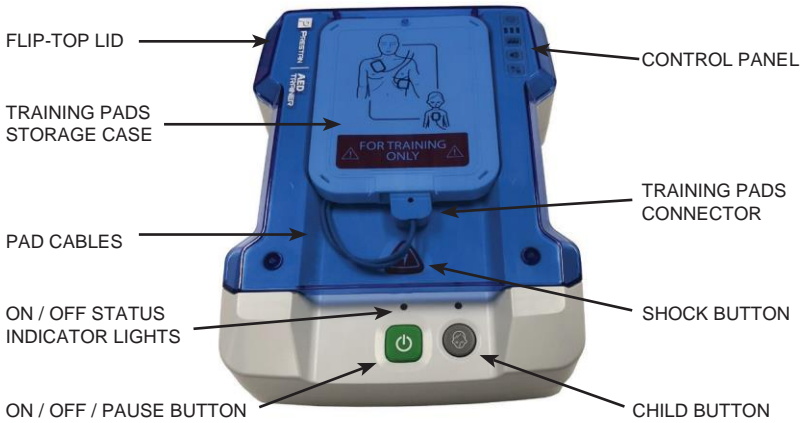

BACK OF UNIT

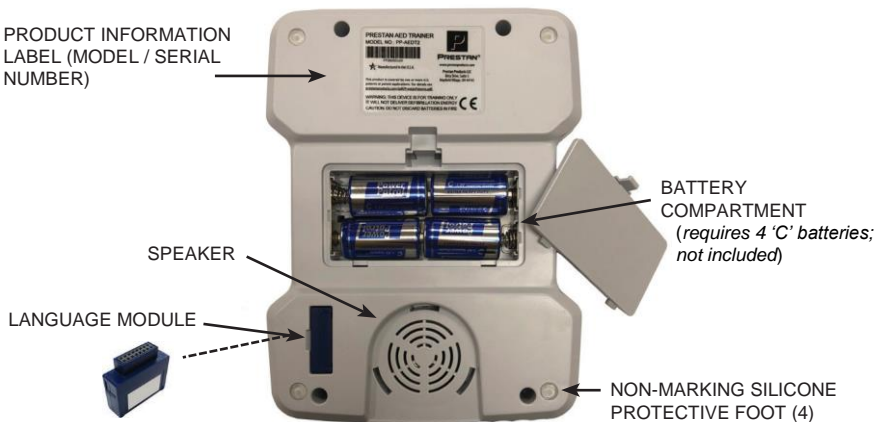

ACTION BUTTONS

ON / OFF BUTTON

- Push green button to start program / the indicator light above the button will turn on
- When unit is running, push and hold the button for three (3) seconds to shut off unit



On/Off Button

CHILD BUTTON

- After power is turned on, the programming offers an audible option to select the Child Button
- Indicator light above the Child Button will light up when the Child option has been selected and is active
- Indicator light turns off if the program is paused, but turns back on when the program is resumed



Child Button

SHOCK BUTTON

- Red Shock Button will flash when program instructs to deliver shock
- In Semi-Automatic mode, pushing the Shock Button while it is flashing will simulate delivering a shock and will stop the flashing and resume the program
- In Automatic mode, the Shock Button will flash approximately six (6) times before simulating auto-shock and resuming the program



Shock Button

Prestan Professional AED Trainer PLUS



ASSEMBLY, SETUP AND USE

1. Set aside the training pads (at top of box) and remove the cardboard tray from the shipping container
2. Remove the PRESTAN PROFESSIONAL AED TRAINER PLUS from the box
3. Unzip the PRESTAN PROFESSIONAL AED TRAINER PLUS carrying case and remove the plastic package containing the module and connector pins
4. Remove the PRESTAN PROFESSIONAL AED TRAINER PLUS from the carrying case
5. Insert the LANGUAGE MODULE into the back of the unit on the lower left-hand corner
6. Pad Assembly
 - a. Open the plastic package and remove the Prestan Professional Training Pads
 - b. Find the ends of the AED Trainer cables that are not connected to the unit
 - c. Insert each pad into a cable connector (pad tab may need to be wiggled into place if fit is snug) and line up the hole in the tab of the pad with the hole in the connector. Ensure pads are not installed upside down (see step e. below)
 - d. Lock pads in place by pushing connector pins into holes, making sure the pin rests in the indentation in the cable connector

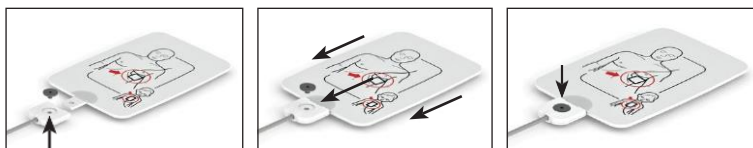
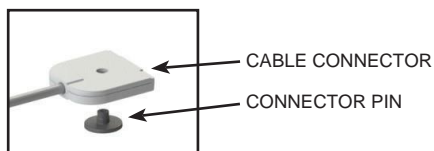

- e. Ensure pads are not installed upside down (pad graphics should be on same side as the large head of the connector pin)

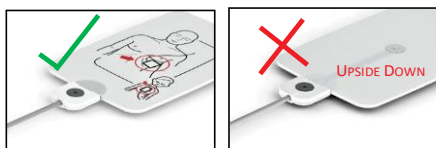

- continued on next page -

Prestan Professional AED Trainer PLUS



Assembly, Setup and Use - continued

- f. Open the white plastic pad carrying case found in the unit
- g. Turn pad over and remove the clear plastic liner from the AED Pad by gently pushing down on the tab end of the pad, causing the liner to separate
- h. **THROW THE CLEAR PLASTIC LINER AWAY** (re-using the liner does not extend the life of the adhesive and may impact pad sensing ability)



- i. Adhere the pads to the **INSIDE** lids of the white plastic Pad Case, close the case

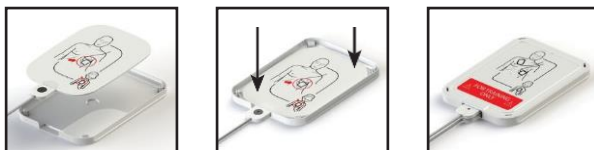

- j. Coil the Cables, place them in the well and cover them with the Pad Case



TRAINING PAD REPLACEMENT

1. Prestan training pads will generally last approximately 100 uses (depending on use and care conditions)
2. When needed, it is good practice to replace both pads at the same time
3. Release the existing pads from the gray cable connectors by popping out the black pad connector pins from the small side with the tip of a ball point pen

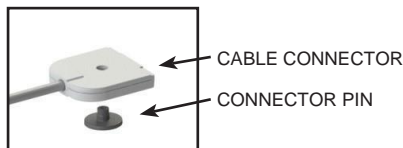
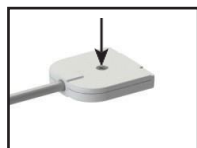

4. Slide the used pads out from the cable connectors
5. Refer to Step #6 (Pad Assembly) on previous page to complete the installation

Prestan Professional AED Trainer PLUS



CONTROL PANEL

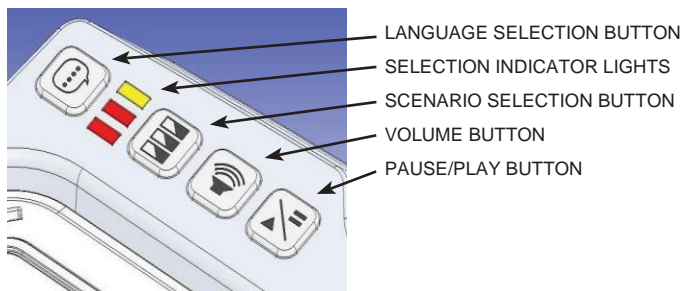

The following information is a guide for customizing your AED Trainer. The unit may be customized while ON or OFF. The unit will beep to confirm and shut down (if ON) to reset when a language or scenario selection has been changed.



LANGUAGE SELECTION BUTTON

The LANGUAGE SELECTION BUTTON, located at the top of all the buttons on the Professional AED Trainer PLUS Unit, will toggle between the languages available.

- Press the button to toggle between the languages
- The last language selected will remain the default until the language button is pressed again to select another language



SELECTION INDICATOR LIGHTS

The SELECTION INDICATOR LIGHTS are below the Language Selection button. The SELECTION INDICATOR LIGHTS are used during the setup of the unit. They indicate settings such as automatic or semi-automatic shock mode, ventilations modes, and metronome.

- Indicator lights are read left to right









- continued on next page -

Control Panel - continued





SCENARIO SELECTION BUTTON

The SCENARIO SELECTION BUTTON is located under the Indicator Lights.

- The SCENARIO SELECTION BUTTON is used to select one of the five (5) scenarios available on the unit:
 -  A red indicator means 'shock'
 -  A yellow indicator means 'no shock'
-  The factory default is for three (3) cycles, all of which are for 'shock'
- Continuously pressing the SCENARIO SELECTION BUTTON will cycle through the five (5) available scenarios:
 - Scenario 1  shock; no shock; no shock
 - Scenario 2  shock; no shock; shock
 - Scenario 3  shock; shock; no shock
 - Scenario 4  no shock; no shock; no shock
 - Scenario 5  shock; shock; shock



VOLUME BUTTON

- There are three (3) volume levels on the unit
- By pressing the VOLUME BUTTON, you can increase or decrease the volume of the unit depending on need
- The indicator lights will light up to indicate
 -  Low Volume
 -  Medium Volume
 -  High Volume



PAUSE/PLAY BUTTON

- When the PAUSE/PLAY BUTTON is pushed, the unit will pause the scenario
- When in pause mode, three (3) yellow selection indicator lights  will blink
- Press the PAUSE/PLAY BUTTON again to resume the scenario

Prestan Professional AED Trainer PLUS





PROGRAMMING OPTIONS

Use combinations of buttons as directed below to program preferred settings for the unit.



AUTOMATIC / SEMI-AUTOMATIC

The Prestan Professional AED Trainer PLUS can be set to automatically deliver a simulated shock without depressing the Shock button.

- The Prestan Professional AED Trainer PLUS is preset from the factory in Semi-Automatic Mode – the simulated shock is delivered manually by pressing the Shock Button when instructed and button is flashing
- To change this mode:
 - With the AED Trainer off, hold down the On/Off Button until two (2) beeps are heard (about 7-10 seconds) then release
 - » the first beep is for test mode so wait for the second beep
 - » the Shock Button will be flashing on and off
 - Look at the Selection Indicator Lights:
 - » Three (3) yellow lights –  – mode will be Semi-Automatic
 - » Three (3) red lights –  – mode will be Automatic
 - To change the mode, push the Shock Button
- To exit and save, press the On/Off Button

VENTILATIONS ON / OFF

The Prestan Professional AED Trainer PLUS can allow time for administering breaths between compression rounds. This option can be toggled on or off.

- The AED Trainer is preset from the factory with ventilations ON
- To change this mode:
 - With the AED Trainer off, hold down the On/Off Button until two (2) beeps are heard (about 7-10 seconds) then release
 - » the first beep is for test mode so wait for the second beep
 - » the Shock Button will be flashing on and off
 - Look at the Selection Indicator Lights - there will be three (3) lit up in red or yellow depending on your Automatic/Semi-Automatic preference
 - Press the Scenario Selection Button  below the lights until only the first two (2) lights are lit
 - » Two (2) yellow lights –  – the ventilations setting mode will be ON
 - » Two (2) red lights –  – the ventilations setting mode will be OFF
 - To change the mode, push the Shock Button
- To exit and save, press the On/Off Button

- continued on next page -



Prestan Professional AED Trainer PLUS



Programming Options - continued

METRONOME ON / OFF

When doing compressions, the Prestan Professional AED Trainer PLUS will count by tens (10s) as a guide to the rate of 100 compressions per minute. Programming also offers an audible metronome tick (for each compression). This option can be toggled on or off.

- The AED Trainer is preset from the factory with metronome ON
- To change this mode:
 - With the AED Trainer off, hold down the On/Off Button until two (2) beeps are heard (about 7-10 seconds) then release
 - » the first beep is for test mode so wait for the second beep
 - » the Shock Button will be flashing on and off
 - Look at the Selection Indicator Lights - there will be three (3) lit up in red or yellow depending on your Automatic/Semi-Automatic preference
 - Press the Scenario Selection Button  below the lights twice until only the first lights are lit
 - » One (1) yellow light –  – the metronome setting mode will be ON
 - » One (1) red light –  – the metronome setting mode will be OFF
 - To change the mode, push the Shock Button
- To exit and save, press the On/Off Button

FEATURE SETTINGS

	Ventilations On	Ventilations Off
CPR Metronome On	<ol style="list-style-type: none"> 1. Program begins with analyzing patient and advising shock or no shock based on user scenario setting. 2. Audible prompt "BEGIN CPR" starts compression cycle. 3. Metronome beats and audible prompt notes "TEN", "TWENTY", and "THIRTY" compression counts. 4. After thirty (30) compression tones, the metronome pauses for an audible prompt to "GIVE 2 BREATHS". 5. Compression tones and breaths continue for five (5) cycles (two (2) minutes). 6. Unit analyzes patient. 7. Cycles repeat indefinitely following scenario shock pattern until unit is manually shut off. 	<ol style="list-style-type: none"> 1. Program begins with analyzing patient and advising shock or no shock based on user scenario setting. 2. Audible prompt "BEGIN CPR" starts compression cycle. 3. Compression tones with audible prompt to "CONTINUE CPR" every twenty-four (24) seconds (x4). 4. Compression tones continue for two (2) minutes. 5. Unit analyzes patient. 6. Cycles repeat indefinitely following scenario shock pattern until unit is manually shut off.
CPR Metronome Off	<ol style="list-style-type: none"> 1. Program begins with analyzing patient and advising shock or no shock based on user scenario setting. 2. Audible prompt "BEGIN CPR" starts compression cycle. 3. Audible prompt notes "TEN", "TWENTY", and "THIRTY" compression counts. 4. After time for thirty (30) compressions, the metronome pauses for an audible prompt to "GIVE 2 BREATHS". 5. Compression tones and breaths continue for five (5) cycles (two (2) minutes). 6. Unit analyzes patient. 7. Cycles repeat indefinitely following scenario shock pattern until unit is manually shut off. 	<ol style="list-style-type: none"> 1. Program begins with analyzing patient and advising shock or no shock based on user scenario setting. 2. Audible prompt "BEGIN CPR" starts compression cycle. 3. Silence except for audible prompt to "CONTINUE CPR" every twenty-four (24) seconds (x4). 4. Cycle stops at two (2) minutes. 5. Unit analyzes patient. 6. Cycles repeat indefinitely following scenario shock pattern until unit is manually shut off.

CARE AND CLEANING INSTRUCTIONS

1. Store the Prestan Professional AED Trainer PLUS in its case and in a cool, dry area.
2. Always return the training pads to the inside lids of the plastic storage case. This protects the adhesive and sensor. It also allows the sensor to reset the programming for next use.
3. If the unit will be stored for longer than a month, remove batteries to protect against corrosion.
4. Never pick up or carry the unit by the cables.
5. The Prestan Professional AED Trainer PLUS should be kept clean. If it becomes soiled, simply wipe with a clean, slightly damp, soft cloth. If the Trainer is extremely dirty, common cleaners can be used cautiously. **DO NOT USE ABRASIVE MATERIALS OR CLEANING PRODUCTS ON THE UNIT. DO NOT SUBMERGE THE UNIT IN WATER.**

WARRANTY

Three (3) Year Limited Warranty

Prestan provides a three (3) year limited warranty for its core product line. Warranty does not cover consumable items.

TROUBLESHOOTING / TEST MODE

Is the unit programming not progressing past "place pads on patient"? Enter TEST MODE to determine if your pads or cables need to be replaced. Make sure the training pads are stored in the pad storage case before starting the test.

1. With the AED Trainer off, hold down the On/Off Button until one (1) beep is heard (about 4-6 seconds) then release
 - if you reach two (2) beeps, that is programming mode - turn unit OFF and start again
 - the Shock Button will be flashing on and off
2. Remove a training pad from the case and lightly squeeze the sensor (round disk in center of adhesive)
3. If a beep is heard - that pad and cable is in good working condition
4. Repeat Steps 2 and 3 above with the other training pad
5. If a beep is not heard - replace the pad with a known working pad (see Training Pad Replacement section on page 7) and try again
 - If a beep is now heard - the original pad needed replacing
 - If a beep is still not heard - new cables are needed
6. Press On/Off Button to quit Test Mode

Prestan Professional AED Trainer PLUS



TROUBLESHOOTING GUIDE

SYMPTOM	POSSIBLE ISSUES OR COMMENTS	SOLUTIONS
Unit does not turn on	<ul style="list-style-type: none"> Unit must be manually turned ON Batteries are not properly installed Batteries are missing, batteries are dead or battery contacts may be corroded Language Module is not installed 	<ul style="list-style-type: none"> Push green power button Re-orient batteries properly Replace batteries and check condition of battery contacts Insert language module into backside of unit
Both pads attached to manikin but device will not advance to analysis Note: Entering TEST MODE may provide the answer (see previous page for instructions)	<ul style="list-style-type: none"> Operational solution Pad is inserted backwards in the cable connector Pad or adhesive worn out or adhesive is dirty 	<ul style="list-style-type: none"> Insure pads are pressed on firmly so that the sensor in the center of the adhesive is flatly touching a surface (press down on pad center) Push out black connector pin, flip pad around and re-secure with black connector pin (see Training Pad Replacement instructions on Page 7) Replace pad (pads last approximately 100 uses with proper care)
Device proceeds to analyzing before both pads have been placed on the manikin	<ul style="list-style-type: none"> Pads not properly positioned in pad case prior to starting program 	<ul style="list-style-type: none"> Re-position pads in case to lay completely flat and sensor is positioned in recessed area of pad case
Device delivers shock before shock button is pressed	<ul style="list-style-type: none"> Device is In Automatic mode 	<ul style="list-style-type: none"> Change back to Semi-Automatic Mode (see instructions on Page 10)
Device prompts "Replace Batteries"	<ul style="list-style-type: none"> Device will run ten (10) or more hours with low batteries 	<ul style="list-style-type: none"> Replace batteries within ten (10) hours
Device suddenly shuts down or voice prompts are distorted	<ul style="list-style-type: none"> Batteries are very low, almost dead 	<ul style="list-style-type: none"> Install new batteries
Pad pulls out from pad connector	<ul style="list-style-type: none"> Black pad connector pin may be missing 	<ul style="list-style-type: none"> Install new black connector pin
Pad will not stick to the manikin	<ul style="list-style-type: none"> Adhesive is worn out or may have become dirty 	<ul style="list-style-type: none"> Replace pads (pads last approximately 100 uses with proper care)

Contact your Prestan Authorized Distributor for Warranty Assistance

Prestan Professional AED Trainer PLUS



PARTS & ACCESSORIES

Contact your Prestan Authorized Distributor for Pricing and Ordering



PP-AEDT2-100-R
Remote Control for the Professional AED Trainer PLUS
Optional Remote (*requires two (2) 'AA' batteries; not included*). Allows control of multiple units at a time. Features "pads on/off" and "push harder" prompts.



11401
Single Carry Bag for the Professional AED Trainer PLUS



11402
4-Pack Carry Bag for the Professional AED Trainer PLUS



PP-APAD2-1
Single set of Adult/Child Training Pads for the Professional AED Trainer PLUS



PP-APAD2-4
Four (4) sets of Adult/Child Training Pads for the Professional AED Trainer PLUS



RPP-AEDT2-CABLE
Set of Replacement Cables for the Professional AED Trainer PLUS



PP-ACASE2-1
Replacement Pad Storage Case for the Professional AED Trainer PLUS



PP-AEDT2-101-M English/Spanish
PP-AEDT2-102-M English/French
Language Module for the Professional AED Trainer PLUS.
Additional languages available based on distributor-represented geographic area.

PRESTAN AED Trainer

Frequently Asked Questions



The AED Trainer scenario doesn't advance past "put pads on the manikin".

The program stopping before analyzation means there is an issue with either the pads or the cables. PRESTAN training pads have a unique and patented sensing system. Be sure that the sensor, the round disk in the center of the training pad's adhesive side, is firmly adhered to a surface. For additional troubleshooting, please reference the PRESTAN AED Trainers Troubleshooting Guide in the PRESTAN Resource Center.

How long will my AED Trainer pads last?

The adhesive on the back of PRESTAN Pads will last approximately 100 applications with proper care. Remove and discard the plastic protective film from new pads and adhere the pads to the insides of the Pad Case (Professional) / Pad Card (UltraTrainer) to keep the adhesive clean between uses.

What do I do when my AED Trainer pads no longer stick to the manikin?

AED Trainer Pads are a consumable item and are not covered under warranty. Replacement pads may be purchased from your PRESTAN Authorized Distributor.

Will the AED Trainer pads work on a manikin that isn't manufactured by PRESTAN?

Yes, the special adhesive works best on PRESTAN manikin skin, but it has been tested with other manikins and will work fine with most.

Will the PRESTAN Remote for the AED Trainer work with more than one AED Trainer?

The PRESTAN AED Trainer Remote will control all the AED Trainers within its signal range. The range extends from the remote in a "V" pattern, widening with distance. The depth of the range will vary, extending 10-20 feet away from the remote (a hard-surfaced floor will bounce the signal and may allow the depth of the range to extend 20 feet while a carpeted floor will absorb the signal, keeping the depth of the range closer to 10 feet).

What is the difference between the PRESTAN Professional AED Trainer PLUS and the PRESTAN AED UltraTrainer?

Both trainers have similar features. The Professional PLUS is an upgraded product (the original Professional AED Trainer is no longer available) and offers a larger and more realistic size and weight in comparison to a live AED. The Professional PLUS is also compatible with a remote control (included with KIT or may be purchased separately). The UltraTrainer is a more compact unit that can be operated from its soft case.

PRESTAN AED Trainer

Frequently Asked Questions



Are the AED Trainer pads interchangeable between the PRESTAN Professional AED Trainer PLUS and the PRESTAN AED UltraTrainer?

Yes. Either pad will work with either trainer. However, you may notice a difference in how they fit into the pad storage areas. PRESTAN is now offering only one Training Pad for the AED Trainers. It may go by different part numbers, but it is the same pad. It fits both the Professional AED Trainer PLUS and the PRESTAN AED UltraTrainer, as well as the original Professional AED Trainer.

What happened to the pediatric training pads?

All of PRESTAN's training pads have incorporated a dual-graphic illustration. This eliminates the need to switch pads mid-session when teaching both adult and child CPR. The Pediatric Training Pads and Case have been discontinued.