

BT4830 These tables are designed for use as prep tables. with a manually 3" adjustable height over shelf. The top shelf has space at the back of the table when not in use. Travels easily on 3" swivel casters, two with breaks.

Materials: 304 stainless steel
Gauge: 18GA Top, Shelf, Over Shelf, square tube legs, 11GA Overshelf Tube,
Casters: 3" swivel wide casters, two with brakes.
Welding: All welding by heliarc method and exposed welds are ground smooth Finish Exposed surfaces are free from pit marks, weld seams, scale and are polished with #4 polish to a satin finish.

Revisions			
Rev	Description	Date	Approval
PA	BI Baseline	01/30/20	PJM

1" SS Square Tube 11GA

(2) T-Handle Lock Quick Release Pin

Over Shelf Rear Position

1 1/2" SS Square Leg Tube

(4) 3" Wide Caster (2) with Lock



PO#: _____ DATE: _____
 APPROVAL: _____ TITLE: _____

PROPRIETARY AND CONFIDENTIAL
 THE INFORMATION CONTAINED IN THIS DRAWING IS THE SOLE PROPERTY OF BLICKMAN HEALTH INDUSTRIES. ANY REPRODUCTION IN PART OR AS A WHOLE WITHOUT THE WRITTEN PERMISSION OF BLICKMAN HEALTH INDUSTRIES IS PROHIBITED.

UNLESS OTHERWISE SPECIFIED:
DIMENSIONS ARE IN INCHES
TOLERANCES:
 3 PLACE .000 = ± .062
 2 PLACE .00 = ± .125
 1 PLACE .0 = ± .250
 ANGULAR ± .5°

NAME	DATE
M.J.	01/30/2020
PJM	01/30/2020
MATERIAL	
Stainless Steel	
304	
FINISH	
Pol# 4	
APPRX WEIGHT = 145 lbs	

BLICKMAN INDUSTRIES, LLC CLIFTON, N.J.		
TITLE: Back Table 48Wx30Dx34H, BT4830		
SIZE B	PART NO. 0364830340	REV PA
DO NOT SCALE DRAWING	SCALE: 1:12	SHEET 1 OF 1

8 7 6 5 4 3 2 1

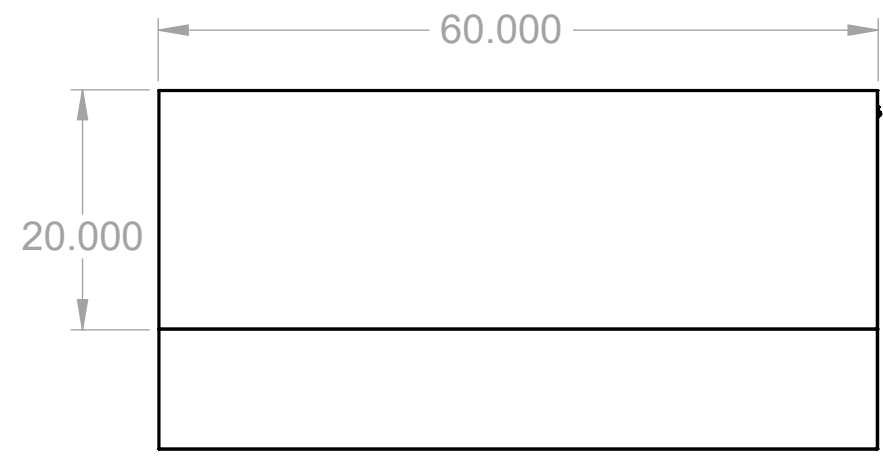

BT6030 These tables are designed for use as prep tables. with a manually 3" adjustable height over shelf. The top shelf has space at the back of the table when not in use. Travels easily on 3" swivel casters, two with breaks.

Materials: 304 stainless steel
Gauge: 18GA Top, Shelf, Over Shelf, square tube legs, 11GA Overshelf Tube,
Casters: 3" swivel wide casters, two with brakes.
Welding: All welding by heliarc method and exposed welds are ground smooth Finish Exposed surfaces are free from pit marks, weld seams, scale and are polished with #4 polish to a satin finish.

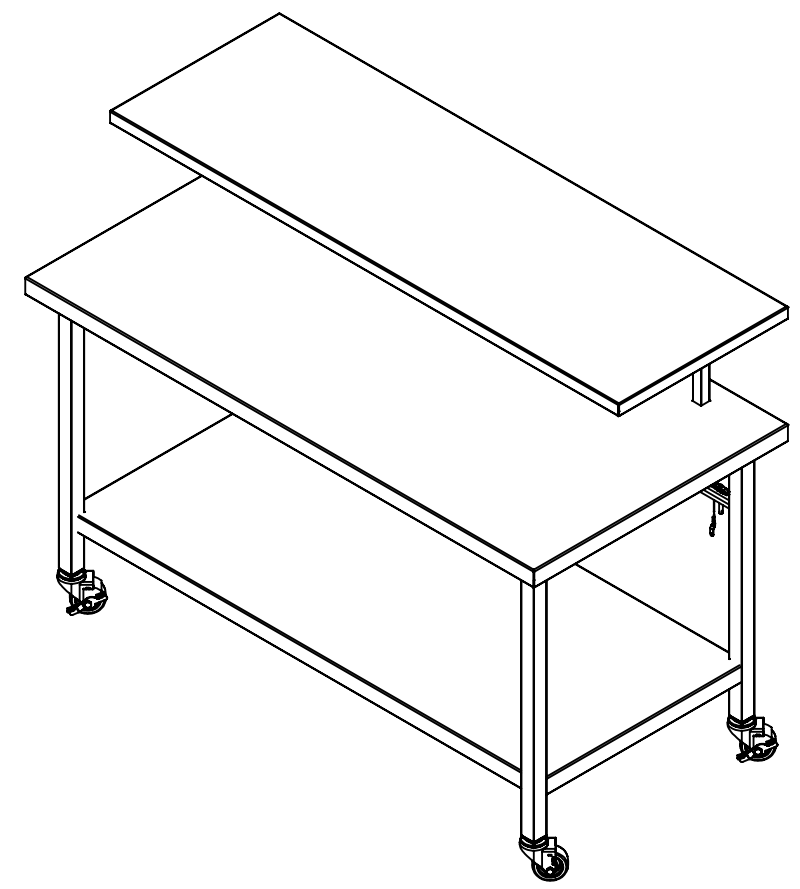
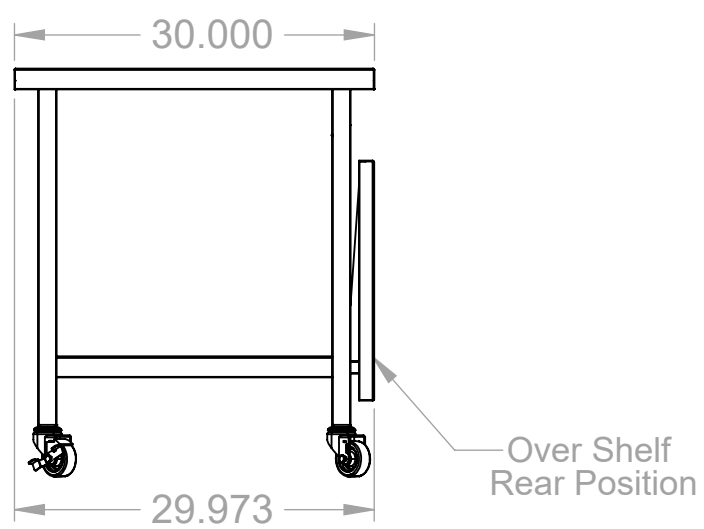
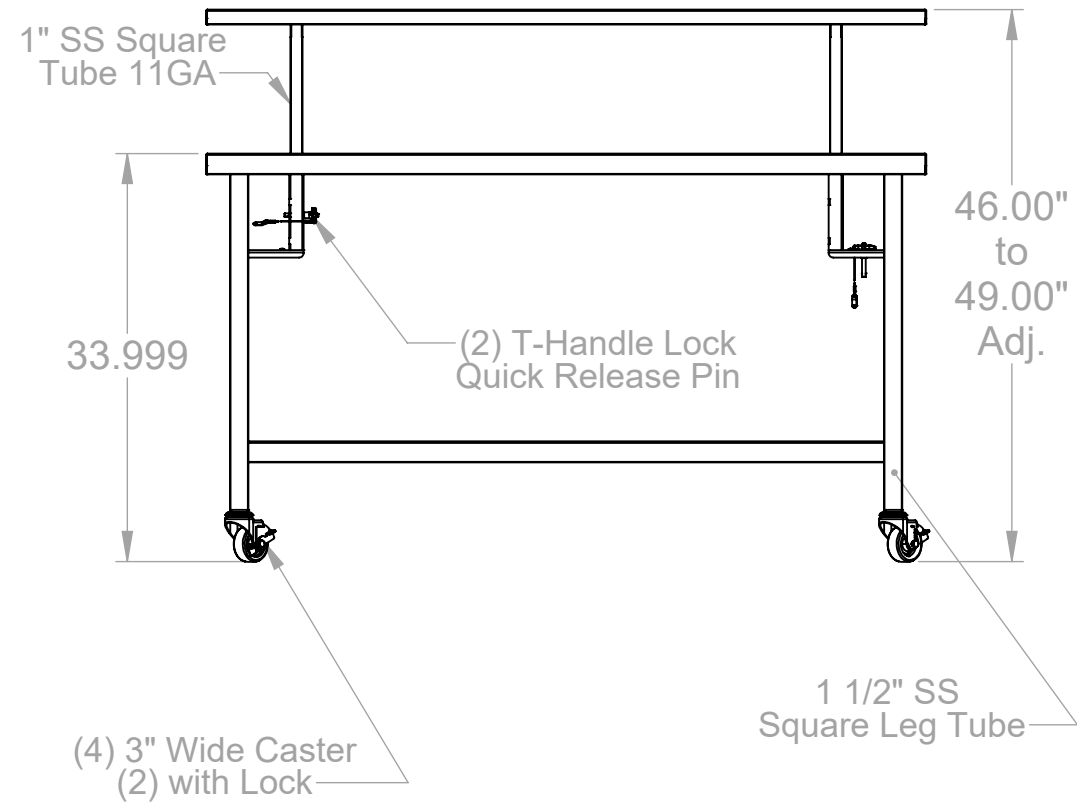

D
C
B
A

D
C
B
A



PO#: _____ DATE: _____
 APPROVAL: _____ TITLE: _____

PROPRIETARY AND CONFIDENTIAL
 THE INFORMATION CONTAINED IN THIS DRAWING IS THE SOLE PROPERTY OF BLICKMAN HEALTH INDUSTRIES. ANY REPRODUCTION IN PART OR AS A WHOLE WITHOUT THE WRITTEN PERMISSION OF BLICKMAN HEALTH INDUSTRIES IS PROHIBITED.

UNLESS OTHERWISE SPECIFIED:
DIMENSIONS ARE IN INCHES
TOLERANCES:
 3 PLACE .000 = ± .062
 2 PLACE .00 = ± .125
 1 PLACE .0 = ± .250
 ANGULAR ± .5°

	NAME	DATE	BLICKMAN INDUSTRIES, LLC LYNDHURST, N.J.		
DRAWN	M.J	01/08/2021			
ENG APPR.	PJM	01/08/2021	TITLE: Back Table 60Wx30Dx34H, BT6030		
MATERIAL Stainless Steel 304			SIZE	PART NO.	REV
FINISH Pol# 4			B	0366030340	PA
APPRX WEIGHT = 165 lbs			SCALE: 1:16		SHEET 1 OF 1
DO NOT SCALE DRAWING					

8 7 6 5 4 3 2 1

8 7 6 5 4 3 2 1

Revisions			
Rev	Description	Date	Approval
PA	BI Baseline	01/13/21	PJM

BT7230 These tables are designed for use as prep tables. with a manually 3" adjustable height over shelf. The top shelf has space at the back of the table when not in use. Travels easily on 3" swivel casters, two with breaks.

Materials: 304 stainless steel
Gauge: 18GA Top, Shelf, Over Shelf, square tube legs, 11GA Overshelf Tube,
Casters: 3" swivel wide casters, two with brakes.
Welding: All welding by heliarc method and exposed welds are ground smooth Finish Exposed surfaces are free from pit marks, weld seams, scale and are polished with #4 polish to a satin finish.

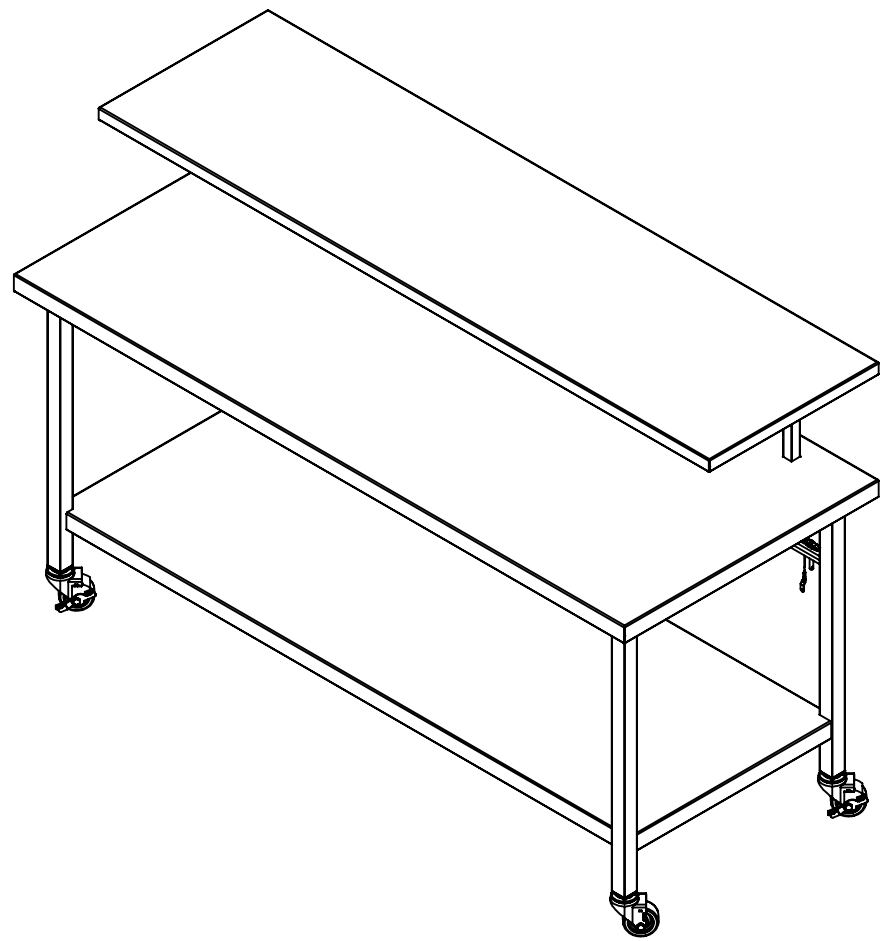
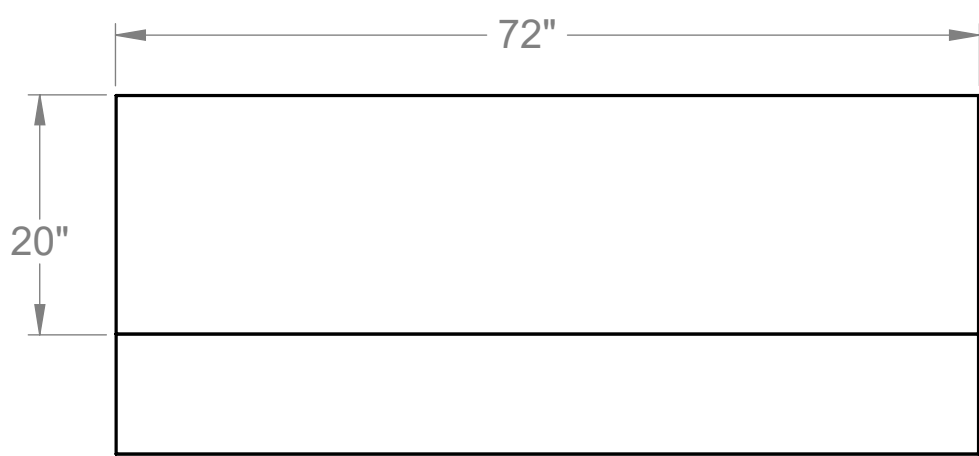

D
C
B
A

D
C
B
A

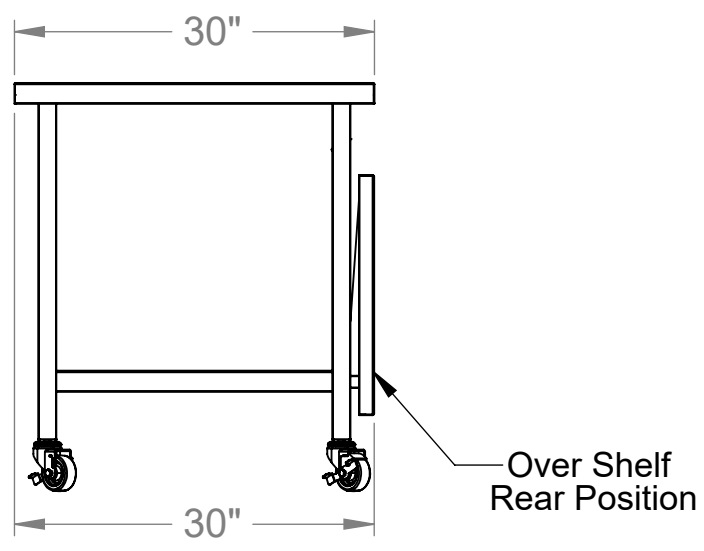
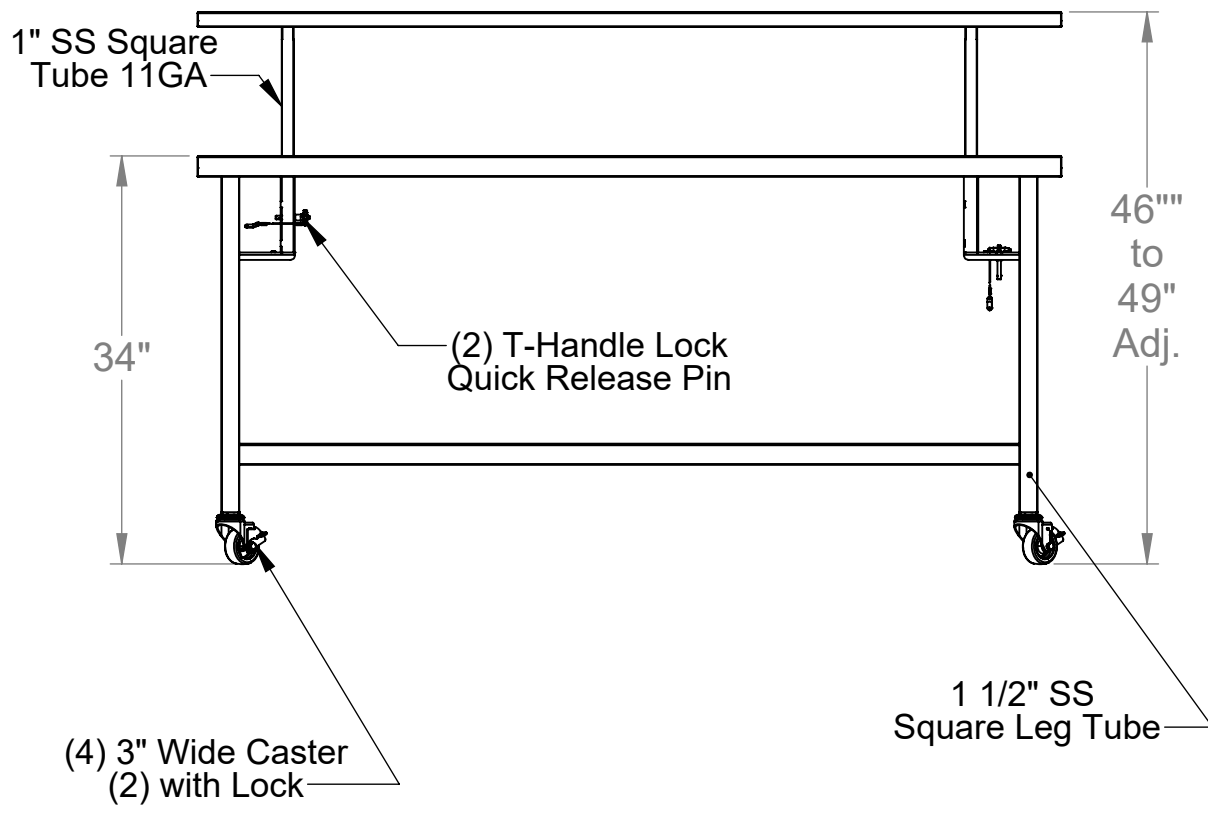

PO#: _____ DATE: _____

APPROVAL: _____ TITLE: _____

PROPRIETARY AND CONFIDENTIAL
 THE INFORMATION CONTAINED IN THIS DRAWING IS THE SOLE PROPERTY OF BLICKMAN HEALTH INDUSTRIES. ANY REPRODUCTION IN PART OR AS A WHOLE WITHOUT THE WRITTEN PERMISSION OF BLICKMAN HEALTH INDUSTRIES IS PROHIBITED.

UNLESS OTHERWISE SPECIFIED:
DIMENSIONS ARE IN INCHES
TOLERANCES:
 3 PLACE .000 = ± .062
 2 PLACE .00 = ± .125
 1 PLACE .0 = ± .250
 ANGULAR ± .5°

NAME	DATE
M.J	01/13/2021
PJM	01/13/2021
MATERIAL Stainless Steel 304	
FINISH Pol# 4	
APPRX WEIGHT = 185 lbs	

BLICKMAN INDUSTRIES, LLC LYNDHURST, N.J.		
TITLE: Back Table 72Wx30Dx34H, BT7230		
SIZE B	PART NO. 0367230340	REV PA
DO NOT SCALE DRAWING	SCALE: 1:16	SHEET 1 OF 1

8 7 6 5 4 3 2 1