



# 1 Block Dry Block Heaters



## *Versatile Block Heaters Designed for Everyday use with Accessories for Every Application*

Versatile Dry Block Heaters are ideal for applications that require temperature stability. Close tube-to-block contact enables maximum heat retention, resulting in efficient heating. Digital models offer exceptional temperature uniformity and stability for repeatable results, while non-digital models are an economical choice. All units hold optional interchangeable modular blocks with over 40 choices. Blocks are easy to use, no tools required.

### *Standard Features:*

- **Delivering Exceptional Temperature Stability and Uniformity**  
Designed for every day use in the lab. Digital and non-digital Block Heaters offer exceptional temperature uniformity with outstanding temperature stability.
- **Calibrate to an External Temperature Device with Temperature Calibration Mode**  
Digital models with user calibration feature allows you to match the Block Heater's display to your known external temperature standard which improves the temperature accuracy of the system.
- **Accurate and Fast Sample Heating with PID Microprocessor Temperature Control**  
Digital models feature easy to use touchpad controls with independent displays for temperature and time. Robust non-Digital models are controlled with dual temperature adjustment knobs.

# 1 Block Dry Block Heaters

Model	HB1AL	HB1DG
Control	Non-Digital	Digital
Temperature Range	High 75 °C – 150 °C, Low Ambient + 5 °C – 100 °C	Ambient + 5 °C – 120 °C
Stability @ 37 °C	+/-1°C (120V), +/- 1.5°C (230V)	+/-0.1°C (120V), +/-0.2°C (230V)
Uniformity within the block @ 37°C	+/-0.1°C (120V), +/-0.4°C (230V)	+/-0.1°C (120V), +/-0.2°C (230V)
Heat Up Time to 100 °C	≤16 min	
Temperature Calibration	NA	.
Number of Blocks	1	
Overshoot Protection	NA	10 °C above set point
Working Environment	64 °F – 91 °F, 20% – 80% relative humidity, non-condensing / 18 °C – 33 °C, 20% – 80% relative humidity, non-condensing	
Power	120V, 0.92A, 50/60Hz / 230V, 0.5A, 50/60Hz	
Power Consumption	110 W	
Dimensions (W × L × H)	8 × 12.4 × 3.5 in. / 203 × 315 × 89 mm	
Net Weight	5.5 lb / 2.5 kg	

## Other Standard Features and Equipment

Touchpad control and audible alarm (digital models), painted steel housing, digital models include support rod holder with locking knob, detachable 3-wire cord and plug (included)

## Compliance

- **Product Safety:** CAN/CSA C22.2 61010-1, CAN/CSA C22.2 61010-2-010, CAN/CSA C22.2 61010-2-051, UL 61010-1
- **Electromagnetic Compatibility:** ICES-003 Class A, FCC Part 15 Class A
- **Compliance Marks:** TÜV SÜD

## Accessories

Module Block 10 mm Test Tube, 24 Wells ..... 30400151	Sand Bath, 1 Block Unit..... 30400173
Module Block 12/13 mm, 20 Wells ..... 30400152	Sand, 0.5 kg (1 lb) Bag ..... 30400177
Module Block 15/16 mm, 12 Wells ..... 30400153	Stainless Steel Shot, 0.5 kg (1 lb)..... 30400178
Module Block 20 mm Test Tube, 8 Wells..... 30400154	Module Block For Vials 12 mm, 20 Wells ..... 30400182
Module Block 25 mm Test Tube, 6 Wells..... 30400155	Module Block For Vials 15 mm, 20 Wells ..... 30400183
Module Block - Test Tube Combination Block:	Module Block For Vials 17 mm, 12 Wells ..... 30400184
6 mm, 12/13 mm, 25 mm ..... 30400156	Module Block For Vials 19 mm, 12 Wells ..... 30400185
Module Block 0.5 mL Microtaper, 30 Wells ..... 30400157	Module Block For Vials 21 mm, 9 Wells..... 30400186
Module Block 6 mm Test Tube, 30 Wells..... 30400158	Module Block For Vials 23 mm, 8 Wells..... 30400187
Module Block 1.5 mL Microtaper, 20 Wells ..... 30400159	Module Block For Vials 25 mm, 8 Wells..... 30400188
Module Block Solid..... 30400160	Module Block For Vials 28 mm, 6 Wells..... 30400189
Module Block Cuvette - 12 Cuvet, 2 Wells ..... 30400161	Module Block For Vials 16 mm, 15 Wells ..... 30400190
Module Block 11.5/1.5 mL Microcentrifuge, 20 Wells	Module Block, 2.0 mL Tube, 20 Wells..... 30400191
..... 30400162	Module Block, 2.0 mL Corning Tube, 20 Wells..... 30400192
Module Block 250 Microliter/6 mm, 30 Wells..... 30400163	Module Block Combo - Centrifuge Tube Configuration:
Module Block 12/13 mm, 16 Wells ..... 30400165	50 mL-2 Wells, 15 mL-3 Wells, 1.5 mL-4 Wells..... 30400193
Module Block 35 mm Test Tube, 4 Wells..... 30400167	Module Block Combo - Micro Tube Combination:
Module Block 50 mL Conical Centrifuge, 5 Wells... 30400168	2 mL-5 Wells, 1.5 mL-10 Wells, 0.5 mL-6 Wells ..... 30400194
Module Block 0.2 mL Micro, 80 Wells ..... 30400169	Module Block 17/18 mm, 12 Wells ..... 30400195
Module Block 0.2 mL Micro, 64 Wells ..... 30400170	Stainless Steel Probe Kit* ..... 30400246
Module Block 15 mL Conical Centrifuge, 12 Wells... 30400172	*NA for HB1AL

## Dimensions

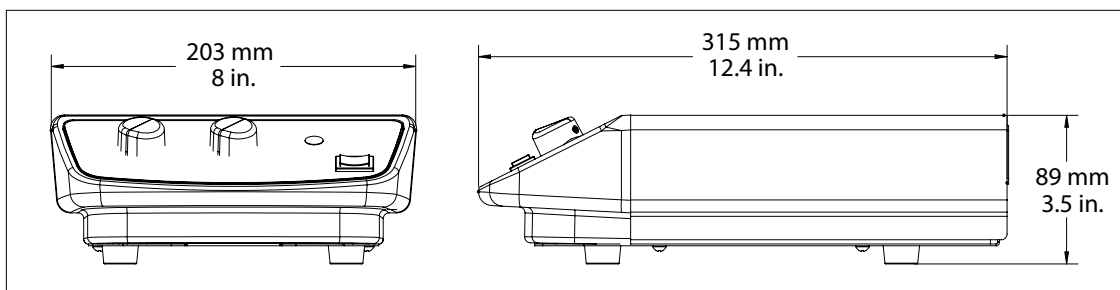

OHAUS CORPORATION

The management system governing the manufacture of this product is ISO 9001:2015 certified.

