

Prestan[®]

AED UltraTrainer™



PRESTAN[®]

Prestan AED UltraTrainer™



Model PP-AEDUT-101 —> **Prestan AED UltraTrainer** (requires three (3) 'C' batteries; not included) preprogrammed with English/Spanish language, one set of adult/child training pads (pre-installed), one set of extra connector pins and a nylon carrying case.



Model PP-AEDUT-401 —> **Prestan AED UltraTrainer 4-Pack** (requires twelve (12) 'C' batteries; not included) preprogrammed with English/Spanish language, four sets of adult/child training pads, four sets of extra connector pins, 4 single nylon cases and a 4-pack nylon carrying case.



START HERE

- Use this instruction sheet as a reference for the Prestan AED UltraTrainer and Accessories.
- **Warning:** The Prestan AED UltraTrainer is intended for training purposes only. It is **NOT** an Automated External Defibrillator (AED) and will not deliver a shock. To avoid confusion, it should **NEVER** be kept in the same area with AEDs.
- Owner's information – For future reference, make note on your Quick Start Card of the Prestan Authorized Distributor where you purchased your AED Trainer and keep it with your unit. Contact your Prestan Authorized Distributor for product questions, reordering parts/accessories, or warranty issues.

Features of the Prestan AED UltraTrainer

- High Performance Training Pads
 - ⇒ Clear Anatomical Placement Graphics
 - ⇒ Long-Life Adhesive
 - ⇒ Adheres well to all Manikins with no messy residue left behind
 - ⇒ Unique Pad Connector with locking Connector Pin
- Pad Sensing System
 - ⇒ Pads are pre-connected
 - ⇒ Pads on-manikin detection
 - ⇒ Remote Control NOT Required
 - ⇒ Plugging in connector NOT Required
 - ⇒ Works on any Manikin
- Protective & Reusable Pad Tray
- Adult / Child Selection Button
- Bright Illuminated Shock Button
 - ⇒ Flashes when shock is advised
- On/Off Button with Lighted Indicator and Program Pause Option
- Five Training Scenarios
- Clear & Calm Voice Prompts
- Chest Compression Rate Metronome
 - ⇒ Metronome can be turned on or off
 - ⇒ Metronome audible count reminders at 10, 20 and 30 compressions
- Automatic OR Semi-Automatic Shock-Delivery
- Programming Option to either include or not include time for breaths after compression cycle
- Long Battery Life
 - ⇒ Low Battery Voice Prompt Warning
 - ⇒ Automatic Shut Off Extends Battery Life
- Water & Splash Resistant
- Programming is compliant with current AHA Guidelines (2015)

ADULT/CHILD TRAINING PADS

- Pad cords are pre-connected to the AED Trainer
- Pad Sensing System automatically lets the unit know when the pads have been connected to a manikin
- Pads last for 100+ uses
- Unique pad replacement (see assembly section)
- Pads are stored on a convenient double-sided Pad Tray





PRESTAN[®]

PRESTAN AED UltraTrainer™

The **Prestan AED UltraTrainer™** provides the options instructors have been waiting for. Combining the most recent technology with realistic features not found on other AED Trainers, this product will excel in any training atmosphere. It is a compact and customizable unit providing quality, durability and affordability. The **Prestan AED UltraTrainer™** is sure to be an industry favorite.

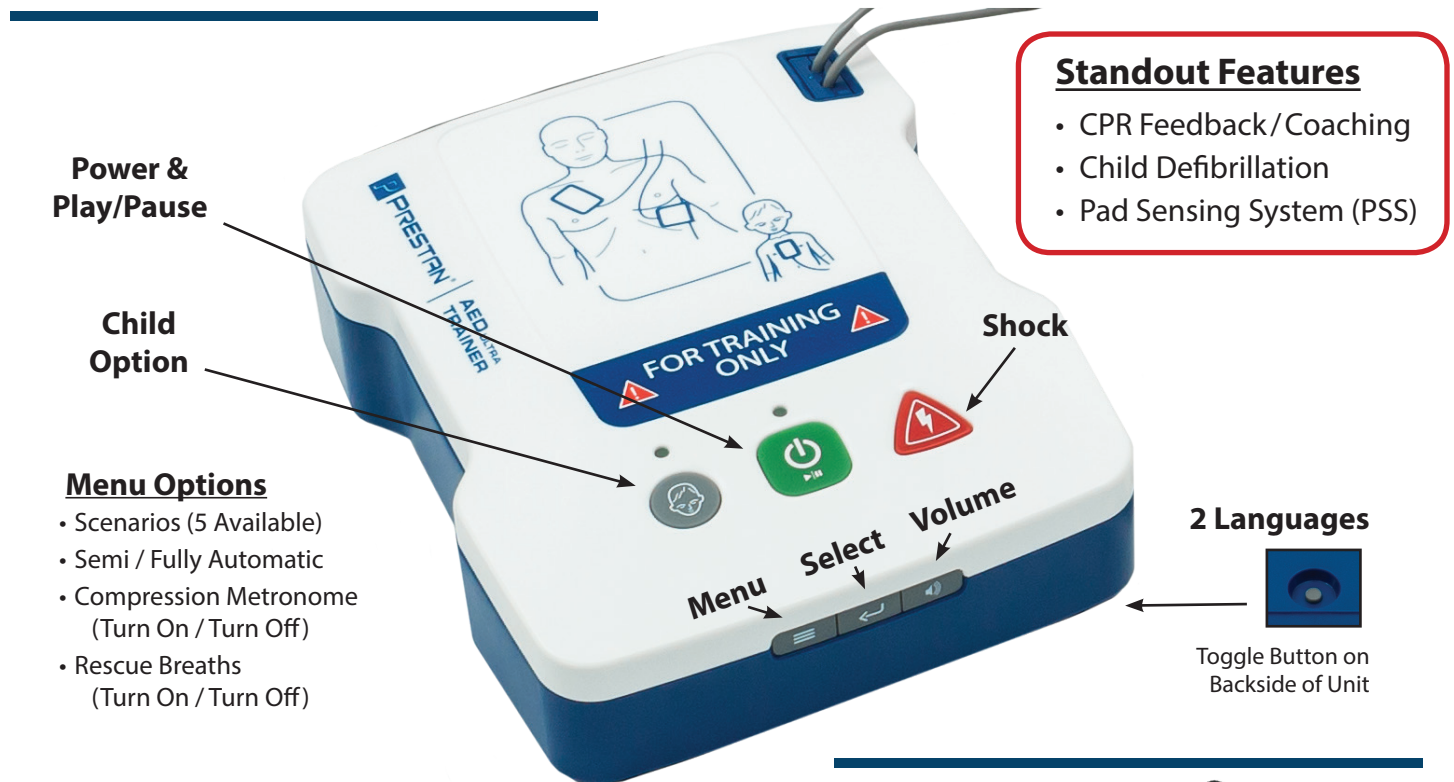

Amazing Training Pads

- Pads are pre-connected and ready to use, unlike other AED trainers that use outdated plug-in technology
- Pads can be used 100 times (or more!) during CPR/AED classes
- One set of dual-graphics pads work for both adult and child training
- Pads have an embedded 'switch' which senses proper pad attachment to the manikin (Pad Sensing System) (patent pending)
- The silicone base adhesive on the pads, coupled with the foam structure, ensures easy application & removal

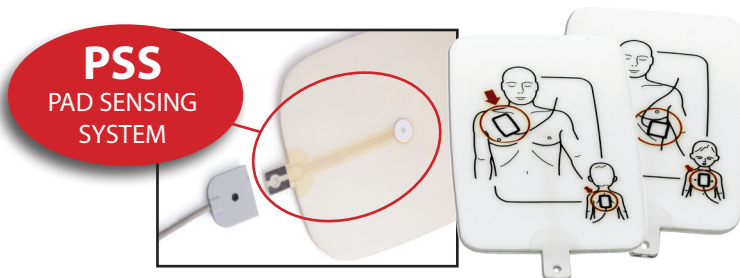

Units include one set of Adult/Child Pads, pre-installed batteries, instructions, extra connector buttons and a carrying case

Product Part Numbers

- | | |
|---------------------|-------------------------------------------|
| ITEM # PP-AEDUT-101 | Single AED UltraTrainer - English/Spanish |
| ITEM # PP-AEDUT-401 | Four AED UltraTrainers - English/Spanish |
| ITEM # PP-AEDUT-102 | Single AED UltraTrainer - English/French |
| ITEM # PP-AEDUT-402 | Four AED UltraTrainers - English/French |

FEATURE GUIDE

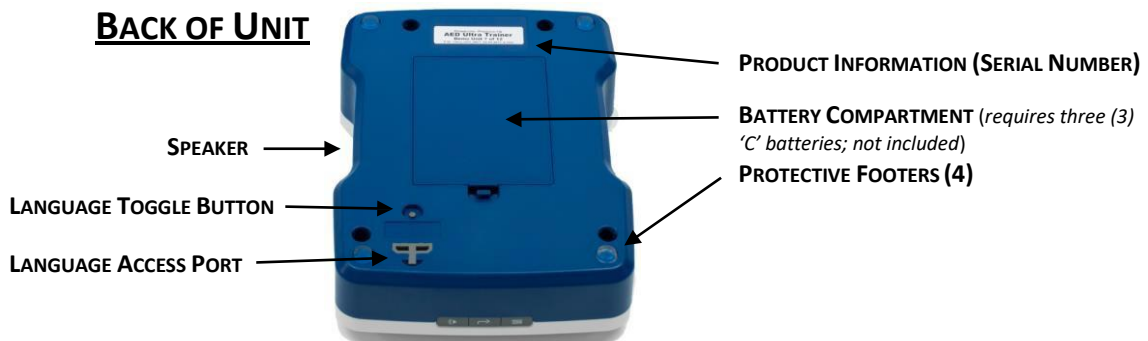

ACTION BUTTONS

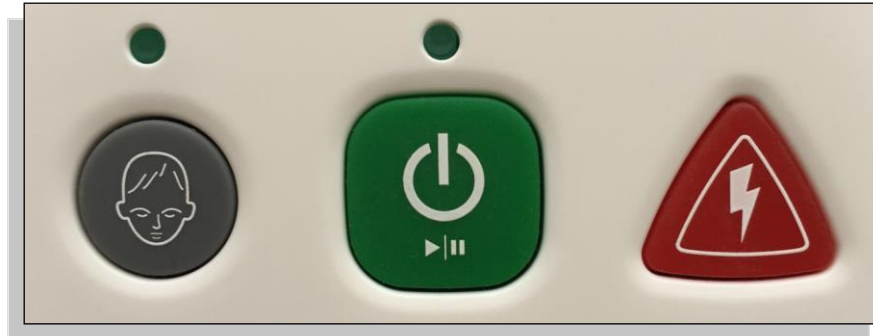

Child Button

On/Off/Pause Button

Shock Button

CHILD BUTTON

- After power is turned on, the programming offers an audible option to select the Child Button
- Indicator light above the Child Button will light up when the Child option has been selected and is active
- Indicator light turns off if the program is paused, but turns back on when the program is resumed

ON / OFF / PAUSE BUTTON

1. Push green button to start program / the indicator light above the button will turn on
2. Push green button again to pause program / indicator light will blink / push green button again to resume program
3. When unit is running, push and hold the button for 3 seconds to shut off unit

SHOCK BUTTON

- Red Shock Button will flash when program instructs to deliver shock
- In Semi-Automatic mode, pushing the Shock Button while it is flashing will stop the flashing and resume the program
- In Automatic mode, the Shock Button will flash approximately 6 times before auto-shocking and resuming the program.

OPTION BUTTONS



MENU BUTTON

The Menu Button allows customization of 4 options and can be used at any time. Push the Menu Button repeatedly to scroll through and hear each selection currently active for each of the options (see 1-4 below). Use the Selection Button to scroll through and change these options.

SELECTION BUTTON

Use with the Menu Button to change settings for each of the 4 Menu options. Repeatedly press Selection Button to hear current selection and scroll to the next. After you hear the option desired, simply stop pressing the button and that selection will remain active. A beep will be heard to confirm selection is set.

1. Available Training Scenarios:
 - a. Scenario 1 > Shock / Shock / Shock (default)
 - b. Scenario 2 > Shock / No Shock / No Shock
 - c. Scenario 3 > No Shock / No Shock / No Shock
 - d. Scenario 4 > Shock / No Shock / Shock
 - e. Scenario 5 > Shock / Shock / No Shock
2. Semi-Automatic / Automatic toggle
 - a. Semi-Automatic > Student must push flashing Shock Button to deliver shock (default)
 - b. Automatic > Unit will deliver shock when Shock Button is lit
3. Ventilations toggle
 - a. Ventilations On > Time is provided in scenarios to give breaths (default)
 - b. Ventilations Off > No time is provided in scenarios to give breaths
4. Metronome toggle
 - a. Metronome On > Audible ticks are heard for compression rhythm (default)
 - b. Metronome Off > No ticks are heard during compression section of program

See chart on Page 7 for Ventilations / Metronome interaction.

VOLUME BUTTON

- Toggle the Volume Button between 3 volume levels
- Works independently of Menu and Selections Buttons

FEATURE SETTINGS

| | Ventilations On | Ventilations Off |
|----------------------------------|-----------------------------------------------------------------------------------------------------------------------------------------------------------------------------------------------------------------------------------------------------------------------------------------------------------------------------------------------------------------------------------------------------------------------------------------------------------------------------------------------------------------------------------------------------------------------------------------------------------------------------------------------------------------|-------------------------------------------------------------------------------------------------------------------------------------------------------------------------------------------------------------------------------------------------------------------------------------------------------------------------------------------------------------------------------------------------------------------------------------------------------------------------------------------------------------------------|
| CPR Metronome On | <ol style="list-style-type: none"> 1. Program begins with analyzing patient and advising shock or no shock based on user scenario setting. 2. Audible prompt “BEGIN CPR” starts compression cycle. 3. Metronome beats and audible prompt notes “TEN”, TWENTY, and THIRTY compression counts. 4. After 30 compression beats, the metronome pauses for an audible prompt to “GIVE 2 BREATHS”. 5. Compressions beats and breaths continue for 5 cycles (2 minutes). 6. Unit analyzes patient. 7. Cycles repeat indefinitely following scenario shock pattern until unit is manually shut off. | <ol style="list-style-type: none"> 1. Program begins with analyzing patient and advising shock or no shock based on user scenario setting. 2. Audible prompt “BEGIN CPR” starts compression cycle. 3. Compression beats with audible prompt to “CONTINUE CPR” every 24 seconds (x4). 4. Compression beats continue for 2 minutes. 5. Unit analyzes patient. 6. Cycles repeat indefinitely following scenario shock pattern until unit is manually shut off. |
| CPR Metronome Off | <ol style="list-style-type: none"> 1. Program begins with analyzing patient and advising shock or no shock based on user scenario setting. 2. Audible prompt “BEGIN CPR” starts compression cycle. 3. Audible prompt notes “TEN”, TWENTY, and THIRTY compression counts. 4. After time for 30 compressions, the metronome pauses for an audible prompt to “GIVE 2 BREATHS”. 5. Compressions beats and breaths continue for 5 cycles (2 minutes). 6. Unit analyzes patient. 7. Cycles repeat indefinitely following scenario shock pattern until unit is manually shut off. | <ol style="list-style-type: none"> 1. Program begins with analyzing patient and advising shock or no shock based on user scenario setting. 2. Audible prompt “BEGIN CPR” starts compression cycle. 3. Silence except for audible prompt to “CONTINUE CPR” every 24 seconds (x4). 4. Cycle stops at 2 minutes. 5. Unit analyzes patient. 6. Cycles repeat indefinitely following scenario shock pattern until unit is manually shut off. |



PRESTAN®

AED UltraTrainer

Instructions for using the Programming Dongle



Basic steps:

1. Make sure the unit has good batteries in it, and unit is off
2. Turn unit over and remove gray rubber plug from socket as shown in the pictures at right
3. Insert programming dongle into the socket, aligning beveled corners on dongle with beveled corners in socket – push down until dongle is flush with unit
4. Turn unit back over and set on table top with dongle tab dangling over the table edge
5. Press green power button (this will turn on the unit and run the programming sequence for approximately 2 minutes / lights will flash during the programming)
6. When programming is done, unit will beep and shut off
7. Press green power to turn on unit, you should hear “Adult Patient...”
8. (If you don’t hear “Adult Patient...” program again)
9. Press green power button and hold down for 3 seconds to turn unit off
10. Remove programming dongle
11. Insert gray plug back into socket
12. Unit is ready to use



CARE AND CLEANING INSTRUCTIONS

1. Store the Prestan AED UltraTrainer in its case and in a cool, dry area.
2. Return the training pads and cables to their respective storage pouches located on the interior lid of the unit's cover. If pads and cables are stacked on top of the unit, the cables may imprint grooves/indentations into the surface of the pads.
3. If the unit is being stored for long periods, remove batteries to protect against corrosion.
4. Never pick up or carry the unit by the cables.
5. The Prestan AED UltraTrainer should be kept clean. If it becomes soiled, simply wipe with a clean, damp, soft cloth. If the Trainer is extremely dirty, common cleaners can be used cautiously with a minimum amount of abrasion to ensure the life of the unit. Do not submerge unit in water.

PAD REPLACEMENT

1. Prestan Training Pads will generally last approximately 100 uses.
2. When pad replacement is needed, it is good practice to replace both pads at the same time.
3. Release the existing pads from the gray cable connectors by popping out the black pad connector pins with the tip of a ball point pen.
4. Slide the pads out from the cable connectors.
5. Insert new pads into the cable connectors.
6. Use the pad connector pins to lock the pads in place.

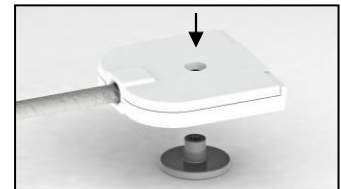

- Insert pad into cable connector (be sure the pad graphics are on same side as the large head of the connector pin and that the connector pin snugly fits into the indentation in the cable connector)

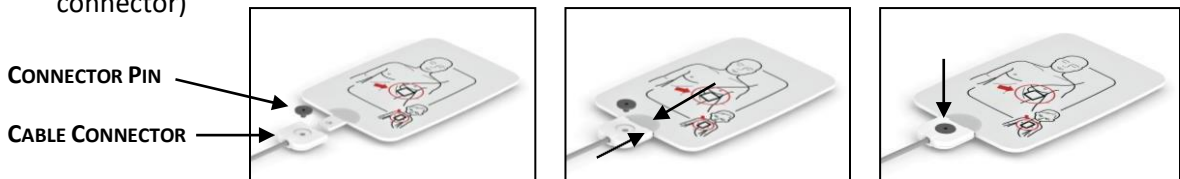

- Insure pad is not upside down
- If the pad has a protective backing over the adhesive (replacement pads), remove and dispose of this and adhere the pads to the double-sided pad case

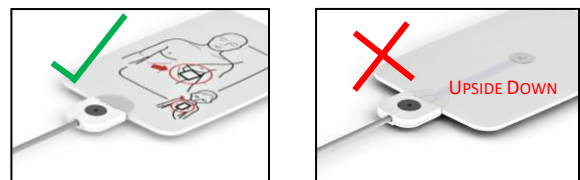

TROUBLESHOOTING GUIDE

| SYMPTOM | POSSIBLE ISSUES OR COMMENTS | SOLUTIONS |
|-------------------------------------------------------------------------------|----------------------------------------------------------------------------------------------------------------------------------------------------------------------------|---------------------------------------------------------------------------------------------------------------------------------------------------------------------------------------------------------------------------------------------------------------------------------------------------------------|
| Unit does not turn on | <ul style="list-style-type: none"> Unit must be manually turned on Batteries are not property installed Batteries are dead or are missing | <ul style="list-style-type: none"> Push green power button Re-orient batteries properly Replace batteries |
| Both pads attached to manikin but device will not advance to analysis | <ul style="list-style-type: none"> Operational solution Pad is inserted upside down in the cable connector Pad or Adhesive worn out | <ul style="list-style-type: none"> Insure pads are pressed on firmly, specifically so that the sensor in the center of the adhesive is touching a surface Push out black connector pin, flip pad around and re-secure with black connector pin Replace pad (lasts 100+ uses) |
| Device proceeds to analyzing before both pads have been placed on the manikin | <ul style="list-style-type: none"> Pads not properly positioned on tray Look for pad riding up pad tray wall | <ul style="list-style-type: none"> Re-position pad on tray to lay completely flat so it is not touching side walls |
| Device delivers shock before shock button is pressed | <ul style="list-style-type: none"> Device is In Automatic mode | <ul style="list-style-type: none"> Change back to Semi-Automatic Mode |
| Device prompts “Replace Batteries” | <ul style="list-style-type: none"> Device will run 10 or more hours with low batteries | <ul style="list-style-type: none"> Replace batteries within 10 hours |
| Device suddenly shuts down or voice prompts are distorted | <ul style="list-style-type: none"> Batteries are very low, almost dead | <ul style="list-style-type: none"> Install new batteries |
| Pad pulls out from pad connector | <ul style="list-style-type: none"> Check for black connector pin missing | <ul style="list-style-type: none"> Install new black connector pin |
| Pad will not stick to the manikin | <ul style="list-style-type: none"> Adhesive is worn out | <ul style="list-style-type: none"> Replace pads (lasts 100+ uses) |
| Grooves/indentations are appearing on the surface of the pads | <ul style="list-style-type: none"> The cables are indenting into the surface of the pads from improper storage placement | <ul style="list-style-type: none"> Store cables and pads in their respective pouches in the interior lid of the unit’s carry bag |

| Features | Benefits | Prestan AED UltraTrainer™ | Other Universal AED Trainers |
|------------------------------------------------------|------------------------------------------------------------------------------------------------------------------------------------------------------------------------------------------------|---------------------------|------------------------------|
| AED Trainer Pads | | | |
| Pad Sensing System (PSS) (patent pending) | Senses when pads are placed on manikin then advances to analyzation which best simulates live AEDs. Others must plug in the pads cord to analyze which is technology no longer used with AEDs. | ✓ | ✗ |
| Pads Cord Preconnected | Simulates most modern live AEDs. Others must plug in the pads cord to analyze - technology no longer used with AEDs. | ✓ | ✗ |
| 100+ Pad Application Life | Quality Pads last longer saving your budget. Other use low quality pads that need to be replaced more often. | ✓ | ✗ |
| CPR Coaching | | | |
| CPR Coaching, Ventilation (Give two breaths) Command | Giving breaths is part of CPR certification curriculums. Other AED trainers do not coach ventilation as required in CPR guidelines. | ✓ | ✗ |
| CPR Coaching, Compression Metronome | CPR Metronome beeps at pace recommend by CPR guidelines. Helps students keep proper compression rate. | ✓ | ✓ |
| On/Off Compression Metronome | Customize training class by turning off metronome if needed. | ✓ | ✗ |
| On/Off Ventilation Command | Customize training class by turning off ventilations if needed. Valuable when teaching Compression-Only CPR. | ✓ | ✗ |
| Child AED Training | | | |
| Child Button | Most accurately simulates modern AEDs resulting in a realistic training class. | ✓ | ✗ |
| Child Commands | Most accurately simulates modern AEDs resulting in a realistic training class. | ✓ | ✗ |
| Duel Graphic Pad | Simulates modern live AEDs using adult and child graphics on same pad. Others have separate Child pads adding expense. | ✓ | ✗ |
| Battery Life | | | |
| Long Life C Batteries | Class interruptions are minimized with long lasting C batteries which last 3x longer than AA batteries. Others use shorter life AA batteries. | ✓ | ✗ |
| Low Battery Warning | Notification helps avoid interruption of dead batteries during training class. | ✓ | ✗ |
| Shock Simulation | | | |
| Automatic or Semi-Automatic Shock Simulation | Customize AED training to the customer's AED. | ✓ | ✗ |
| Warranty | | | |
| 3-Year Warranty | Durable product backed by Prestan. Others offer 1 year or less. | ✓ | ✗ |

PARTS & ACCESSORIES

Contact your Prestan Authorized Distributor for Pricing and Ordering



11678
Single Carry Bag for the AED UltraTrainer



11806
4-Pack Carry Bag for the AED UltraTrainer

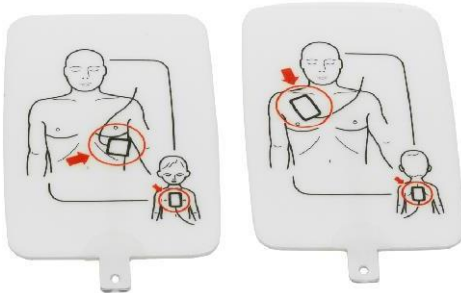

PP-UTPAD-1
Single set of Adult/Child Training Pads
for the AED UltraTrainer

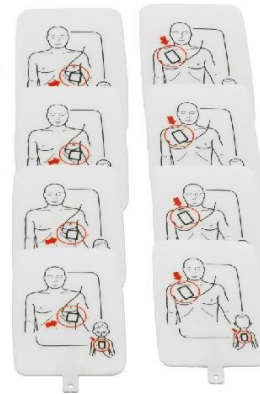

PP-UTPAD-4
Four (4) sets of Adult/Child Training Pads
for the AED UltraTrainer



RPP-AEDUT-CABLE
Replacement Cable Assembly for
the AED UltraTrainer



RPP-AEDUT-TRAY
Replacement Pad Storage Tray
for the AED UltraTrainer



PP-AEDUT-101-D English/Spanish
PP-AEDUT-102-D English/French
Language dongle for
the AED UltraTrainer

The Prestan AED UltraTrainer™

offers features not found on any other universal AED trainer.

This compact and lightweight unit gives students a realistic training experience with training pads that sense when they are placed on a manikin. In addition, the pads are preconnected and voice prompts are clear and calm.

Instructors can customize their training class with options to turn on or off the compression metronome and/or ventilation voice prompt.

With a 3-year warranty and durable long-lasting pads, the AED UltraTrainer is built to last.

Prestan is the First and Only Universal AED Trainer with:

- ✓ Dual Graphic (Adult/Child) Training Pads
- ✓ Pad Sensing System
- ✓ Preconnected Pads
- ✓ Child Training Button
- ✓ Child AED specific voice prompts
- ✓ Automatic or Semi-Automatic shock simulation
- ✓ CPR Coaching, "Give Breaths" voice prompt
- ✓ Turn on or off compression metronome
- ✓ Turn on or off "Give Breaths" prompts
- ✓ Low Battery warning
- ✓ 3 Year Warranty

Other features:

- ✓ Two languages (English, Spanish)
- ✓ 2015 Guidelines Compliant and Upgradable
- ✓ Play/Pause Button
- ✓ 5 Training Scenarios



Learn more about the Prestan AED UltraTrainer™
Scan the QR Code to watch the video

Prestan Products LLC © 2017



PRESTAN®