

■ PREMIER COLLECTION

# The Classic

Available: Power, Manual, Power XL, Manual XL



The Classic is an economical recliner which has a rock-solid steel frame and heavy-duty casters, making it ideal for a variety of applications and environments.

Regardless of size, location, and type — every medical facility needs seating solutions that meet the needs of their patients and providers.

The Classic provides patient comfort and ease of use, plus product longevity and dependability.



## Key Benefits

- This workhorse recliner is perfect for facilities of any size and budget, and it's engineered to meet the most demanding applications.
- Infinite recline positions and either stationary or swing-away arms provide optimal patient comfort and better access for caregivers.
- With fold-away tables, foot trays and quick-release seats, caregivers get more versatility and convenience from a medical recliner.
- For quality engineering and patient-centric innovation that prioritizes functionality, safety, and comfort, Champion products comply with ISO 13485 and are made in the USA.

## Common Applications:

Dialysis Settings

## Standard Features



Trendelenburg Positioning



Swing-Away Arms



Foot Tray



5" (12.7 cm) Casters



Fold-Down Side Table

(Additional standard features are also included. Talk to a Sales Rep for details.)

## Space Requirements

Front View

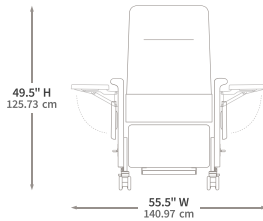

Top View

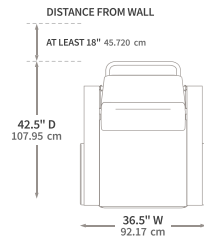

Side View

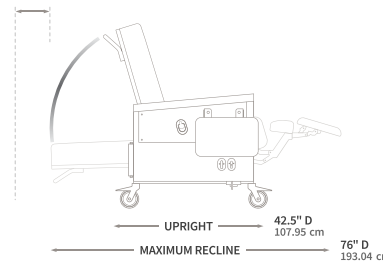

Top View with Swing Away Arms

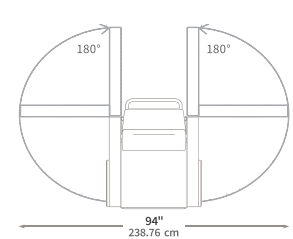

Model 85 shown with optional second fold-away table.

## Specifications

	Standard	XL
<b>Power Recline</b>	Yes, Model: 85P	Yes, Model: 86P
<b>Manual Recline</b>	Yes, Model: 858	Yes, Model: 868
<b>Weight Capacity</b>	300 lbs. / 136 kg	500 lbs. / 226 kg
<b>Back Height</b> (from floor ♦ from seat)	48.50" ♦ 28.50" 123.19 cm ♦ 72.39 cm	49.50" ♦ 29.50" 125.73 cm ♦ 74.93 cm
<b>Overall Width</b> (with 2 gray tables down ♦ up)*	32.75" ♦ 51.75" 83.19 cm ♦ 131.44 cm	36.50" ♦ 55.50" 92.17 cm ♦ 140.97 cm
<b>Maximum Width</b> (arms open at widest)	90" / 228.60 cm	94" / 238.76 cm
<b>Minimum Width</b> (arms open at 180°)	32.75" / 83.19 cm	36.50" / 92.71 cm
<b>Seat Width</b>	22.75" / 57.79 cm	26.75" / 67.95 cm
<b>Seat Height ♦ Seat Depth</b>	25.50" ♦ 19.50" 64.77 cm ♦ 49.53 cm	25.50" ♦ 19.50" 64.77 cm ♦ 49.53 cm
<b>Arm height</b> (highest point from floor)	29.75" / 75.57 cm	29.75" / 75.57 cm
<b>Overall Upright Depth</b> (with handle) ♦ <b>Trendelenburg Depth</b>	42.50" ♦ 75" 107.95 cm ♦ 190.50 cm	42.50" ♦ 76" 107.95 cm ♦ 193.04 cm
<b>Thermoplastic Casters</b> (diameter)	5" / 12.70 cm	5" / 12.70 cm

## Available Options



Heat + Massage Tabletop Switch



USB Charging Port



TV/Monitor Mount



Paper Roll Dispenser



IV Pole Options