

Instructions for Use

Schure Spine Frame 800-0235

Replacement Parts:

Schure Spine Frame Crank Handle
800-0277

Schure Spine Frame Pad Set
508-0472

Laminectomy Arm Cradles, 12 pr/cs
508-0373

Extended Richard Slotted Head Rest,
6/cs 508-1340

Schure Spine Frame Straps

Copyright Notice

All rights reserved. Any duplication, adaption or translation without prior written consent is prohibited unless otherwise provided for in relevant copyright laws.



Initial Release: 5/1/2012



Manufacturer
SchureMed (081001460)



Authorized Representative

Emergo Europe, Prinsessegracht 20, 2514 AP The Hague, The Netherlands

INSTRUCTIONS

Become familiar with features of patient positioning device before use with patient. Always practice use on a nurse, physician or appropriate volunteer prior to using clinically.

COMPONENT OVERVIEW

Schure Spine Frame is used as a platform to do simple spine surgeries. Its arches create desired lordosis needed to open inter-vertebral spaces.

Replacement Parts:

Schure Spine Frame Crank Handle 800-0277

Schure Spine Frame Pad Set 508-0472

Laminectomy Arm Cradle, 12 pr/cs 508-0373

Extended Richards Slotted Head Rest 6/cs 508-1340

Schure Spine Frame Straps 512-0049

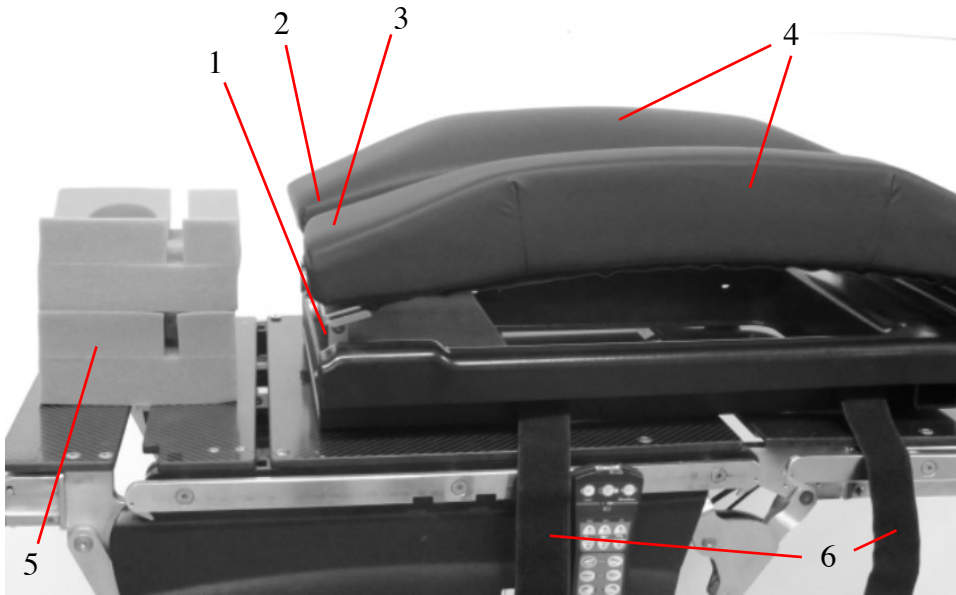

(1) Buttons, (2) Hole for Crank, (3) Head End, (4) Patient Support Pads: 508-0472
 (5) Ext. Richards Slotted Head Rest: 508-1340, (6) Schure Spine Frame Straps: 512-0049

SET UP FOR FLEX FRAME OR JACKSON TABLE

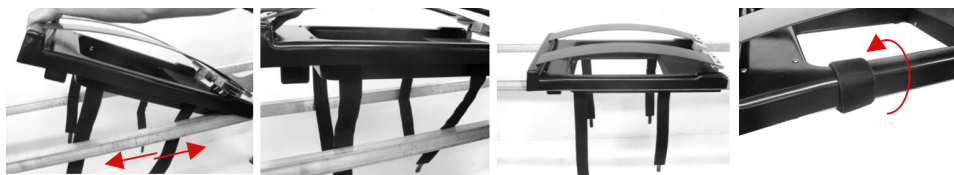

1. Lower head end of Schure Spine Frame onto rails and slide to desired location
2. Ensure loop and hook straps are in between rails
3. Lower frame completely onto rails
4. Bring loop and hook straps around rails and secure to Schure Spine Frame

SET UP FOR SURGICAL TABLE/FLAT SURFACE



1. Place frame on surgical table with buttons facing head end of surgical table
2. Ensure enough room for head positioner
3. Ensure frame is centered between surgical table rails
4. Place loop and hook straps through surgical table rails
5. Bring loop and hook straps around rails and secure back to Schure Spine Frame

DEVICE CONTROLS TO ADJUST PAD HEIGHT

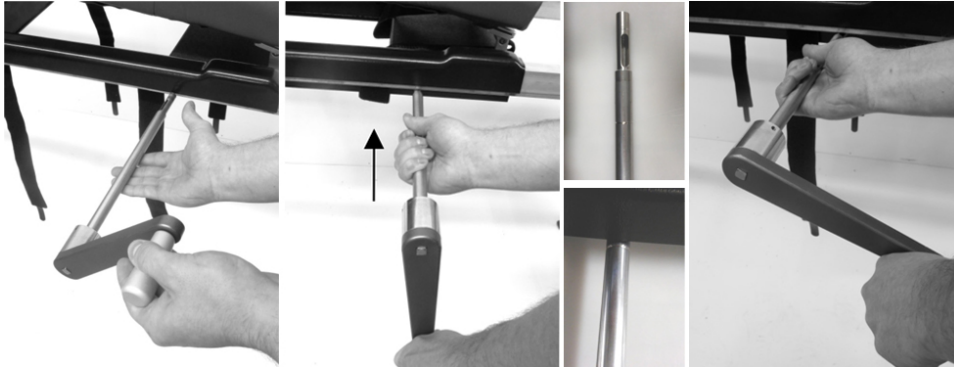

1. Insert Crank Handle (800-0277) into Schure Spine Frame as shown
2. Press Crank Handle in until fully engaged and line on shaft is lining up with opening below
3. Support Crank Handle Rod with one hand and grab handle with other

TO RELEASE PATIENT SUPPORTS

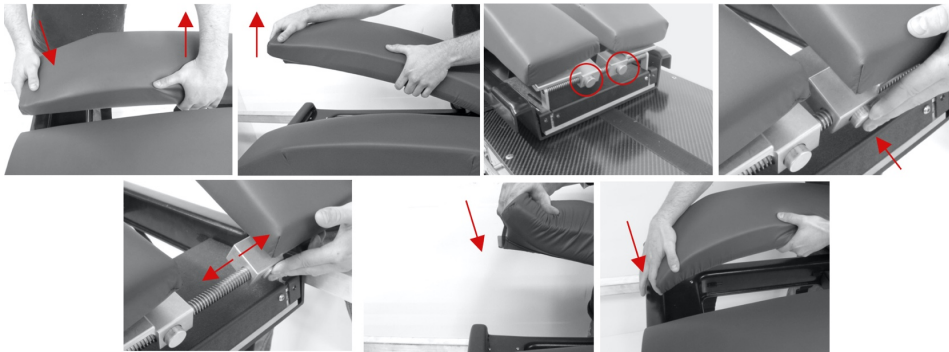

1. Press inward at free end of support while pulling upward at center
2. Pull support out from front catch
3. Locate button at opposite end of frame
4. Press button firmly
5. Shift support laterally to desired location and release button
6. Lower support to front catch
7. Press firmly inwards and tuck into front catch

Loading Patient Important Notes

- *Note: Techniques detailed in this manual are only manufacturers suggestions. Final responsibility for patient care with respect to this device remains with attending physician.*
- *Optional Recommended –Place moisture absorbing/friction reducing covers over supports*
- *Prior to transferring patient, crank spine frame to highest setting. After transferring patient, lower to desired level.*
- *Position patient to reduce nerve contact and subsequent injury*
- *Additional support must be provided to head, arms and legs*

REMOVAL AND STORAGE



1. Remove loop and hook strap from Spine frame and unwrap from rail
2. Remove from table and store

INTENDED USE

Schure Spine Frame is used as a platform to do simple spine surgeries.

GENERAL SPECIFICATIONS

Device Dimensions (maximum)

- Length: 30" +/- 0.5"
- Width: 19" +/- 0.5"
- Depth: 7.5" +/- 0.5" (Minimum no pad) & 10" +/- 0.5" (Maximum no pad)
- Device Weight: 27 +/- 0.5 lbs.
- Range of Motion: 7.5" lateral adjustment
- Attaches to rail of surgical table at any point on rail
- Single-person installation
- Removable hand crank
- Stores on Transport Dolly
- Compatible with Jackson table and any other surgical table that has side rails
- 3/4 of Spine Frame is radiolucent—just be sure to turn mechanics (where buttons and crank handle is inserted) are on opposite end of surgical procedure

GENERAL INFORMATION

- Product not made with Natural Rubber Latex
- Device supports 500 lb. proportional patient load (6'4" tall patient per 99% human body model)
- Product warranty covers product from manufacturing defects for period of 2 years

- *Product is maintenance-free, check product condition before next use*
- *Life of device is 5 years under normal use*
- *Store device between -4°F to +86°F*

DISPOSAL

- **General** - *Prevent infection by cleaning and disinfecting product before disposal*
- **Packaging** - *Dispose packaging material via household waste according to national requirements*
- *SchureMed accepts back used or retired products - or dispose of product in accordance with national requirements*



Product Use Warnings

WARNING!

Maximum load should not exceed appropriate proportion of a patient weighing 500 lbs. Use care with low-maximum load capacity surgical tables that accessory rails are not overloaded.



WARNING!

Hazard resulting from incorrect use. Strictly follow Instructions for Use with your surgical table system.

CLEANING RECOMMENDATION

Follow current Association of periOperative Registered Nurses Journal Guidelines for proper cleaning and disinfection procedure.



WARNING!

Adhere to standards for blood-borne pathogens from Occupational Safety and Health Administration. Use recommended protective clothing, gloves, masks and eye protection to clean accessory.

CAUTION

Strictly read/follow manufacturer's directions for cleaning fluids. DO NOT use cleaners containing phenolics.

1. *Remove major contaminants from accessory with disposable materials. Follow appropriate bio-hazard waste disposal procedures.*
2. *Apply cleaning fluid liberally to entire accessory and wipe with clean, lint-free cloth until all moisture and cleaning fluid is removed from accessory*
3. *Let accessory dry*



Symbol Explanation



Date of Manufacture



Conformity Mark



Manufacturer

LOT

Batch Code/Serial Number

EC REP

Authorized Representative
in European Community

IFU-800-0235 REV 3.03